

UNITED STATES  
DEPARTMENT OF THE INTERIOR  
BUREAU OF LAND MANAGEMENT

APPLICATION FOR PERMIT TO DRILL OR DEEPEN

1a. TYPE OF WORK

DRILL ☒

DEEPEN ☐

b. TYPE OF WELL

OIL ☐

GAS ☒

WELL ☐

OTHER

SINGLE ☒

MULTIPLE ☐

2. NAME OF OPERATOR

ENERGEN RESOURCES CORPORATION

3. ADDRESS AND TELEPHONE NO.

2198 Bloomfield Highway; Farmington, NM 87401

4. LOCATION OF WELL (Report location clearly and in accordance with any State requirements.)\*

At surface

1010' FSL, 1555' FWL

At proposed prod. zone

14. DISTANCE IN MILES AND DIRECTION FROM NEAREST TOWN OR POST OFFICE\*

16 miles Northwest of Lindrith, NM

15. DISTANCE FROM PROPOSED\*

LOCATION TO NEAREST

PROPERTY OR LEASE LINE, FT.

(Also to nearest drlg. unit line, if any)

1010'

16. NO. OF ACRES IN LEASE

2560

17. NO. OF ACRES ASSIGNED

TO THIS WELL

320

18. DISTANCE FROM PROPOSED LOCATION\*

TO NEAREST WELL, DRILLING, COMPLETED,

OR APPLIED FOR, ON THIS LEASE, FT.

700'

19. PROPOSED DEPTH

6319'

20. ROTARY OR CABLE TOOLS

Rotary

21. ELEVATIONS (Show whether DF, RT, GR, etc.)

7052'

22. APPROX. DATE WORK WILL START\*

23.

PROPOSED CASING AND CEMENTING PROGRAM

SIZE OF HOLE	GRADE SIZE OF CASING	WEIGHT PER FOOT	SETTING DEPTH	QUANTITY OF CEMENT
12 1/4	9 5/8	36#	200'	130 cu. ft., circ.
8 3/4	7	20 & 23#	4099'	924 cu. ft., circ.
6 1/4	4 1/2	10.5#	3949-6319'	365 cu. ft., circ. liner

NOTE: THIS IS A PIPELINE R.O.W. EXPEDITED APD.

IN ABOVE SPACE DESCRIBE PROPOSED PROGRAM: If proposal is to deepen, give data on present productive zone and proposed new productive zone. If proposal is to drill or deepen directionally, give pertinent data on subsurface locations and measured and true vertical depths. Give blowout preventer program, if any.

24.

SIGNED

TITLE Production Superintendent

DATE 11/2/99

(This space for Federal or State office use)

PERMIT NO.

APPROVAL DATE

Application approval does not warrant or certify that the applicant holds legal or equitable title to those rights in the subject lease which would entitle the applicant to conduct operations thereon.

CONDITIONS OF APPROVAL, IF ANY:

APPROVED BY

TITLE

DATE

\*See Instructions On Reverse Side

Title 18 U.S.C. Section 1001, makes it a crime for any person knowingly and willfully to make to any department or agency of the United States any false, fictitious or fraudulent statements or representations as to any matter within its jurisdiction.

District I  
PO Box 1980, Hobbs, NM 88241-1980

State of New Mexico  
Energy, Minerals & Natural Resources Department

Form C-102  
Revised February 21, 1994  
Instructions on back  
Submit to Appropriate District Office  
State Lease - 4 Copies  
Fee Lease - 3 Copies

District II  
PO Drawer CD, Artesia, NM 88211-0719

OIL CONSERVATION DIVISION  
PO Box 2088  
Santa Fe, NM 87504-2088

District III  
1000 Rio Brazos Rd., Aztec, NM 87410

District IV  
PO Box 2388, Santa Fe, NM 87504-2088

☐ AMENDED REPORT

### WELL LOCATION AND ACREAGE DEDICATION PLAT

API Number <b>30-039-26351</b>		Pool Code <b>72319</b>	Pool Name <b>Blanco Mesaverde</b>
Property Code <b>21942</b>	Property Name <b>JICARILLA 115E</b>		Well Number <b>13R</b>
OGPSID No. <b>162928</b>	Operator Name <b>ENERGEN RESOURCES CORPORATION</b>		Elevation <b>7052</b>

#### 10 Surface Location

UL or Lot No.	Section	Township	Range	Lot 10n	Feet from the	North/South line	Feet from the	East/West line	County
N	3	26N	3W		1010	SOUTH	1555	WEST	PIO ARRIBA

#### 11 Bottom Hole Location If Different From Surface

UL or Lot No.	Section	Township	Range	Lot 10n	Feet from the	North/South line	Feet from the	East/West line	County

Dedicated Acres <b>320</b>	Depth of Intest <b></b>	Consolidation Code <b></b>	Order No. <b></b>
-------------------------------	----------------------------	-------------------------------	----------------------

NO ALLOWABLE WILL BE ASSIGNED TO THIS COMPLETION UNTIL ALL INTERESTS HAVE BEEN CONSOLIDATED OR A NON-STANDARD UNIT HAS BEEN APPROVED BY THE DIVISION

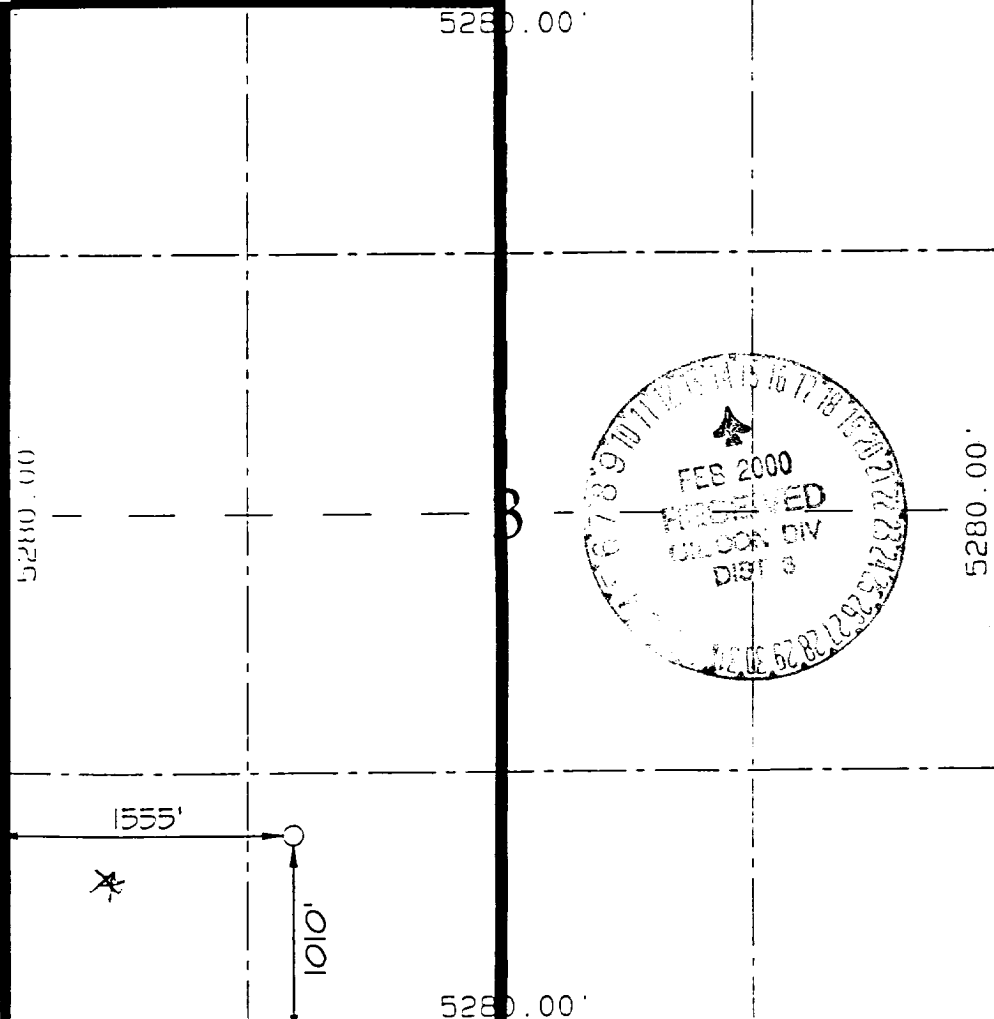
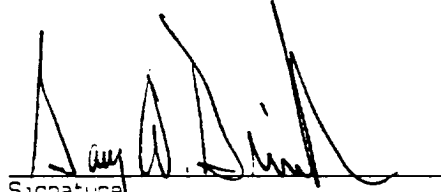
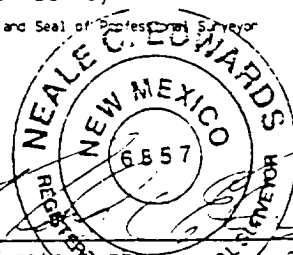
	<b>17 OPERATOR CERTIFICATION</b> I hereby certify that the information contained herein is true and complete to the best of my knowledge and belief.   Signature Gary Brink Printed Name Production Superintendent Title <b>11/2/99</b> Date
	<b>18 SURVEYOR CERTIFICATION</b> I hereby certify that the well location shown on this plat was plotted from field notes of actual surveys made by me or under my supervision and that the same is true and correct to the best of my belief.  <b>OCTOBER 4, 1999</b> Date of Survey Signature and Seal of Professional Surveyor  Certificate No. <b>6857</b>

# ENERGEN RESOURCES CORPORATION

## Mesa Verde / Dakota Well BOP Configuration

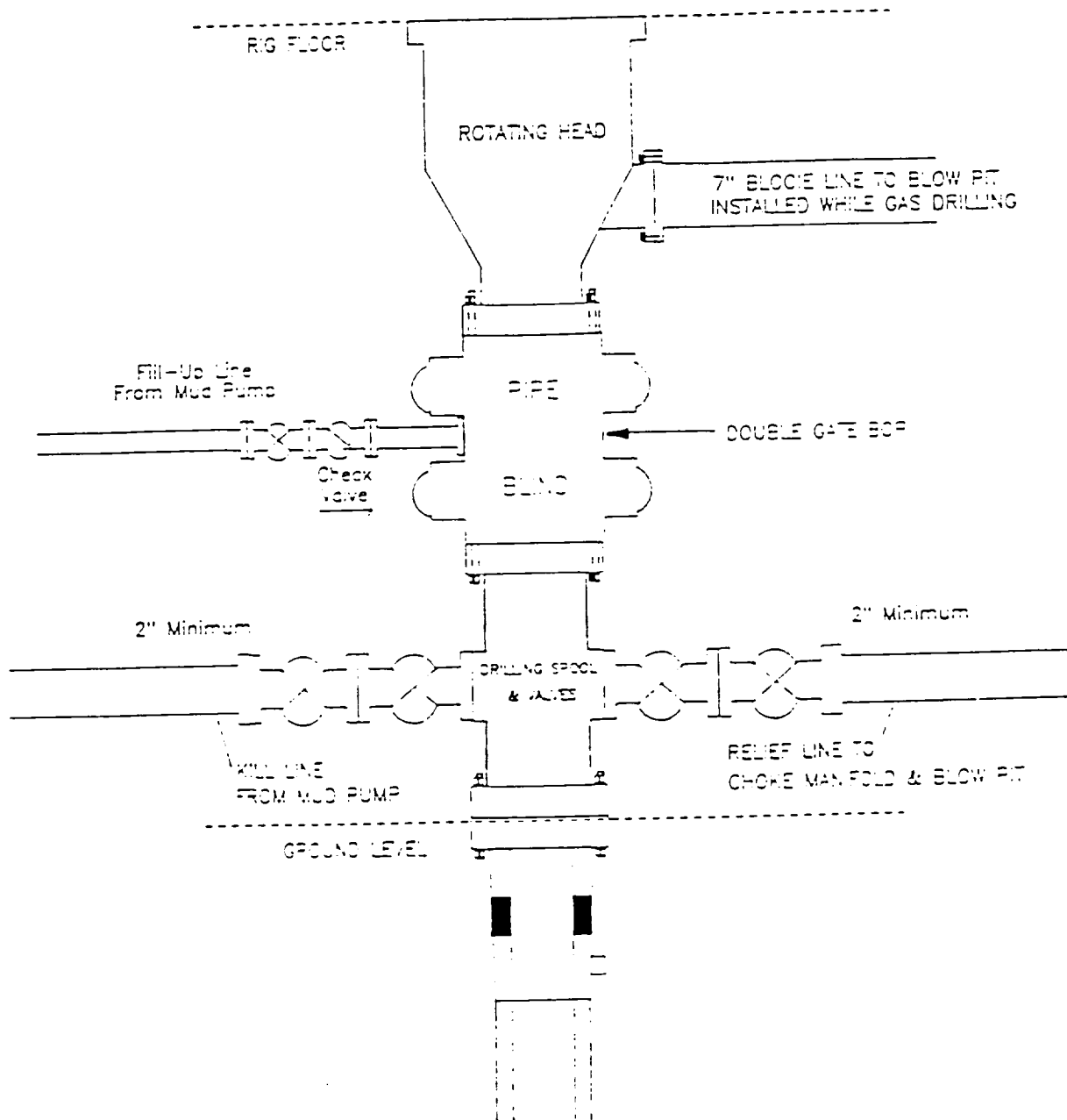

Minimum BOP installation for a Mesaverde well from Surface to Total Depth. 11" Bore, 2000psi minimum working pressure double gate BOP to be equipped with blind and pipe rams. A Schaffer Type 50 or equivalent rotating head to be installed on the top of the BOP. All equipment is 2000psi working pressure or greater.

Figure #1

ENERGEN RESOURCES CORPORATION JICARILLA 115E #13R

1010' FSL & 1555' FWL, SECTION 3, T26N, R3W, N.M.P.M.  
RIO ARriba COUNTY, NEW MEXICO

