

UNITED STATES
DEPARTMENT OF THE INTERIOR
BUREAU OF LAND MANAGEMENT

SUBMIT IN TRIPLICATE*
(Other instructions on
reverse side)

FORM APPROVED
OMB NO. 1004-0136
Expires: February 28, 1995

APPLICATION FOR PERMIT TO DRILL OR DEEPEN

1a. TYPE OF WORK DRILL <input checked="" type="checkbox"/> DEEPEN <input type="checkbox"/>		5. LEASE DESIGNATION AND SERIAL NO. Jic Cont 96	
b. TYPE OF WELL OIL WELL <input type="checkbox"/> GAS WELL <input checked="" type="checkbox"/> OTHER <input type="checkbox"/>		6. IF INDIAN, ALLOTTEE OR TRIBE NAME Jicarilla Apache	
2. NAME OF OPERATOR ENERGEN RESOURCES CORPORATION		7. UNIT AGREEMENT NAME 21938	
3. ADDRESS AND TELEPHONE NO. 2198 Bloomfield Highway; Farmington, NM 87401		8. FARM OR LEASE NAME, WELL NO. Jicarilla 96 8B	
4. LOCATION OF WELL (Report location clearly and in accordance with any State requirements.)* At surface 1980' FNL, 685' FWL At proposed prod. zone		9. API WELL NO. 30-039-26572	
14. DISTANCE IN MILES AND DIRECTION FROM NEAREST TOWN OR POST OFFICE* 15 miles NW of Lindrith, New Mexico		10. FIELD AND POOL, OR WILDCAT Blanco Mesaverde Gavilan Pictured Cliffs	
15. DISTANCE FROM PROPOSED* LOCATION TO NEAREST PROPERTY OR LEASE LINE, FT. (Also to nearest drlg. unit line, if any) 685'		11. SEC., T., R., M., OR BLK. AND SURVEY OR AREA E Sec. 12, T26N, R3W, N.M.P.M.	
16. NO. OF ACRES IN LEASE 2530.72		12. COUNTY OR PARISH Rio Arriba	
17. NO. OF ACRES ASSIGNED TO THIS WELL 320 W/2 MV 160 N/4 PC		13. STATE NM	
18. DISTANCE FROM PROPOSED LOCATION* TO NEAREST WELL, DRILLING, COMPLETED, OR APPLIED FOR, ON THIS LEASE, FT. 1800'		19. PROPOSED DEPTH 6301'	
20. ROTARY OR CABLE TOOLS Rotary		21. APPROX. DATE WORK WILL START*	
21. ELEVATIONS (Show whether DF, RT, GR, etc.) 7154' GL			

PROPOSED CASING AND CEMENTING PROGRAM

SIZE OF HOLE	GRADE SIZE OF CASING	WEIGHT PER FOOT	SETTING DEPTH	QUANTITY OF CEMENT
12-1/4"	9-5/8"	36#	200"	130 cu. ft., circ.
8-3/4"	7"	20 & 23#	4076'	919 cu. ft., circ
6-1/4"	4-1/2"	10.5#	3926'-6301'	366 cu. ft., circ. liner

An application is being filed with the NMOC to downhole commingle. Selectively perforate and sand water fracture the Pictured Cliffs and Mesaverde. This gas is dedicated.

NOTE: THIS IS A PIPELINE EXPEDITED APD.



IN ABOVE SPACE DESCRIBE PROPOSED PROGRAM: If proposal is to deepen, give data on present productive zone and proposed new productive zone. If proposal is to drill or deepen directionally, give pertinent data on subsurface locations and measured and true vertical depths. Give blowout preventer program, if any.

24. SIGNED [Signature] TITLE Production Superintendent DATE 9/1/00

(This space for Federal or State office use)

PERMIT NO. _____ APPROVAL DATE _____

Application approval does not warrant or certify that the applicant holds legal or equitable title to those rights in the subject lease which would entitle the applicant to conduct operations thereon.

CONDITIONS OF APPROVAL, IF ANY:

APPROVED BY [Signature] TITLE Acting Asst Field Mgr DATE NOV 22 2000

*See Instructions On Reverse Side

Title 18 U.S.C. Section 1001, makes it a crime for any person knowingly and willfully to make to any department or agency of the United States any false, fictitious or fraudulent statements or representations as to any matter within its jurisdiction.

District I
PO Box 1980, Hobbs, NM 88241-1980

State of New Mexico
Energy, Minerals & Natural Resources Department

Form C-102
Revised February 21, 1994

District II
PO Drawer DD, Artesia, NM 88211-0719

OIL CONSERVATION DIVISION
PO Box 2088
Santa Fe, NM 87504-2088

Submit to Appropriate District Office
State Lease - 4 Copies
Fee Lease - 3 Copies

District III
1000 Rio Brazos Rd., Aztec, NM 87410

District IV
PO Box 2088, Santa Fe, NM 87504-2088

☐ AMENDED REPORT

WELL LOCATION AND ACREAGE DEDICATION PLAT

*API Number 30-0-39-26572		*Pool Code 72319 / 77360	*Pool Name Blanco Mesaverde / Gavilan Pictured Cliffs
*Property Code 1938	*Property Name JICARILLA 96		*Well Number 88
*GRID No. 162928	*Operator Name ENERGEN RESOURCES CORPORATION		*Elevation 7154'

¹⁰ Surface Location

UL or lot no.	Section	Township	Range	Lot Idn	Feet from the	North/South line	Feet from the	East/West line	County
E	12	26N	3W		1980	NORTH	685	WEST	RIO ARriba

¹¹ Bottom Hole Location If Different From Surface

UL or lot no.	Section	Township	Range	Lot Idn	Feet from the	North/South line	Feet from the	East/West line	County

¹² Dedicated Acres FC-NW 160/320 - MV	¹³ Joint or Infill	¹⁴ Consolidation Code	¹⁵ Order No.
---	-------------------------------	----------------------------------	-------------------------

NO ALLOWABLE WILL BE ASSIGNED TO THIS COMPLETION UNTIL ALL INTERESTS HAVE BEEN CONSOLIDATED
OR A NON-STANDARD UNIT HAS BEEN APPROVED BY THE DIVISION

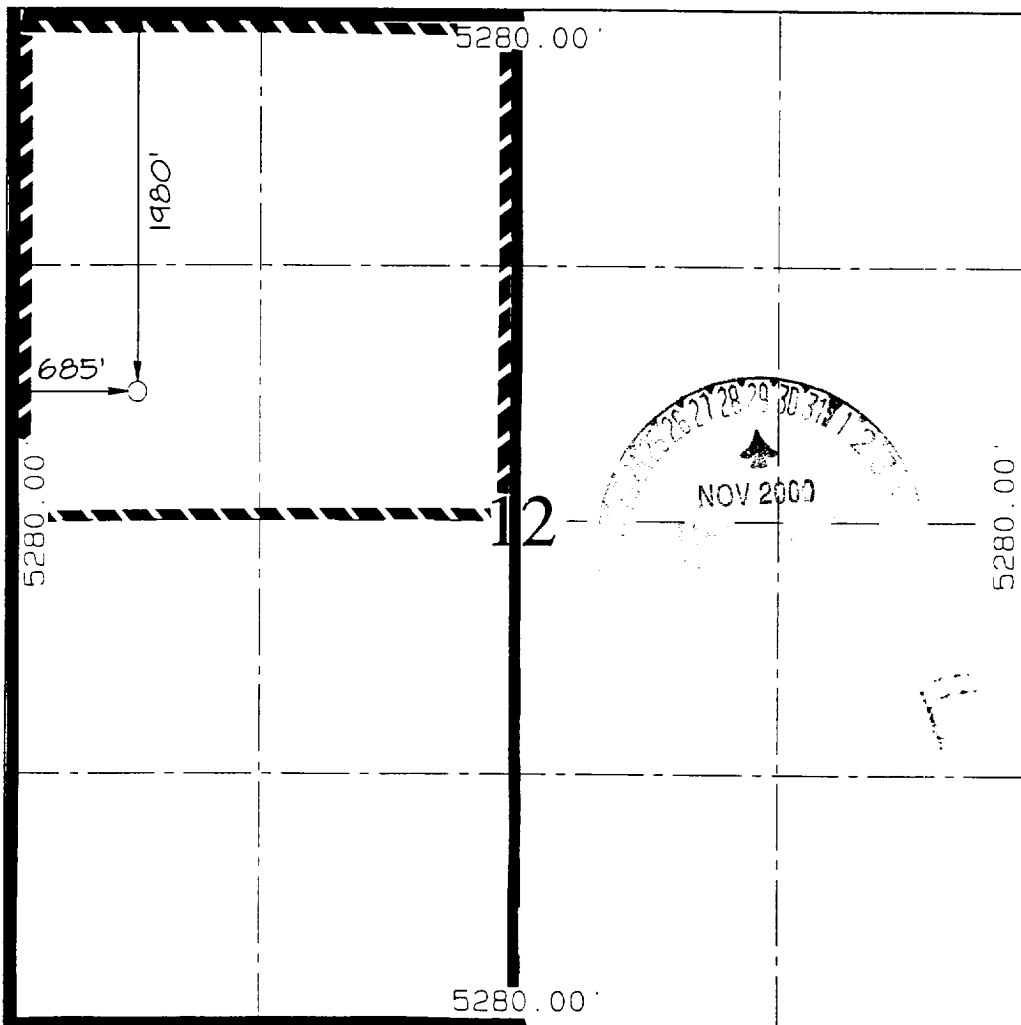
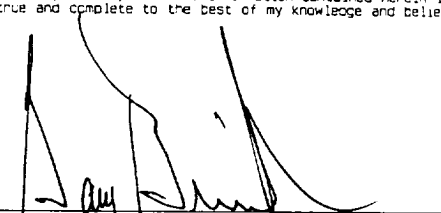
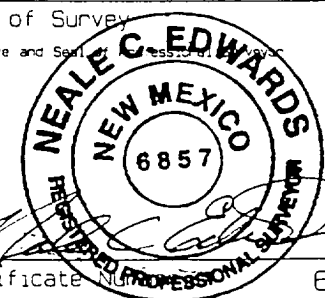
	<p>¹⁷ OPERATOR CERTIFICATION</p> <p>I hereby certify that the information contained herein is true and complete to the best of my knowledge and belief.</p> <p></p> <p>Signature Gary Brink Printed Name Production Superintendant Title 9/1/00 Date</p>
	<p>¹⁸ SURVEYOR CERTIFICATION</p> <p>I hereby certify that the well location shown on this plat was plotted from field notes of actual surveys made by me or under my supervision, and that the same is true and correct to the best of my belief.</p> <p>JULY 14, 2000 Date of Survey</p> <p>Signature and Seal  Certificate No. 6857</p>

ENERGEN RESOURCES CORPORATION

Mesa Verde / Dakota Well BOP Configuration

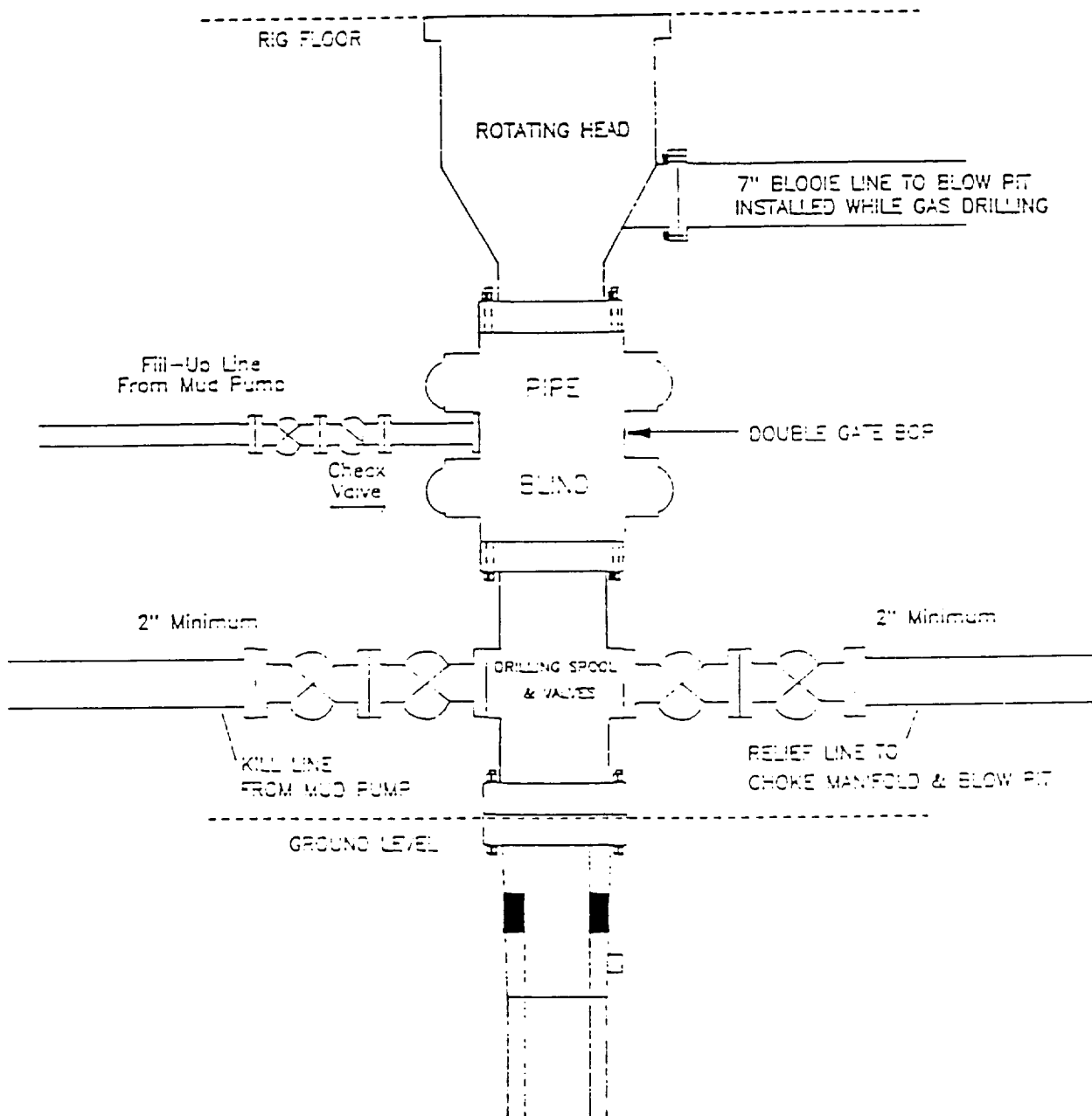

Minimum BOP installation for a Mesa Verde well from Surface to Total Depth. 11" Bore, 2000psi minimum working pressure double gate BOP to be equipped with blind and pipe rams. A Schaffer Type 50 or equivalent rotating head to be installed on the top of the BOP. All equipment is 2000psi working pressure or greater.

Figure #1

ENERGEN RESOURCES CORPORATION JICARILLA 96 #8B

1980' FNL & 685' FWL, SECTION 12, T26N, R3W, N.M.P.M.
RIO ARriba COUNTY, NEW MEXICO

