

(SUBMIT IN TRIPLICATE)

UNITED STATES  
DEPARTMENT OF THE INTERIOR  
GEOLOGICAL SURVEY

Land Office Santa Fe  
Lease No. 078987  
Unit Canyon Largo Unit  
14-08-001-1059

SUNDRY NOTICES AND REPORTS ON WELLS

NOTICE OF INTENTION TO DRILL	<input checked="" type="checkbox"/>	SUBSEQUENT REPORT OF WATER SHUT-OFF
NOTICE OF INTENTION TO CHANGE PLANS		SUBSEQUENT REPORT OF SHOOTING OR ACIDIZING
NOTICE OF INTENTION TO TEST WATER SHUT-OFF		SUBSEQUENT REPORT OF ALTERING CASING
NOTICE OF INTENTION TO RE-DRILL OR REPAIR WELL		SUBSEQUENT REPORT OF RE-DRILLING OR REPAIR
NOTICE OF INTENTION TO SHOOT OR ACIDIZE		SUBSEQUENT REPORT OF ABANDONMENT
NOTICE OF INTENTION TO PULL OR ALTER CASING		SUPPLEMENTARY WELL HISTORY
NOTICE OF INTENTION TO ABANDON WELL		

(INDICATE ABOVE BY CHECK MARK NATURE OF REPORT, NOTICE, OR OTHER DATA)

July 25, 1958

Well No. 18 is located 1450 ft. from XXXX [S] line and 990 ft. from XXXX [W] line of sec. 35  
SW Sec. 35 25W 7N N.M.P.M.  
(1/4 Sec. and Sec. No.) (Twp.) (Range) (Meridian)  
South Blanco Ext. Rio Arriba New Mexico  
(Field) (County or Subdivision) (State or Territory)

The elevation of the derrick floor above sea level is 6905 ft.

DETAILS OF WORK

(State names of and expected depths to objective sands; show sizes, weights, and lengths of proposed casings; indicate mudding logs, cementing points, and all other important proposed work)

It is intended to drill a well with rotary tools thru the Pictured Cliffs formation. Mud circulation will be used thru the Pictured Cliffs and set production casing. Possible productive intervals will be perforated and fractured. Net. T.D. 2624'.

Casing Program:

8 5/8" at 120' with 125 sacks cement circulated to the surface.  
5 1/2" at 2624' with 150 sacks cement.

The SW/4 of Section 35 is dedicated to this well.  
SW/4: S.F. 078987

I understand that this plan of work must receive approval in writing by the Geological Survey before operations may be commenced.

Company El Paso Natural Gas Company

Address Box 997  
Farmington, New Mexico

By Original Signed D. C. Johnston

Title Petroleum Engineer

July 25, 1958

## Section A.

Operator **El Paso Natural Gas Company** Canyon Largo **SF078987**  
 Well No. **18** Unit Letter **L** Section **35** Township **25N** Range **7W**  
 Location **1450** East-From **South** East-From **990** West **160**  
 County **Rio Arriba** T. 14. N. 16. E. 35. **6895**  
 Name of Producing Formation **Pictured Cliff** **Largo Canyon P.C. Ext.**

1. Is the Operator the only owner of the property on which the well is located?

Yes ☐ No ☒

2. If the answer to question 1 is "No", what is the name of the owner?

Name of owner **El Paso Natural Gas Company** Yes ☒ No ☐

## Unit Operating Agreement

3. If the answer to question 1 is "No", what is the name of the owner?

Owner



## Section B.

Name of Operator

This is to certify that the information in Section A is true and complete to the best of my knowledge and belief.

**El Paso Natural Gas Company**  
**Original Signed D. C. Johnston**

Representative

**Box 997**

Albuquerque

**Farmington, New Mexico**

Section 35

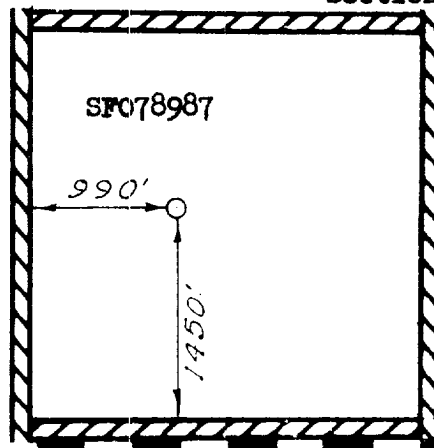

This is to certify that the information in Section A is true and complete to the best of my knowledge and belief.

Used

Farmington, New Mexico

July 17, 1958

*E. O. Walker*

Form 9-381a  
(Feb. 1951)

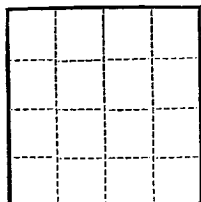

(SUBMIT IN TRIPLICATE)

UNITED STATES  
DEPARTMENT OF THE INTERIOR  
GEOLOGICAL SURVEY

Land Office Santa Fe  
Lease No. 078387  
Unit Canyon Largo Unit

SUNDRY NOTICES AND REPORTS ON WELLS

NOTICE OF INTENTION TO DRILL	SUBSEQUENT REPORT OF WATER SHUT-OFF	<input checked="" type="checkbox"/>
NOTICE OF INTENTION TO CHANGE PLANS	SUBSEQUENT REPORT OF SHOOTING OR ACIDIZING	
NOTICE OF INTENTION TO TEST WATER SHUT-OFF	SUBSEQUENT REPORT OF ALTERING CASING	
NOTICE OF INTENTION TO RE-DRILL OR REPAIR WELL	SUBSEQUENT REPORT OF RE-DRILLING OR REPAIR	
NOTICE OF INTENTION TO SHOOT OR ACIDIZE	SUBSEQUENT REPORT OF ABANDONMENT	
NOTICE OF INTENTION TO PULL OR ALTER CASING	SUPPLEMENTARY WELL HISTORY	
NOTICE OF INTENTION TO ABANDON WELL		

AUG 15 1958  
U. S. GEOLOGICAL SURVEY  
FARMINGTON, NEW MEXICO

(INDICATE ABOVE BY CHECK MARK NATURE OF REPORT, NOTICE, OR OTHER DATA)

August 13, 1958

Well No. 10 is located 1450 ft. from NE 1/4 line and 900 ft. from W 1/2 line of sec. 35  
SW Sec. 35 25N 7W S.M.P.M.  
(1/4 Sec. and Sec. No.) (Twp.) (Range) (Meridian)  
South Blasen P.C. Rd. Hia Arriba New Mexico  
(Field) (County or Subdivision) (State or Territory)

The elevation of the derrick floor above sea level is 6035 ft.

DETAILS OF WORK

(State names of and expected depths to objective sands; show sizes, weights, and lengths of proposed casings; indicate mudding jobs, cementing points, and all other important proposed work)

Spdn Date 7-27-58.

On 7-28-58. Total Depth 131'.

Run 4 joints 8 5/8", 24#, spiral weld casing (116') set at 125' with 100 sacks regular cement, 50 cu. ft. perlite, and 25# CaCl, circulated to surface.

Held 500# for 30 minutes.

I understand that this plan of work must receive approval in writing by the Geological Survey before operations may be commenced.

Company El Paso Natural Gas Company

Address Box 997

Farmington, New Mexico

By Original Signed D. C. Johnston

Title Petroleum Engineer