

(SUBMIT IN TRIPLICATE)

UNITED STATES  
DEPARTMENT OF THE INTERIOR  
GEOLOGICAL SURVEY

Land Office Santa Fe  
Lease No. 079866  
Unit 7aughn

SUNDRY NOTICES AND REPORTS ON WELLS

RECEIVED

NOTICE OF INTENTION TO DRILL	<input checked="" type="checkbox"/>	SUBSEQUENT REPORT OF WATER SHUT-OFF	
NOTICE OF INTENTION TO CHANGE PLANS		SUBSEQUENT REPORT OF SHOOTING OR ACIDIZING	
NOTICE OF INTENTION TO TEST WATER SHUT-OFF		SUBSEQUENT REPORT OF ALTERING CASING	
NOTICE OF INTENTION TO RE-DRILL OR REPAIR WELL		SUBSEQUENT REPORT OF RE-DRILLING OR REPAIR	
NOTICE OF INTENTION TO SHOOT OR ACIDIZE		SUBSEQUENT REPORT OF ABANDONMENT	
NOTICE OF INTENTION TO PULL OR ALTER CASING		SUPPLEMENTARY WELL HISTORY	
NOTICE OF INTENTION TO ABANDON WELL			

(INDICATE ABOVE BY CHECK MARK NATURE OF REPORT, NOTICE, OR OTHER DATA)

December 2, 1959

Well No. 6 is located 990 ft. from S line and 1500 ft. from E line of sec. 26  
SE/4 Sec. 26 26N 6W N.M.P.M.  
(1/4 Sec. and Sec. No.) (Twp.) (Range) (Meridian)  
Co. Blanco P. C. Pio Arriba New Mexico  
(Field) (County or Subdivision) (State or Territory)

The elevation of the derrick floor above sea level is 6636 ft.

DETAILS OF WORK

(State names of and expected depths to objective sands; show sizes, weights, and lengths of proposed casings; indicate mudding and cementing points, and all other important proposed work)

It is intended to drill a well thru the Pictured Cliffs formation using rotary tools and to perforate and water fracture possible producing zones. Est. T. D. 3005'.

Casing Program:

8 5/8" at 120' with 125 sacks regular cement circulated to surface.  
5 1/2" at 3005' with 75 sacks regular cement, 75 sacks Pozmix.

The SE/4 of section 26 is dedicated to this well.

I understand that this plan of work must receive approval in writing by the Geological Survey before operations may be commenced.

Company El Paso Natural Gas Company  
Box 997  
 Address Farmington, New Mexico

By ORIGINAL SIGNED B.H. MEANS  
 Title Petroleum Engineer

## NEW MEXICO OIL CONSERVATION COMMISSION

## Well Location and Acreage Dedication Plat

Section A.

Date **DECEMBER 1, 1959**

Operator **EL PASO NATURAL GAS COMPANY** Lease **VAUGHN** SF **079266**  
 Well No. **6** Unit Letter **0** Section **26** Township **26-N** Range **6-W**  
 Located **990** Feet From **SOUTH** Line, **1500** East Line  
 County **RIO ARRIBA** G. L. Elevation **6626** D. H. A. **160**  
 Name of Producing Formation **PICTURED CLIFF** Plat **SO. BLANCO PICTURED CLIFF**

1. Is the Operator the only owner in the dedicated acreage outlined on this plat now?  
 Yes ☒ No ☐
2. If the answer to question one is "no", have the interests of all the owners been ascertained by the Operator by agreement or otherwise? Yes ☐ No ☐ If answer is "yes", list the names of owners.
3. If the answer to question two is "no", list all the owners and their respective interests below.
- | Owner | Interest |
|-------|----------|
|-------|----------|



Section B.

Note: All distances must be from center of well.

This is to certify that the information in Section A above is true and complete to the best of my knowledge and belief.

**El Paso Natural Gas Company**

(Operator)

**ORIGINAL SIGNED B.H. MEANS**

(Representative)

**Box 997**

(Address)

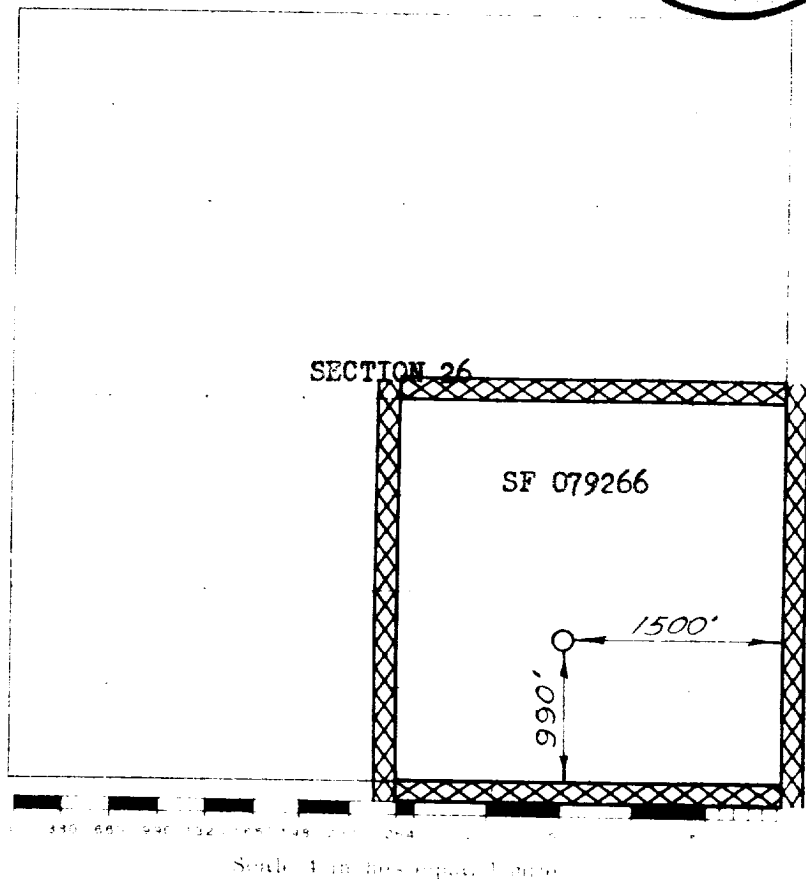
**Farmington, New Mexico**

Scale: 4 inches equal 1 mile

This is to certify that the above plat was prepared from the data furnished to me or under my supervision and that the same is true and correct to the best of my knowledge and belief.

(Seal)

Date Signed **NOVEMBER 28, 1959**

*David O. Kilner*  
 Registered Professional Surveyor and Land Surveyor

Farmington, New Mexico