

(SUBMIT IN TRIPLICATE)

UNITED STATES
DEPARTMENT OF THE INTERIOR
GEOLOGICAL SURVEY

Budget Bureau No. 42-R358.4.
Approval expires 12-31-60.

Land Office Santa Fe
Lease No. SP 079958
Unit Lockhart "A"

SUNDRY NOTICES AND REPORTS ON WELLS

NOTICE OF INTENTION TO DRILL.....	SUBSEQUENT REPORT OF WATER SHUT-OFF.....	<u>Surface</u>	<u>X</u>
NOTICE OF INTENTION TO CHANGE PLANS.....	SUBSEQUENT REPORT OF SHOOTING OR ACIDIZING.....		
NOTICE OF INTENTION TO TEST WATER SHUT-OFF.....	SUBSEQUENT REPORT OF ALTERING CASING.....		
NOTICE OF INTENTION TO RE-DRILL OR REPAIR WELL.....	SUBSEQUENT REPORT OF RE-DRILLING OR REPAIR.....		
NOTICE OF INTENTION TO SHOOT OR ACIDIZE.....	SUBSEQUENT REPORT OF ABANDONMENT.....		
NOTICE OF INTENTION TO PULL OR ALTER CASING.....	SUPPLEMENTARY WELL HISTORY.....		
NOTICE OF INTENTION TO ABANDON WELL.....			

(INDICATE ABOVE BY CHECK MARK NATURE OF REPORT, NOTICE, OR OTHER DATA)

Well No. Lockhart "A" 2 is located 990 ft. from N line and 1650 ft. from E line of sec. 31
Nw/4 Section 31 (1/4 Sec. and Sec. No.) 25N (Twp.) 10W (Range) N.M. (County) N.M. (State or Territory)
Dist. 1 (Collins) (Field) Santa Fe (County or Subdivision) New Mexico (State or Territory)

The elevation of the derrick floor above sea level is _____ ft.

DETAILS OF WORK

(State names of and expected depths to objective sands; show sizes, weights, and lengths of proposed casings; indicate mudding jobs, cementing points, and all other important proposed work)

SPUDDING: 3:00 P.M., November 4, 1957.

Run and set 9-5/8" OD casing at 239' and cemented with 275 sacks cement. Cement circulated.



I understand that this plan of work must receive approval in writing by the Geological Survey before operations may be commenced.

Company SKELLY OIL COMPANY
Box 426
Address Farmington, New Mexico

By _____

Title District Superintendent

NEW MEXICO OIL CONSERVATION COMMISSION
Well Location and Acreage Dedication Plat

Section A.

Date FEBRUARY 4, 1958

Operator THE SKELLY OIL COMPANY Lease L. E. LOCKHART
Well No. 2 Unit Letter I Section 33 Township 25 North Range 10 West NMPM
Located 1980' Feet From the South Line, 660' Feet From the East Line
County SAN JUAN G. L. Elevation _____ Dedicated Acreage 80 Acres
Name of Producing Formation Gallup Pool Bisti

1. Is the Operator the only owner* in the dedicated acreage outlined on the plat below?
Yes X No _____.
2. If the answer to question one is "no," have the interests of all the owners been consolidated by communitization agreement or otherwise? Yes _____ No _____. If answer is "yes," Type of Consolidation _____
3. If the answer to question two is "no," list all the owners and their respective interests below:

Owner

Land Description

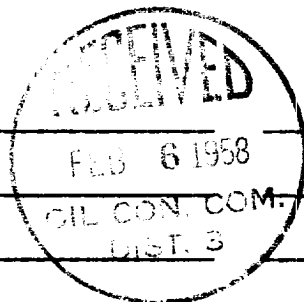

Section B

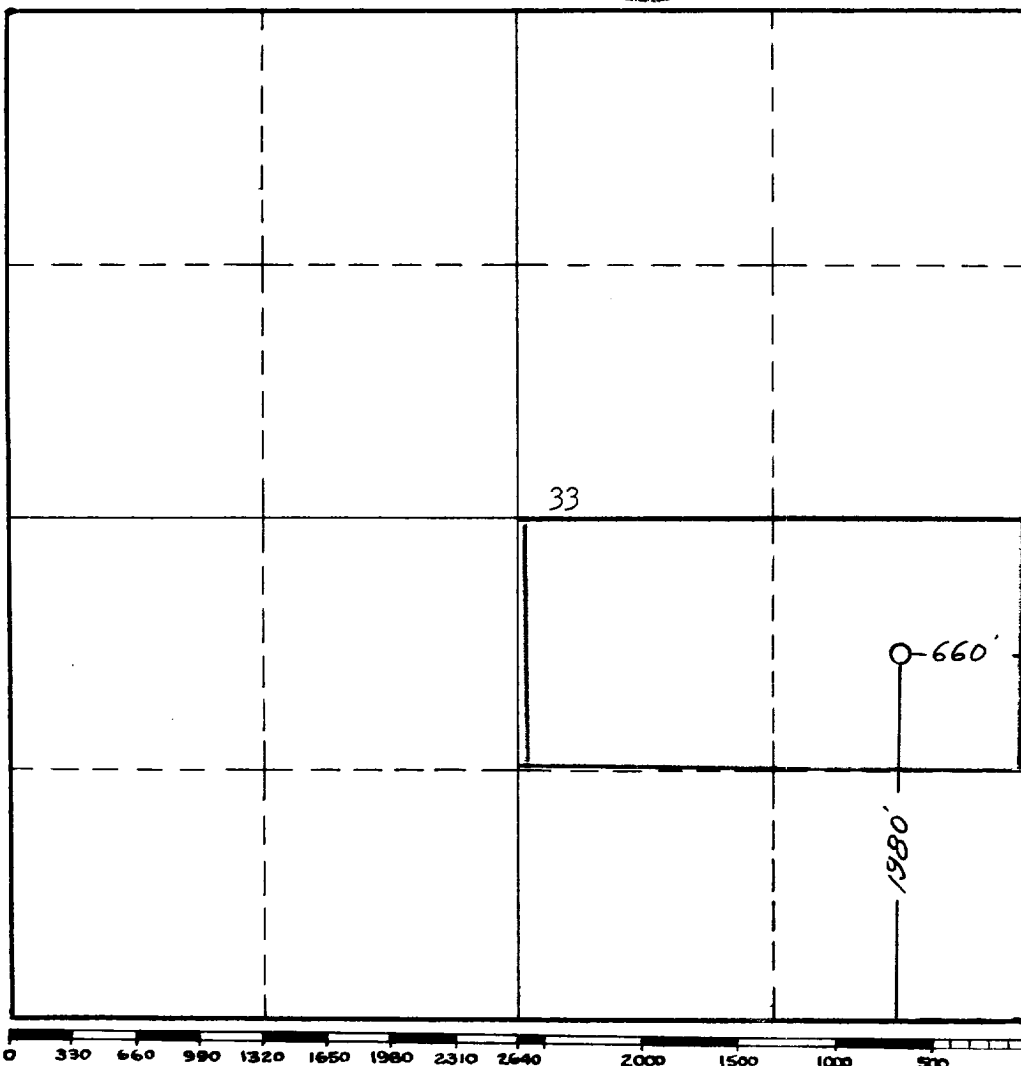

This is to certify that the information in Section A above is true and complete to the best of my knowledge and belief.

Skelly Oil Company
(Operator)

(Signed) P. E. Coster
(Representative)

Box 426, Farmington, New Mexico
Address

This is to certify that the well location shown on the plat in Section B was plotted from field notes of actual surveys made by me or under my supervision and that the same is true and correct to the best of my knowledge and belief.

Date Surveyed 13 July 1957

James P. Leese
Registered Professional
Engineer and/or Land Surveyor.
James P. Leese

Certificate No. 1463

(See instructions for completing this form on the reverse side)

INSTRUCTIONS FOR COMPLETION:

1. Operator shall furnish and certify to the information called for in Section A.
2. Operator shall outline the dedicated acreage for both oil and gas wells on the plat in Section B.
3. A registered professional engineer or land surveyor registered in the State of New Mexico or approved by the Commission shall show on the plat the location of the well and certify this information in the space provided.
4. All distances shown on the plat must be from the outer boundaries of Section.
5. If additional space is needed for listing owners and their respective interests as required in question 3, Section A, please use space below

OIL CONSERVATION COMMISSION		
AZTEC DISTRICT OFFICE		
No. Copies Received	3	
DATE RECEIVED		
OPERATOR		
APPROVED BY	1	
VERIFICATION CODE		
STATE LAND OFFICE		
C. O. L. B.	1	
TRANSFER		
FILE	1	<input checked="" type="checkbox"/>

* "Owner" means the person who has the right to drill into and to produce from any pool and to appropriate the production either for himself or for himself and another. (65-3-29 (e) NMSA 1953 Comp.)