

NEW MEXICO OIL CONSERVATION COMMISSION  
Well Location and Acreage Dedication Plat

Section A.

Date \_\_\_\_\_

Operator PETRO-ATLAS INCORPORATED Lease ~~P. DEWE~~ ATLAS A  
Well No. 2 Unit Letter 7 Section 34 Township 25 NORTH Range 10 WEST NMPM  
Located 1980 Feet From THE NORTH Line, 1980 Feet From THE WEST Line  
County SAN JUAN G. L. Elevation 6735.0 Dedicated Acreage 10 Acres  
Name of Producing Formation GALLUP Pool BISTI

1. Is the Operator the only owner\* in the dedicated acreage outlined on the plat below?  
Yes ☒ No ☐.
2. If the answer to question one is "no," have the interests of all the owners been consolidated by communitization agreement or otherwise? Yes ☐ No ☐. If answer is "yes," Type of Consolidation \_\_\_\_\_
3. If the answer to question two is "no," list all the owners and their respective interests below:  
**REF. GLO Plat dated: 11 June 1934**

Owner

Land Description

\_\_\_\_\_  
\_\_\_\_\_  
\_\_\_\_\_

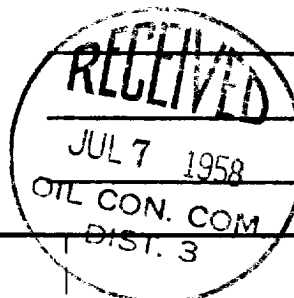

**RECEIVED**

JUL 2 1958

U. S. GEOLOGICAL SURVEY  
FARMINGTON, NEW MEXICO

Section. B

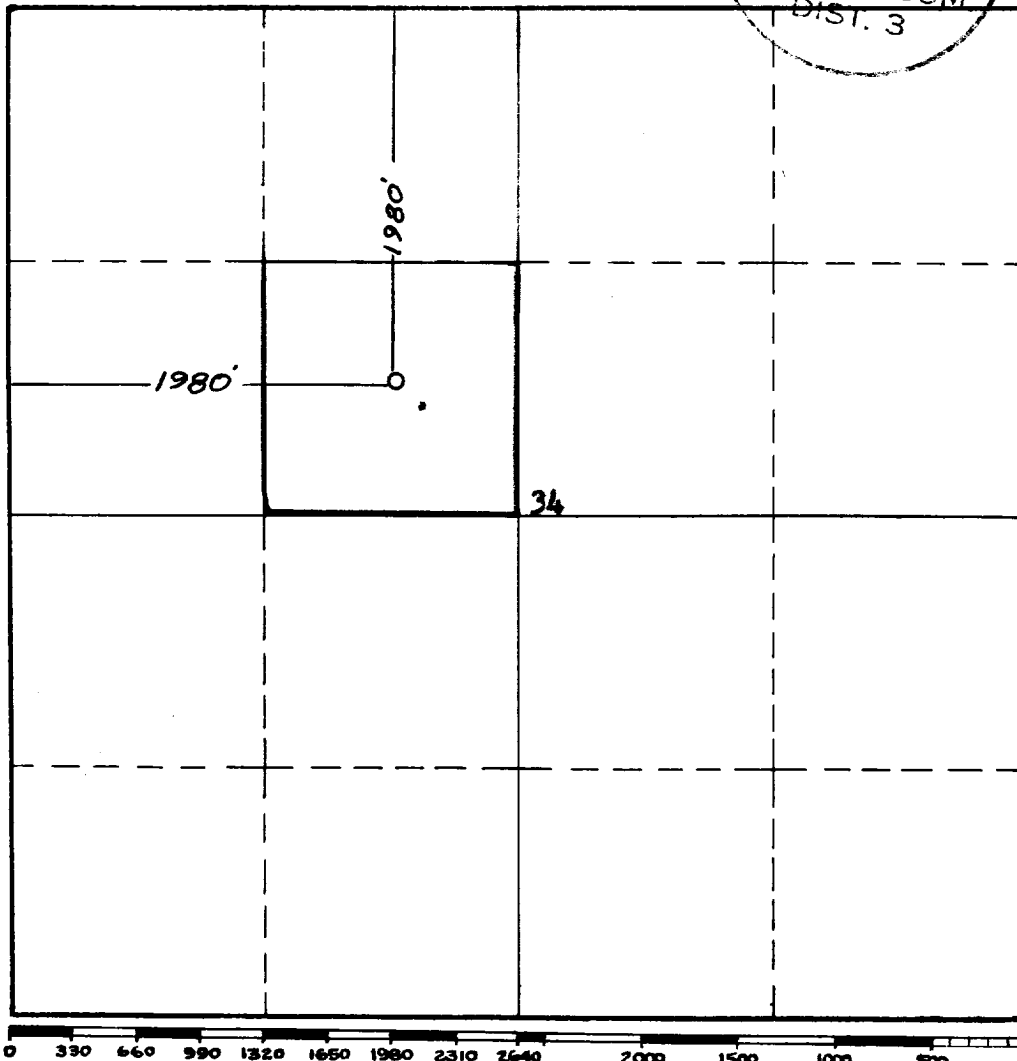

This is to certify that the information in Section A above is true and complete to the best of my knowledge and belief.

Petro-Atlas Inc.  
(Operator)

James E. Baker  
(Representative)

Address \_\_\_\_\_

This is to certify that the well location shown on the plat in Section B was plotted from field notes of actual surveys made by me or under my supervision and that the same is true and correct to the best of my knowledge and belief.

Date Surveyed 14 SEPTEMBER 1957

James P. Leese  
Registered Professional  
Engineer and/or Land Surveyor.  
**JAMES P. LEESE**

Certificate No. 1463

(See instructions for completing this form on the reverse side)

INSTRUCTIONS FOR COMPLETION:

1. Operator shall furnish and certify to the information called for in Section A.
2. Operator shall outline the dedicated acreage for both oil and gas wells on the plat in Section B.
3. A registered professional engineer or land surveyor registered in the State of New Mexico or approved by the Commission shall show on the plat the location of the well and certify this information in the space provided.
4. All distances shown on the plat must be from the outer boundaries of Section.
5. If additional space is needed for listing owners and their respective interests as required in question 3, Section A, please use space below

\* "Owner" means the person who has the right to drill into and to produce from any pool and to appropriate the production either for himself or for himself and another. (65-3-29 (e) NMSA 1953 Comp.)