

NEW MEXICO OIL CONSERVATION COMMISSION
Well Location and Acreage Dedication Plat

Section A. Date Feb. 1, 1958

Operator SKELLY OIL COMPANY Lease L. EL LOCKHART
Well No. 6 Unit Letter I Section 28 Township 25 NORTH Range 10 WEST, NMPM
Located 1980 Feet From the SOUTH Line, 660 Feet From the EAST Line
County SAN JUAN G. L. Elevation _____ Dedicated Acreage 80 Acres
Name of Producing Formation Gallup Pool Bisti - Ext.

1. Is the Operator the only owner* in the dedicated acreage outlined on the plat below?
Yes x No _____.
2. If the answer to question one is "no," have the interests of all the owners been consolidated by communitization agreement or otherwise? Yes _____ No _____. If answer is "yes," Type of Consolidation _____
3. If the answer to question two is "no," list all the owners and their respective interests below:
Ref: GLO plat dated 24 January 1935

<u>Owner</u>	<u>Land Description</u>
_____	_____
_____	_____
_____	_____

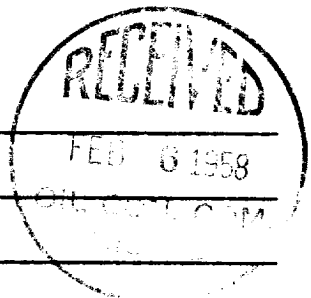

Section B

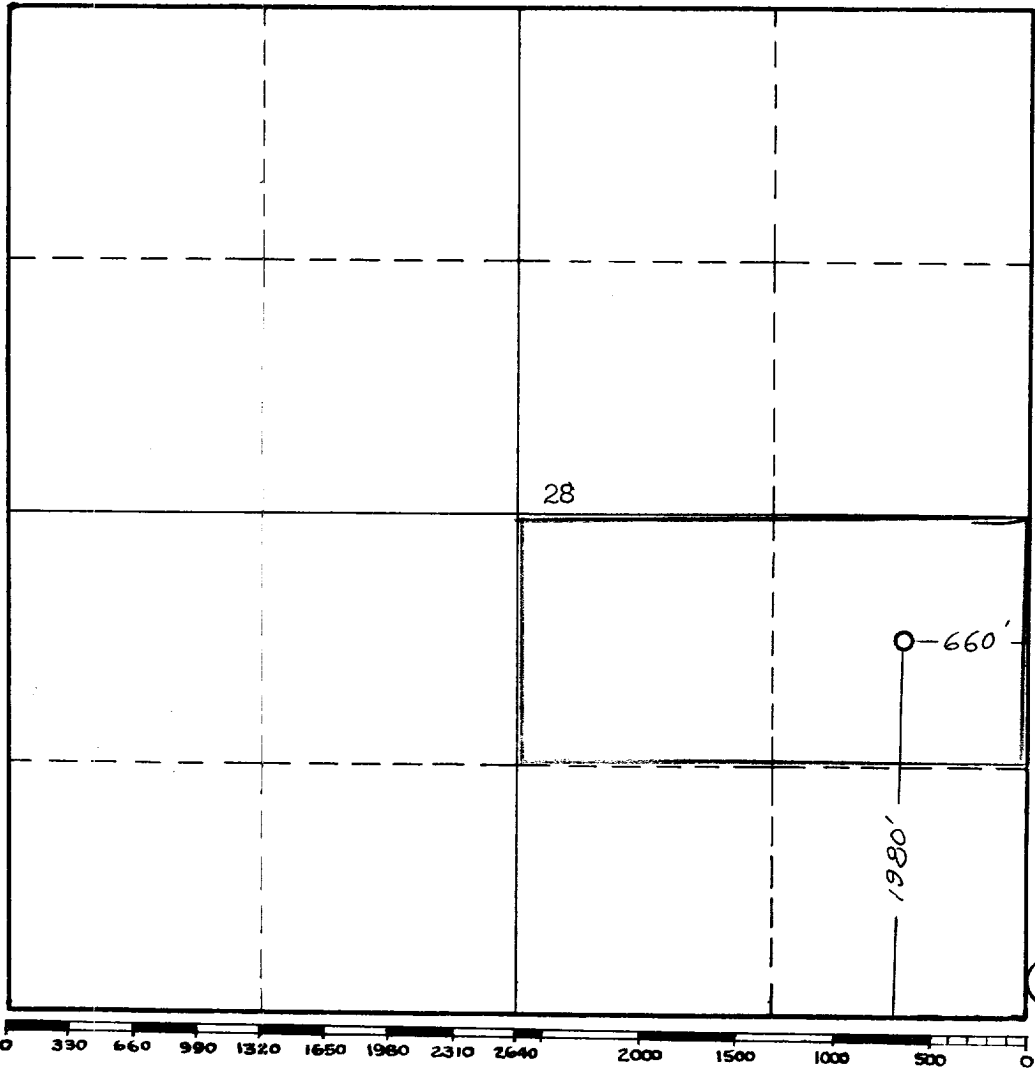

This is to certify that the information in Section A above is true and complete to the best of my knowledge and belief.

SKELLY OIL COMPANY
(Operator)
P. E. Cooper
(Representative)
Box 426, Farmington, New Mexico
Address

This is to certify that the well location shown on the plat in Section B was plotted from field notes of actual surveys made by me or under my supervision and that the same is true and correct to the best of my knowledge and belief.
Date Surveyed 26 November 1957

James P. Leese
Registered Professional
Engineer and/or Land Surveyor.
James P. Leese

Certificate No. 1463

INSTRUCTIONS FOR COMPLETION:

1. Operator shall furnish and certify to the information called for in Section A.
2. Operator shall outline the dedicated acreage for both oil and gas wells on the plat in Section B.
3. A registered professional engineer or land surveyor registered in the State of New Mexico or approved by the Commission shall show on the plat the location of the well and certify this information in the space provided.
4. All distances shown on the plat must be from the outer boundaries of Section.
5. If additional space is needed for listing owners and their respective interests as required in question 3, Section A, please use space below

NATIONAL CONSERVATION COMMISSION		
AZTEC DISTRICT OFFICE		
Mr. [illegible]	3	
[illegible]	/	
[illegible]	/	
Treasurer		
File	/	✓

* "Owner" means the person who has the right to drill into and to produce from any pool and to appropriate the production either for himself or for himself and another. (65-3-29 (e) NMSA 1953 Comp.)