

(SUBMIT IN TRIPLICATE)

UNITED STATES
DEPARTMENT OF THE INTERIOR
GEOLOGICAL SURVEY

Land Office _____

Lease No. 3F078530

Unit _____

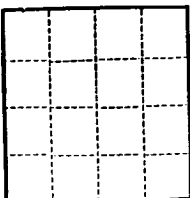

SUNDRY NOTICES AND REPORTS ON WELLS

NOTICE OF INTENTION TO DRILL.....	<input checked="" type="checkbox"/>	SUBSEQUENT REPORT OF WATER SHUT-OFF.....
NOTICE OF INTENTION TO CHANGE PLANS.....		SUBSEQUENT REPORT OF SHOOTING OR ACIDIZING.....
NOTICE OF INTENTION TO TEST WATER SHUT-OFF.....		SUBSEQUENT REPORT OF ALTERING CASING.....
NOTICE OF INTENTION TO RE-DRILL OR REPAIR WELL.....		SUBSEQUENT REPORT OF RE-DRILLING OR REPAIR.....
NOTICE OF INTENTION TO SHOOT OR ACIDIZE.....		SUBSEQUENT REPORT OF ABANDONMENT.....
NOTICE OF INTENTION TO PULL OR ALTER CASING.....		SUPPLEMENTARY WELL HISTORY.....
NOTICE OF INTENTION TO ABANDON WELL.....		

(INDICATE ABOVE BY CHECK MARK NATURE OF REPORT, NOTICE, OR OTHER DATA)

March 29, 1960

Federal Well No. 20-1 is located 990 ft. from N line and 990 ft. from E line of sec. 20

SE 1-20
(1/4 Sec. and Sec. No.)

25
(Twp.)

9
(Range)

W.M.P.M.
(Meridian)

Wildest
(Field)

San Juan
(County or Subdivision)

New Mexico
(State or Territory)

The elevation of the derrick floor above sea level is 6643 ft.

DETAILS OF WORK

(State names of and expected depths to objective sands; show sizes, weights, and lengths of proposed casings; indicate mud, cement, and all other important proposed work)

Operator plans to test Dakota Sand @ 6800'.

Casing Program: 0 - 200' of 9-5/8" OD, 32# J SR ST&C Range 2 Casing.
0 - 6800' of 4-1/2" OD 9.5# J SR ST&C Range 2 Casing, and
4-1/2" OD 11.6# J SR ST&C Casing Range 2.

Mud Program: 0 - 200' Spud Mud
0 - 4000' Sample Mud

4000' - 6800' Gel type mud suitable for obtaining samples & logs.

Cement Program: 0 - 200' Sufficient cement to circulate cement on surface.
200' - 6660' Sufficient cement to cover the Gallup Formation.

I understand that this plan of work must receive approval in writing by the Geological Survey before operations may be commenced.

Company BRANSON, M. J., Jr.

Address 4225 Glenwood Drive

Fort Worth, Texas

By [Signature]

Title Drilling Superintendent



NEW MEXICO OIL CONSERVATION COMMISSION
WELL LOCATION AND ACREAGE DEDICATION PLAT

FORM C-128
Revised 5/1/57

SEE INSTRUCTIONS FOR COMPLETING THIS FORM ON THE REVERSE SIDE

SECTION A

Operator M. J. BRANNON, JR.		Lease FEDERAL		Well No. 20 - 1
Unit Letter P	Section 20	Township 25 NORTH	Range 9 WEST	County SAN JUAN
Actual Footage Location of Well: 990 feet from the SOUTH line and 990 feet from the EAST line				
Ground Level Elev. 6643.0	Producing Formation Dakota	Pool Undesignated	Dedicated Acreage: 1.320 Acres	

Ref: GLO plat dated 10 May 1949

- Is the Operator the only owner in the dedicated acreage outlined on the plat below? YES _____ NO _____. ("Owner" means the person who has the right to drill into and to produce from any pool and to appropriate the production either for himself or for himself and another. (65-3-29 (e) NMSA 1935 Comp.)
- If the answer to question one is "no," have the interests of all the owners been consolidated by community consolidation or otherwise? YES _____ NO _____. If answer is "yes," Type of Consolidation _____
- If the answer to question two is "no," list all the owners and their respective interests below:

Owner	Land Description

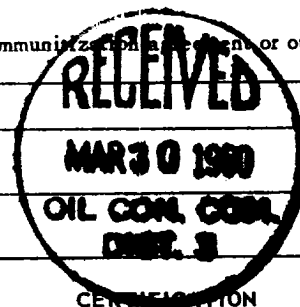

SECTION B

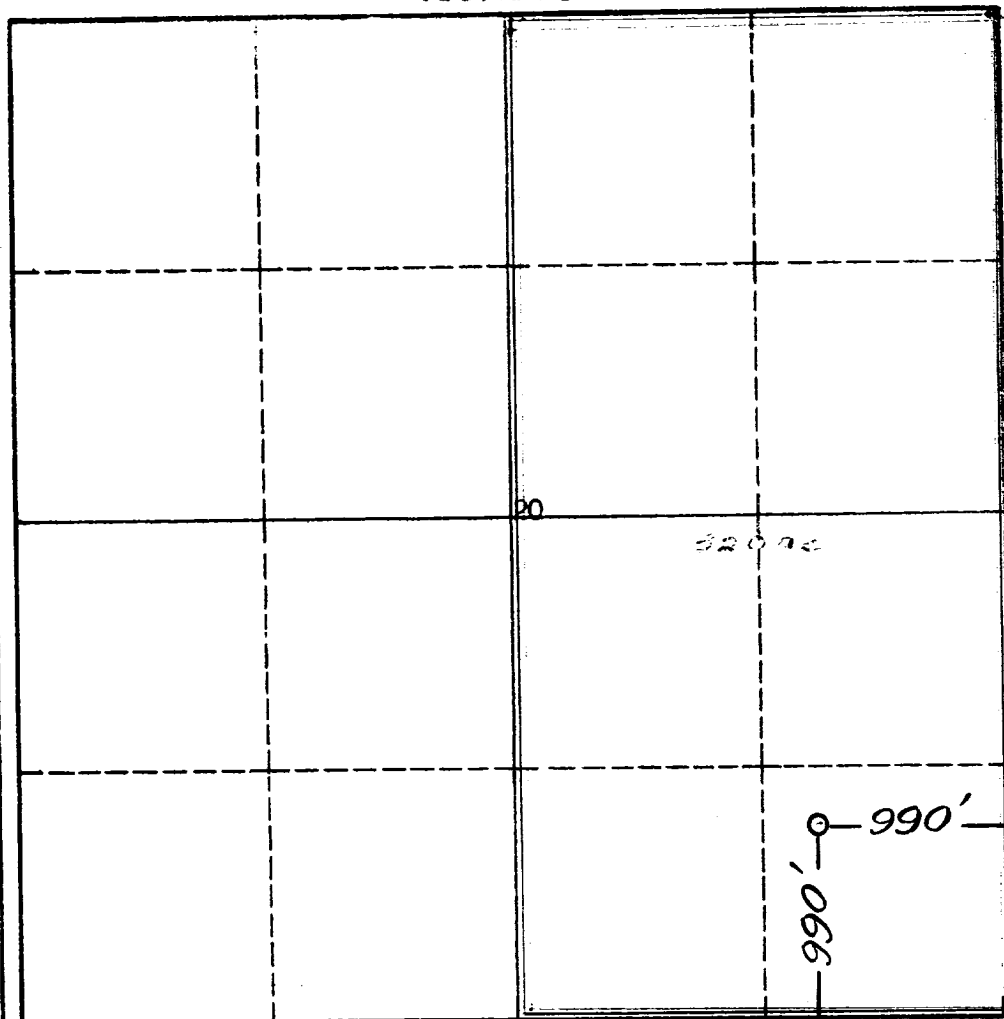

I hereby certify that the information in SECTION A above is true and complete to the best of my knowledge and belief.

Name _____
Position _____
Company _____
Date 3-29-60

I hereby certify that the well location shown on the plat in SECTION B was plotted from field notes of actual surveys made by me or under my supervision, and that the same is true and correct to the best of my knowledge and belief.

Date Surveyed
29 March 1960
Registered Professional Engineer
and/or Land Surveyor
James P. Leese
Certificate No. 1463

0 330 660 990 1320 1650 1980 2310 2640 2000 1500 1000 500 0

INSTRUCTIONS FOR COMPLETION OF FORM C-128

1. Operator shall furnish and certify to the information called for in Section A.
2. Operator shall outline the dedicated acreage for *both* oil and gas wells on the plat in Section B.
3. A registered professional engineer or land surveyor registered in the State of New Mexico or approved by the Commission shall show on the plat the location of the well and certify this information in the space provided.
4. All distances shown on the plat must be from the outer boundaries of the Section.
5. If additional space is needed for listing owners and their respective interests as required in question 3 of Section A, please use space below.

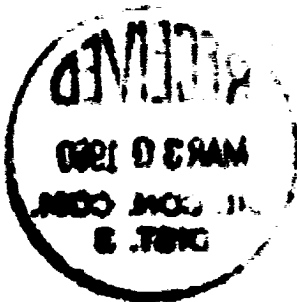

OIL CONSERVATION COMMISSION		
AZTEC DISTRICT OFFICE		
No. Copies Received <u>2</u>		
DISTRIBUTION		
	NO. RECEIVED	
Operator		
Santa Fe	/	
Proration Office		
State Land Office		
U. S. G. S.		
Transporter		
File	/	✓