

UNITED STATES
DEPARTMENT OF THE INTERIOR
GEOLOGICAL SURVEY

APPLICATION FOR PERMIT TO DRILL, DEEPEN, OR PLUG BACK

1a. TYPE OF WORK DRILL <input checked="" type="checkbox"/> DEEPEN <input type="checkbox"/> PLUG BACK <input type="checkbox"/>		5. LEASE DESIGNATION AND SERIAL NO. NM 0117074-4	
b. TYPE OF WELL OIL WELL <input type="checkbox"/> GAS WELL <input checked="" type="checkbox"/> OTHER <input type="checkbox"/>		6. IF INDIAN, ALLOTTEE OR TRIBE NAME ---	
2. NAME OF OPERATOR Consolidated Oil & Gas, Inc.		7. UFFI AGREEMENT NAME ---	
3. ADDRESS OF OPERATOR 4150 East Mexico Avenue, Denver 22, Colorado		8. FARM OR LEASE NAME Mills	
4. LOCATION OF WELL (Report location clearly and in accordance with any State requirements.) At surface 1650' FWL & 1650' FSL, Section 19, Township 25 At proposed prod. zone North, Range 9 West		9. WELL NO. 1	
14. DISTANCE IN MILES AND DIRECTION FROM NEAREST TOWN OR POST OFFICE* Approx. 3 miles from Huerfano Trading Post		10. FIELD AND POOL, OR WILDCAT Basin Dakota	
15. DISTANCE FROM NEAREST LOCATION TO NEAREST WELL, DRILLING, COMPLETED, OR APPLIED FOR, ON THIS LEASE, FT. 1650'		11. SEC., T., R., M., OR BLK. AND SURVEY OR AREA Sec. 19-25N-9W	
16. NO. OF ACRES IN LEASE 320		12. COUNTY OR PARISH San Juan	
17. NO. OF ACRES ASSIGNED TO THIS WELL 320		13. STATE N. Mex.	
18. PROPOSED DEPTH 6625'		20. ROTARY OR CABLE TOOLS Rotary	
21. ELEVATIONS (Show whether DF, RT, GR, etc.) 6734' GL		22. APPROX. DATE WORK WILL START* 5/14/65	

PROPOSED CASING AND CEMENTING PROGRAM

SIZE OF HOLE	SIZE OF CASING	WEIGHT PER FOOT	SETTING DEPTH	QUANTITY OF CEMENT
12-1/4"	8-5/8"	32	300	150 sacks
7-7/8"	4-1/2"	11.6	6475	250 sacks

Drill 12-1/4" hole to 300', set 8-5/8" casing and cement to surface. Mud drill 7-7/8" hole to 6625' KB. Run 4-1/2" casing to total depth and cement with 250 sacks. WOC 24 hrs. and pressure test. Selectively perforate, sand water frac and complete as a single zone Dakota well.

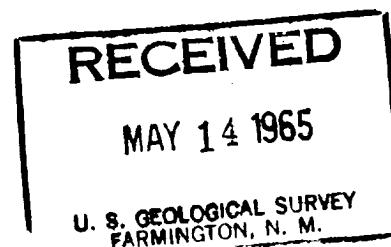

IN ABOVE SPACE DESCRIBE PROPOSED PROGRAM: If proposal is to deepen or plug back, give data on present productive zone and proposed new productive zone. If proposal is to drill or deepen directionally, give pertinent data on subsurface locations and measured and true vertical depths. Give blowout prevention program, if any.

24

SIGNED A. Williams TITLE Chief Engineer DATE 5/13/65

(This space for Federal or State office use)

PERMIT NO. _____ APPROVAL DATE _____

APPROVED BY [Signature] TITLE _____

CONDITIONS OF APPROVAL, IF ANY:

*See Instructions On Reverse Side

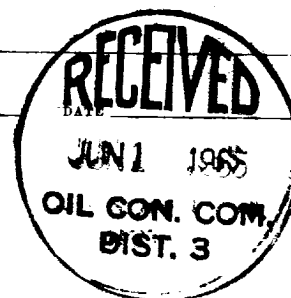

NEW MEXICO OIL CONSERVATION COMMISSION

Well Location and Acreage Dedication Plat

Section A

Date May 13, 1965

Operator CONSOLIDATED OIL & GAS, INC. Lease MILLS
 Well No. 1 Unit Letter K Section 19 Township 25 NORTH Range 9 WEST NMPM
 Located 1650 Feet From the SOUTH Line, 1650 Feet From the WEST Line
 County SAN JUAN G. L. Elevation 6734.0 Dedicated Acreage 320.5 321.40 Acres
 Name of Producing Formation Dakota Pool Basin

1. Is the Operator the only owner in the dedicated acreage outlined on the plat below?

Yes X No

2. If the answer to question one is "no", have the interests of all the owners been consolidated by communitization agreement or otherwise? Yes No If answer is "yes", Type of Consolidation.

3. If the answer to question two is "no", list all the owners and their respective interests below.

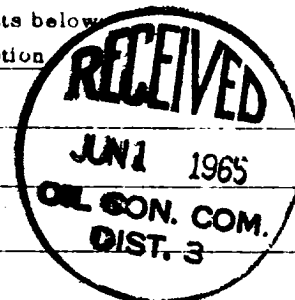
OwnerLand Description

Section B.

Note: All distances must be from outer boundaries of section.

This is to certify that the information
 in Section A above is true and complete
 to the best of my knowledge and belief.

Consolidated Oil & Gas, Inc.OperatorW. H. Williams

(Representative)

W. H. Williams

(Address)

4150 East Mexico AvenueDenver 22, Colorado

Ref: GLO plat dated 10 May, 1949

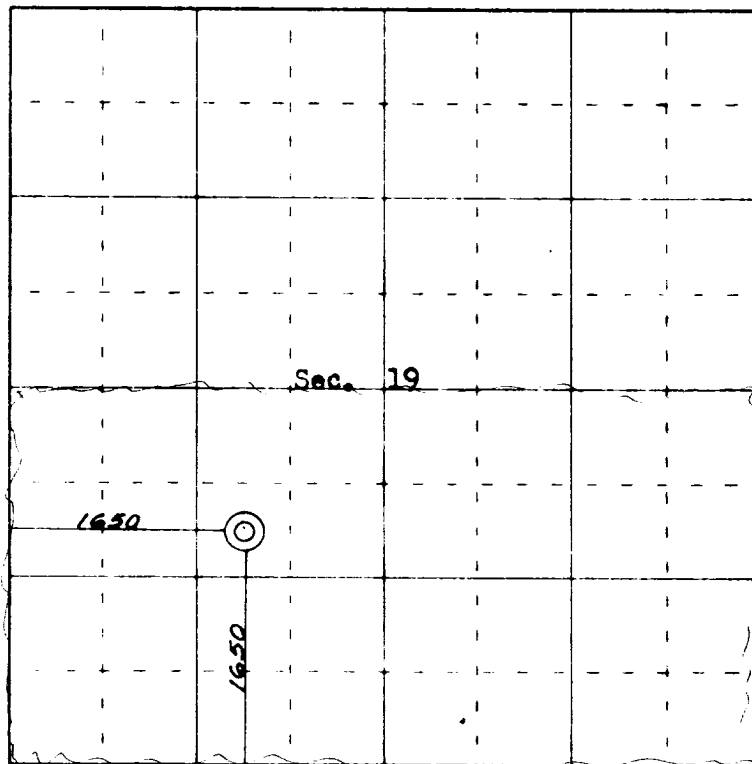

N

0 330 660 990 1320 1650 1980 2310 2640 2000 1800 1600 1400 1200 1000 800 600 400 200 0

Scale 4 inches equal 1 mile



(Seal)

This is to certify that the above plat was prepared from field notes of actual surveys
 made by me or under my supervision and that the same are true and correct to the best
 of my knowledge and belief.

Date Surveyed April 14, 1965

James P. Leese
 Registered Professional Engineer and/or Land Surveyor
 James P. Leese, N. Mex. Reg. No. 1463
 San Juan Engineering Company

Farmington, New Mexico

CONSOLIDATED OIL & GAS, INC.

3-25-68

WELLS REQUIRING FILE CORRECTION ONLY

LEASE NAME & WELL NUMBER	LOCATION	POOL	PRESENT ACREAGE	CORRECT ACREAGE
Ladd #1	C-19-25N-9W	Basin Dak.	N 320	N 321.80 ✓
Mills #1	K-19-25N-9W	Basin Dak.	S 320	S 321.40 ✓
Huerfano #1	A-30-25N-9W	Basin Dak.	N 320	N 321.14 ✓
Navajo #1	A-2-25N-10W	Basin Dak.	E 320	E 319.79 ✓
Huron #3	A-2-26N-4W	Tapacito PC	160	160.58 ✓
Huron #3	A-2-26N-4W	Blanco MV	E 320	E 320.58 ✓
Huron #2	D-2-26N-4W	Tapacito PC	160	160.80 ✓
Huron #2	D-2-26N-4W	Basin Dak.	W 320	W 320.80 ✓
Huron #1	M-2-26N-4W	Blanco MV	W 320	W 320.80 ✓
Huron #4	P-2-26N-4W	Basin Dak.	E 320	E 320.58 ✓
Linda #1	M-31-27N-8W	Blanco MV.	W 320	W 322.40 ✓
Rourke #1	M-4-30N-13W	Basin Dak.	W 320	W 320.20 ✓
Mitchell #1	N-5-31N-12W	Basin Dak.	W 320	W 318.36 ✓
Southern Union #2	A-19-31N-12W	Basin Dak.	N 320	N 318.24 ✓
XXXXXX	XXXXXXXXXXXXXXXXXXXXXXXXXXXX		WXXX800	WXX82X
Hancock #1	A-1-31N-13W	Blanco MV	N 317.78	N 319.20 ✓
Chavez Com #1	A-2-31N-13W	Blanco MV	E 320	E 319.40 ✓
Alberding #1	A-3-31N-13W	Blanco MV	E 319.03	E 320.10 ✓
Landauer #1	H-3-31N-13W	Basin Dak.	E 319.03	E 320.10 ✓
O'Shea #1	K-3-31N-13W	Blanco MV	W 319.92	W 320.30 ✓
O'Shea #1	K-3-31N-13W	Basin Dak.	W 319.92	W 320.30 ✓
Baird #1	H-4-31N-13W	Blanco MV	E 320	E 320.90 ✓
Baird #1	H-4-31N-13W	Basin Dak.	E 320	E 320.90 ✓