

(SUBMIT IN TRIPLICATE)

UNITED STATES  
DEPARTMENT OF THE INTERIOR  
GEOLOGICAL SURVEY

Land Office Santa Fe  
Lease No. 078517  
Unit \_\_\_\_\_

SUNDRY NOTICES AND REPORTS ON WELLS

NOTICE OF INTENTION TO DRILL	<input checked="" type="checkbox"/>	SUBSEQUENT REPORT OF WATER SHUT-OFF	
NOTICE OF INTENTION TO CHANGE PLANS		SUBSEQUENT REPORT OF SHOOTING OR ACIDIZING	
NOTICE OF INTENTION TO TEST WATER SHUT-OFF		SUBSEQUENT REPORT OF ALTERING CASING	
NOTICE OF INTENTION TO RE-DRILL OR REPAIR WELL		SUBSEQUENT REPORT OF RE-DRILLING OR REPAIR	
NOTICE OF INTENTION TO SHOOT OR ACIDIZE		SUBSEQUENT REPORT OF ABANDONMENT	
NOTICE OF INTENTION TO PULL OR ALTER CASING		SUPPLEMENTARY WELL HISTORY	
NOTICE OF INTENTION TO ABANDON WELL			

(INDICATE ABOVE BY CHECK MARK NATURE OF REPORT, NOTICE, OR OTHER DATA)

11-12-59, 19

Well No. 1 is located 1980 ft. from 25N line and 790 ft. from 9W line of Sec. 12E  
NE 1/4 SE 1/4 of Sec 24 25N 9W RMPN  
 (1/4 Sec. and Sec. No.) (Twp.) (Range) (Meridian)  
 \_\_\_\_\_  
 (Field) San Juan New Mexico  
 (County or Subdivision) (State or Territory)

The elevation of the derrick floor above sea level is \_\_\_\_\_ ft. (Will furnish later)

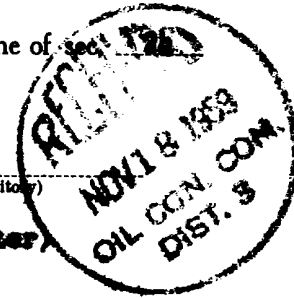

DETAILS OF WORK

(State names of and expected depths to objective sands; show sizes, weights, and lengths of proposed casings; indicate mudding jobs, cementing points, and all other important proposed work)

It is proposed to drill a well to test the Dakota formation to an approximate total depth of 6600'. Approximately 300' of 8-5/8" OD surface casing will be set and cemented to surface. If commercial production is encountered, 5 1/2" OD production casing will be set. All possible productive zones will be adequately tested or evaluated by means of coring, DST's and K-logs.

I understand that this plan of work must receive approval in writing by the Geological Survey before operations may be commenced.

Company Gulf Oil Corporation  
 Address Production Department  
P. O. Box 1346  
Salt Lake City, Utah  
 By T. A. Tray  
 Title Area Production Supt.

## NEW MEXICO OIL CONSERVATION COMMISSION

Well Location and Acreage Dedication Plat

## Section A.

Date 11-18-59

Operator Gulf Oil Corporation Lease Government  
 Well No. 1 Unit Letter E Section 24 Township 25 North Range 9 West NMPM  
 Located 1980 Feet From South Line, 790 Feet From East Line  
 County San Juan G. L. Elevation 6528 Dedicated Acreage 300 Acres  
 Name of Producing Formation Del Norte Pool Del Norte

1. Is the Operator the only owner\* in the dedicated acreage outlined on the plat below?  
 Yes        No X
2. If the answer to question one is "no," have the interests of all the owners been consolidated by communitization agreement or otherwise? Yes X No       . If answer is "yes,"  
 Type of Consolidation by means of Operating Agreement
3. If the answer to question two is "no," list all the owners and their respective interests below:

OwnerLand Description

\_\_\_\_\_  
 \_\_\_\_\_  
 \_\_\_\_\_

\_\_\_\_\_  
 \_\_\_\_\_  
 \_\_\_\_\_

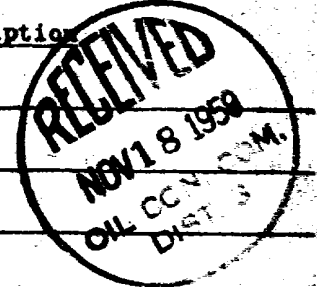

## Section B

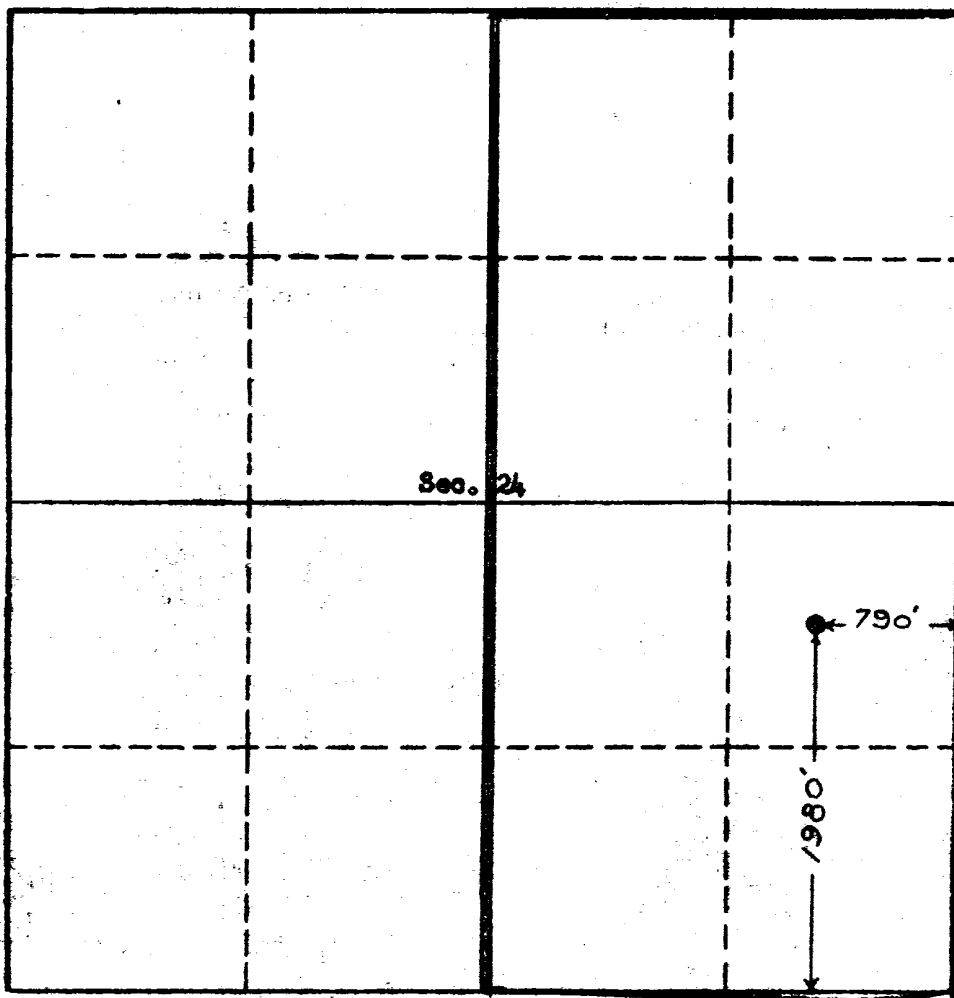

This is to certify that the information in Section A above is true and complete to the best of my knowledge and belief.

Gulf Oil Corporation

(Operator)

T. A. Tray

(Representative)

Productions Department  
P. O. Box 1348

Address

2800 Lake Road, West

This is to certify that the well location on the plat is correct and that the survey was made by my Surveyor and to the best of my knowledge and belief.

Date Surveyed Oct. 4, 1959

Ernest V. Echshaw  
 Registered Land Surveyor.

Certificate No. 1545

THE UNITED STATES OF AMERICA

DEPARTMENT OF JUSTICE

OFFICE OF THE ATTORNEY GENERAL

WASHINGTON, D. C. 20530

RECEIVED  
JAN 10 1964  
U.S. DEPT. OF JUSTICE  
OFFICE OF THE ATTORNEY GENERAL  
WASHINGTON, D. C. 20530

# UNITED STATES OF AMERICA vs. JAMES EARL RAY

THE UNITED STATES OF AMERICA, Plaintiff,  
vs.  
JAMES EARL RAY, Defendant.

Case No. 100-100000-1

Filed for the Court at St. Louis, Missouri, on January 10, 1964.

Presented for the Court at St. Louis, Missouri, on January 10, 1964.

Respectfully submitted,

\_\_\_\_\_  
Attorney General



Very truly yours,

\_\_\_\_\_  
Attorney General

Enclosed for the Court at St. Louis, Missouri, are:

1. A copy of the indictment returned by the grand jury at St. Louis, Missouri, on January 10, 1964.

Respectfully submitted,

\_\_\_\_\_  
Attorney General

THE UNITED STATES OF AMERICA, Plaintiff,  
vs.  
JAMES EARL RAY, Defendant.

Case No. 100-100000-1

Filed for the Court at St. Louis, Missouri, on January 10, 1964.

Presented for the Court at St. Louis, Missouri, on January 10, 1964.

Respectfully submitted,

\_\_\_\_\_  
Attorney General

THE UNITED STATES OF AMERICA, Plaintiff,  
vs.  
JAMES EARL RAY, Defendant.

Case No. 100-100000-1

Filed for the Court at St. Louis, Missouri, on January 10, 1964.

Presented for the Court at St. Louis, Missouri, on January 10, 1964.

Respectfully submitted,

\_\_\_\_\_  
Attorney General