



UNITED STATES
DEPARTMENT OF THE INTERIOR
GEOLOGICAL SURVEY
P. O. Box 965
Farmington, New Mexico

May 8, 1956



Benson-Montin
105 1/2 West Broadway
Farmington, New Mexico

Re: Santa Fe 078482-A

Gentlemen:

Receipt is acknowledged of your "Notice of Intention to Drill" dated May 7, 1956 covering your well No. 1 Graham in NE 1/4 NE 1/4 sec. 24, T. 25 N., R. 8 W., N. M. P. M., San Juan County, New Mexico, Ballard ext.

Your proposed work is hereby approved subject to compliance with the provisions of the "Oil and Gas Operating Regulations" revised May 25, 1942, a copy of which will be sent to you on request, and subject to the following conditions:

1. Drilling operations so authorized are subject to the attached sheet for general conditions of approval.
2. Furnish copies of all logs.

Very truly yours,

Jerry W. Long

Jerry W. Long
Acting District Engineer

JWLong:ac

(SUBMIT IN TRIPLICATE)

UNITED STATES
DEPARTMENT OF THE INTERIOR
GEOLOGICAL SURVEY

Land Office Santa Fe

Lease No. 078482-A

Unit Graham

NE/4 Sec. 24 is
Designated Drilling
Unit

SUNDRY NOTICES AND REPORTS ON WELLS

NOTICE OF INTENTION TO DRILL	<input checked="" type="checkbox"/>	SUBSEQUENT REPORT OF WATER SHUT-OFF
NOTICE OF INTENTION TO CHANGE PLANS	<input type="checkbox"/>	SUBSEQUENT REPORT OF SHOOTING OR ACIDIZING
NOTICE OF INTENTION TO TEST WATER SHUT-OFF	<input type="checkbox"/>	SUBSEQUENT REPORT OF ALTERING CASING
NOTICE OF INTENTION TO RE-DRILL OR REPAIR WELL	<input type="checkbox"/>	SUBSEQUENT REPORT OF REDRILLING OR REPAIR
NOTICE OF INTENTION TO SHOOT OR ACIDIZE	<input type="checkbox"/>	SUBSEQUENT REPORT OF ABANDONMENT
NOTICE OF INTENTION TO PULL OR ALTER CASING	<input type="checkbox"/>	SUPPLEMENTARY WELL HISTORY
NOTICE OF INTENTION TO ABANDON WELL	<input type="checkbox"/>	

RECEIVED
MAY 8 1956
GEOLOGICAL SURVEY
FARMINGTON, NEW MEXICO

(INDICATE ABOVE BY CHECK MARK NATURE OF REPORT, NOTICE, OR OTHER DATA)

May 7th, 1956

Well No. 1 is located 860ft. from N line and 1100ft. from E line of sec. 24

NE/4 NE/4 Sec. 24 25N 8W N.M.P.M.
(1/4 Sec. and Sec. No.) (Twp.) (Range) (Meridian)
Ballard ext. San Juan New Mexico
(Field) (County or Subdivision) (State or Territory)

The elevation of the derrick floor above sea level is 6557ft.

DETAILS OF WORK

(State names of and expected depths to objective sands; show sizes, weights, and lengths of proposed casings; indicate mudlogging jobs, cementing points, and all other important proposed work)

Pictured Cliffs Sand test. Estimated total depth 2300'.

Surface Casing: 90' of 8-5/8" OD 24# J-55 cemented to surface.

Production " : Approximately 2200' of 5-1/2" OD 15.5# J-55 cemented with 100 sacks.

If commercial production is indicated, the producing section will be shot with nitroglycerin and/or sand-oil treated.

I understand that this plan of work must receive approval in writing by the Geological Survey before operations may be commenced.

Company BENSON-MONTIN

Address 405 1/2 West Broadway

Farmington, New Mexico

By W. H. Green

Title Field Superintendent

NEW MEXICO
OIL CONSERVATION COMMISSION

Form C-128

Well Location and/or Gas Proration Plat

Date _____

Operator BENSON - MONTIN - GREER DRILLING CORP. Lease GRAHAM

Well No. 1 Section 24 Township 25 NORTH Range 8 WEST, NMPM

Located 860 Feet From the NORTH Line, 1100 Feet From the EAST Line,

SAN JUAN County, New Mexico. G. L. Elevation 6549.0 UNGRADED.

Name of Producing Formation Pictured Cliffs Pool Ballard Dedicated Acreage 160

(Note: All distances must be from outer boundaries of Section)

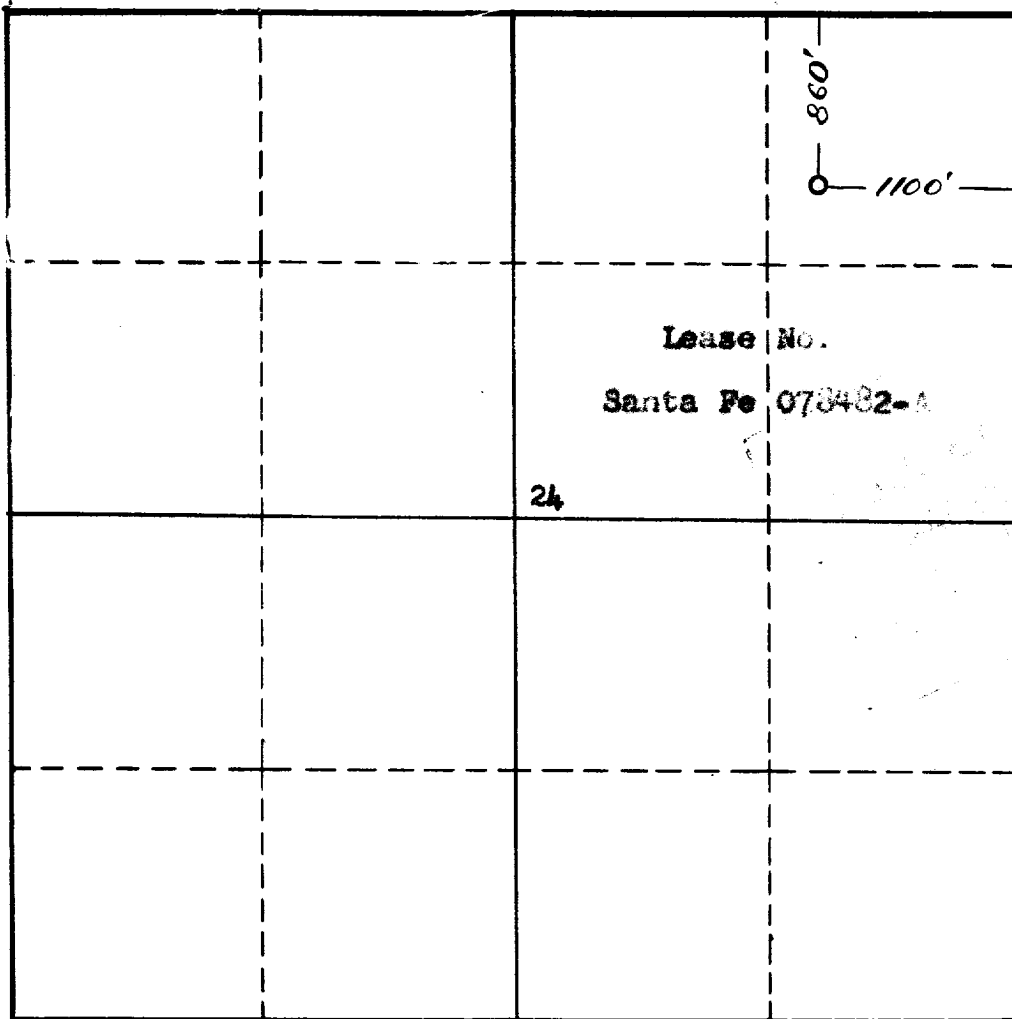

NOTE

This section of
form is to be
used for gas
wells only.



SCALE: 1"=1000'

1. Is this Well a Dual Comp. ? Yes No X.
2. If the answer to Question 1 is yes, are there any other dually completed wells within the dedicated acreage ? Yes No .

Name James P. Leese
Position Field Superintendent
Representing Benson-Montin
Address 4052 W. Broadway, Farmington, N.M.

This is to certify that the above plat was prepared from field notes of actual surveys made by me or under my supervision and that the same are true and correct to the best of my knowledge and belief.

Date Surveyed 1 FEBRUARY 1956
James P. Leese
Registered Professional Engineer and/or
Land Surveyor James P. Leese
N. Mex. Reg. No. 1463

COMPANY **BENSON - MONTIN - GREER DRILLING CORPORATION**

Well Name & No. **GRAHAM NO. 1**

Lease No. _____

Location **860' FROM THE NORTH LINE AND 1100' FROM THE EAST LINE.**

Being in **SW NE NE**

Sec. **24**, T **25** N., R. **2** W., N. M. P. M.,

SAN JUAN COUNTY, NEW MEXICO

Ground Elevation **6549.0 UNGRADED.**

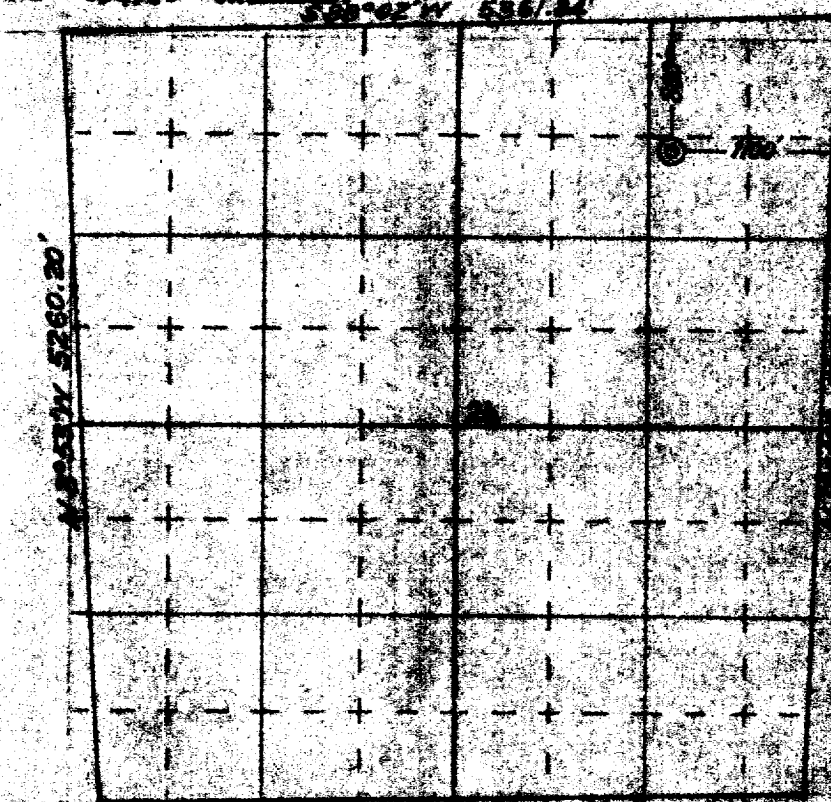

Scale - 1 inch equals 1 mile

Surveyed

J. P. LANE

1936

This is to certify that the above plot was prepared from field notes of actual survey made by me or under my supervision and that the same are true and correct to the best of my knowledge and belief.

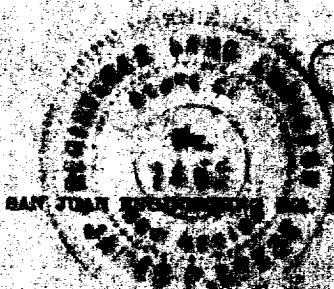

J. P. Lane
Registered Land Surveyor
JAMES P. LANE
S. MEX. REG. NO. 122

SAN JUAN COUNTY, NEW MEXICO, BARRINGTON, NEW MEXICO