

NEW MEXICO OIL CONSERVATION COMMISSION

Well Location and Acreage Dedication Plat

Section A.

Date February 19, 1958

Operator MAGNOLIA PETROLEUM COMPANY Lease SADIE CANUTO  
Well No. 1 Unit Letter  Section 21 Township 25N Range 71E NM  
Located 841.7 Feet From North Line, 71.1 Feet From West Line  
County San Juan G. L. Elevation  Dedicated Acreage 80 Acres  
Name of Producing Formation SAN JUAN Pool 1

1. Is the Operator the only owner\* in the dedicated acreage outlined on the plat below?  
Yes  No .
2. If the answer to question one is "no," have the interests of all the owners been consolidated by communitization agreement or otherwise? Yes  No . If answer is "yes," Type of Consolidation
3. If the answer to question two is "no," list all the owners and their respective interests below:

Owner

Land Description



Section B. N 89° 17' W - 39.94 Ch. (Call)

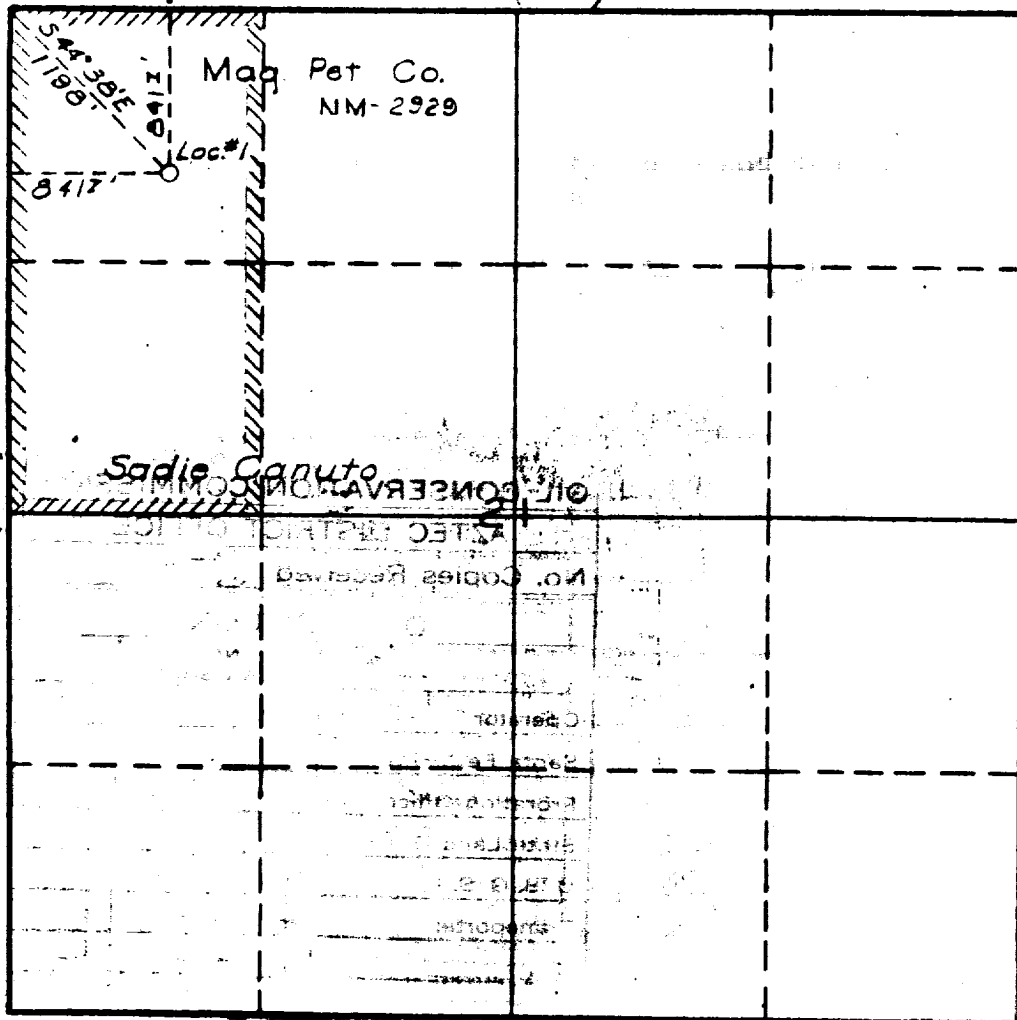

This is to certify that the information in Section A above is true and complete to the best of my knowledge and belief.

Magnolia Petroleum Company

(Operator)

G. Young, Jr.  
(Representative)

Box 2406, Hobbs, New Mexico

Address

This is to certify that the well location shown on the plat in Section B was plotted from field notes of actual surveys made by me or under my supervision and that the same is true and correct to the best of my knowledge and belief.

Date Surveyed

Carl E. Turner

Registered Professional  
Engineer and/or Land Surveyor

Certificate No.

OIL CONSERVATION COMMISSION		
AZTEC DISTRICT OFFICE		
No. Copies Received <u>5</u>		
DISTRIBUTION		
	NO. FURNISHED	
Operator	<u>2</u>	
Santa Fe	<u>1</u>	
Proration Office		
State Land Office		
U. S. G. S.	<u>1</u>	
Transporter		
File	<u>1</u>	<input checked="" type="checkbox"/>