

NEW MEXICO OIL CONSERVATION COMMISSION

Well Location and Acreage Dedication Plat

Section A.

Date February 19, 1958

Operator Magnolia Petroleum Company Lease 3472 Magnolia
 Well No. 2 Unit Letter _____ Section 25 Township 25N Range 17W NMPM
 Located 650 Feet From North Line, 1076 Feet From West Line
 County San Juan G. L. Elevation 6456 Dedicated Acreage 80 Acres
 Name of Producing Formation Lower Gallup Oil Pool Bisti

1. Is the Operator the only owner in the dedicated acreage outlined on the plat below?
 Yes _____ No _____
2. If the answer to question one is "no," have the interests of all the owners been consolidated by communitization agreement or otherwise? Yes _____ No _____. If answer is "yes," Type of Consolidation _____
3. If the answer to question two is "no," list all the owners and their respective interests below:

Owner

Land Description



Section B. N 89° 17' W - 39.94 Ch. (Call)

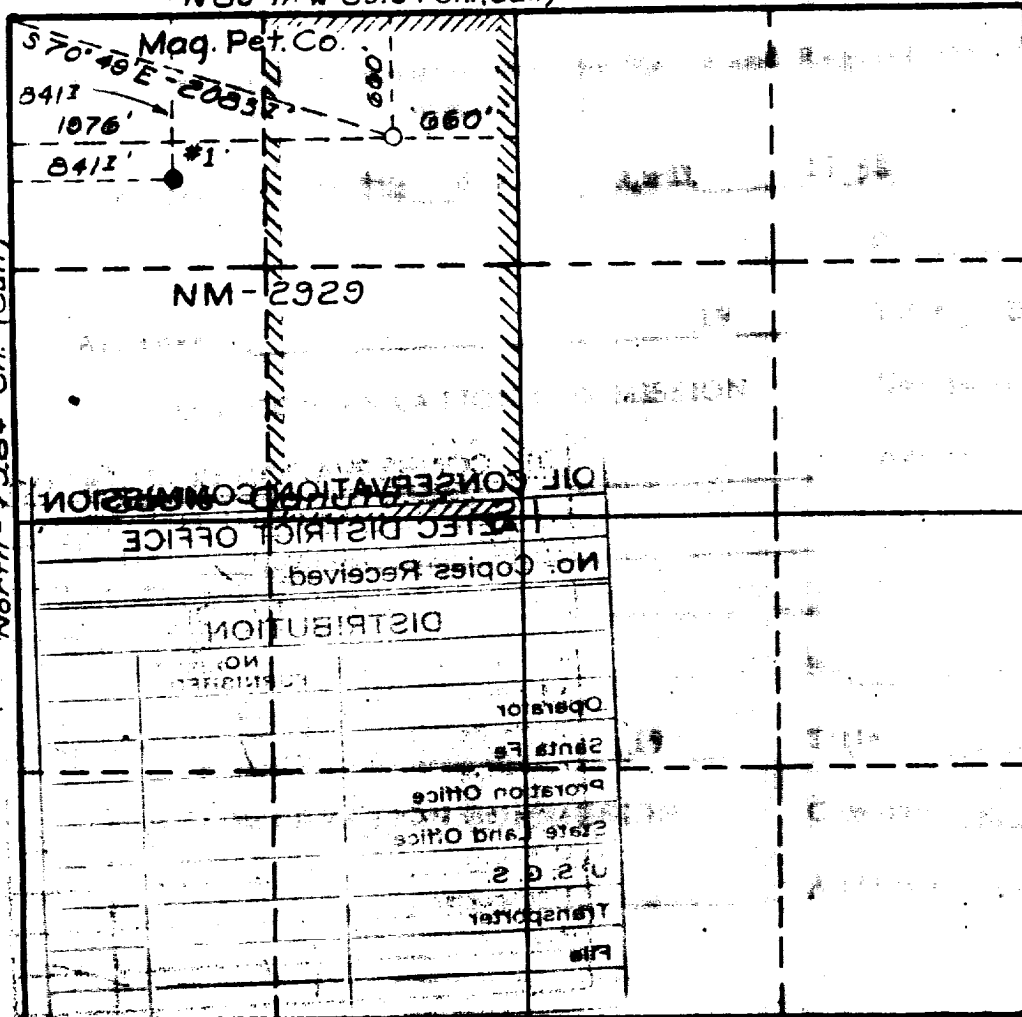

This is to certify that the information in Section A above is true and complete to the best of my knowledge and belief.

Magnolia Petroleum Company

(Operator)

[Signature]
(Representative)

Box 246, Hobbs, New Mexico
Address

This is to certify that the well location shown on the plat in Section B was plotted from field notes of actual surveys made by me or under my supervision and that the same is true and correct to the best of my knowledge and belief.

Date Surveyed Sept. 8, 1957

Carl E. Turner
Registered Professional Engineer and/or Land Surveyor.

Certificate No. 9160

[Faint, mostly illegible text, likely bleed-through from the reverse side of the page.]

[Faint, mostly illegible text on the left side of the page.]

OIL CONSERVATION COMMISSION		
AZTEC DISTRICT OFFICE		
No. Copies Received		6
DISTRIBUTION		
	NO. FURNISHED	
Operator	3	
Santa Fe	1	
Proration Office		
State Land Office		
U. S. G. S.	1	
Transporter		
File	1	✓