

NEW MEXICO OIL CONSERVATION COMMISSION
Well Location and Acreage Dedication Plat

Section A.

Date January 29, 1958

Operator Sun Oil Company Lease Hirsch Haas-pah (Indian #4-80-603-1310)
Well No. 2 Unit Letter B Section 22 Township 23N Range 11W NMPM
Located 660 Feet From North Line, 1924.7 Feet From East Line
County San Juan G. L. Elevation 6324.5 Dedicated Acreage 80 Acres
Name of Producing Formation Gallup ss Pool Hirsch - Lower Gallup

1. Is the Operator the only owner* in the dedicated acreage outlined on the plat below?
Yes No X.
2. If the answer to question one is "no," have the interests of all the owners been consolidated by communitization agreement or otherwise? Yes X No . If answer is "yes," Type of Consolidation Intercompany
3. If the answer to question two is "no," list all the owners and their respective interests below:

<u>Owner</u>	<u>Land Description</u>
<u>Sun Oil Company</u>	<u>5/8 of 80 acres outlined below</u>
<u>Anderson-Fritchard</u>	<u>2/8 of 80 acres outlined below</u>
<u>Arrowhead Exploration Co.</u>	<u>1/8 of 80 acres outlined below</u>

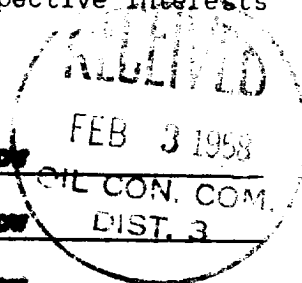

Section B

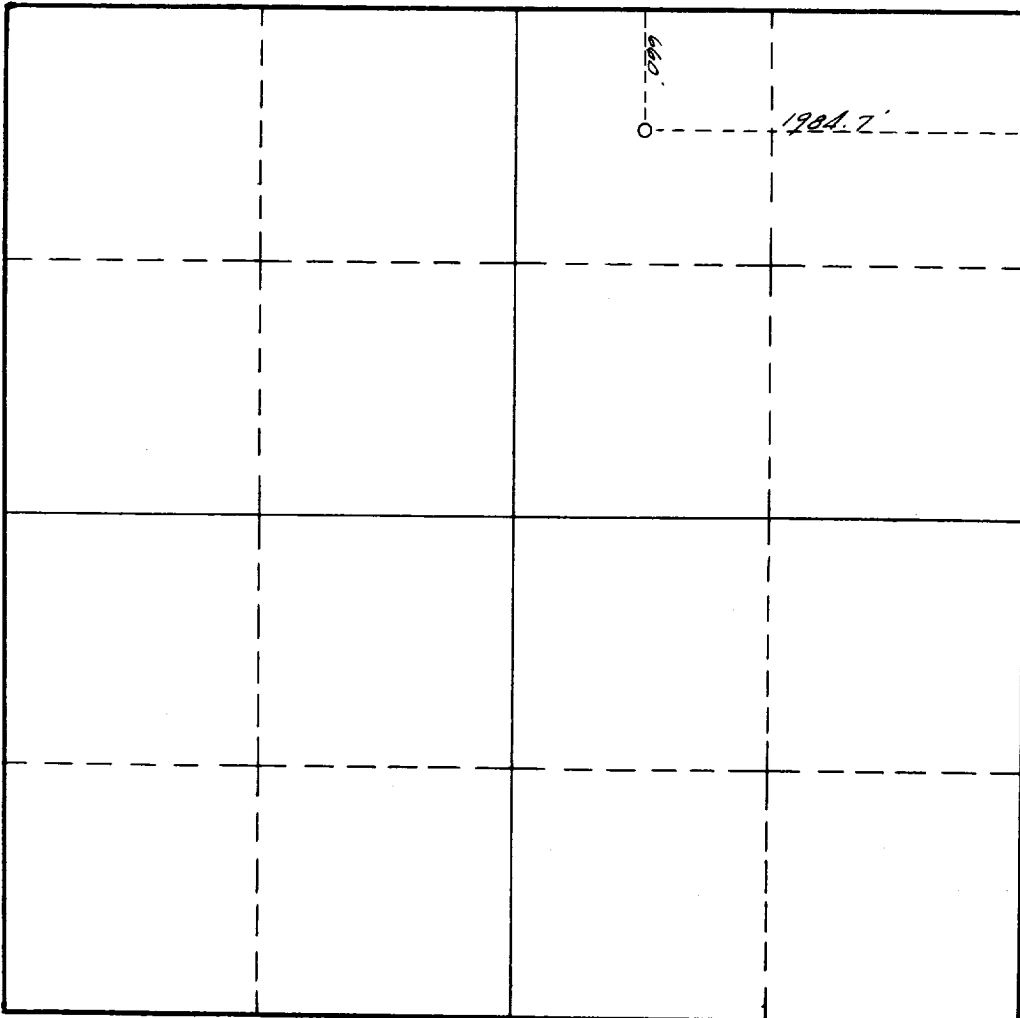

This is to certify that the information in Section A above is true and complete to the best of my knowledge and belief.

Sun Oil Company
(Operator)

[Signature]
(Representative)

P.O. Box 1798 - Denver 1, Colo.
Address

This is to certify that the well location shown on the plat in Section B was plotted from field notes of actual surveys made by me or under my supervision and that the same is true and correct to the best of my knowledge and belief.

Date Surveyed 6-25-57

[Signature]
Registered Professional
Engineer and/or Land Surveyor.

Certificate No. 3090 (New Mex.)

(See instructions for completing this form on the reverse side)

INSTRUCTIONS FOR COMPLETION:

1. Operator shall furnish and certify to the information called for in Section A.
2. Operator shall outline the dedicated acreage for both oil and gas wells on the plat in Section B.
3. A registered professional engineer or land surveyor registered in the State of New Mexico or approved by the Commission shall show on the plat the location of the well and certify this information in the space provided.
4. All distances shown on the plat must be from the outer boundaries of Section.
5. If additional space is needed for listing owners and their respective interests as required in question 3, Section A, please use space below

OIL CONSERVATION COMMISSION	
AZTEC DISTRICT OFFICE	
No. Copies Received	
DISTRIBUTION	
Mr. Tolson	
Mr. E. A. Tamm	
Mr. Clegg	
Mr. Glavin	
Mr. Ladd	
Mr. Nichols	
Mr. Rosen	
Mr. Tracy	
Mr. Carson	
Mr. Egan	
Mr. Gurnea	
Mr. Hendon	
Mr. Pennington	
Mr. Quinn	
Mr. Nease	
Mr. Gandy	
State	
U. S.	
Transporter	
File	

* "Owner" means the person who has the right to drill into and to produce from any pool and to appropriate the production either for himself or for himself and another. (65-3-29 (e) NMSA 1953 Comp.)