

NEW MEXICO OIL CONSERVATION COMMISSION
Santa Fe, New Mexico

NOTICE OF INTENTION TO DRILL OR RECOMPLETE

Notice must be given to the District Office of the Oil Conservation Commission and approval obtained before drilling or recompletion begins. If changes in the proposed plan are considered advisable, a copy of this notice showing such changes will be returned to the sender. Submit this notice in **QUINTUPLICATE**. One copy will be returned following approval. See additional instructions in Rules and Regulations of the Commission.

If State Land submit 6 Copies

Farmington, New Mexico

(Place)

April 23, 1956

(Date)

OIL CONSERVATION COMMISSION
SANTA FE, NEW MEXICO

Gentlemen:

You are hereby notified that it is our intention to commence the (Drilling) (~~Recompletion~~) of a well to be known as

El Paso Natural Gas Company

(Company or Operator)

Kelly State

(Lease)

, Well No. **7**, in **M** (Unit) The well is

located **660** feet from the **South** line and **460** feet from the **West** line of Section **16**, T. **25N**, R. **12W**, NMPM.

(GIVE LOCATION FROM SECTION LINE) **Wildcat** Pool, **San Juan** County

If State Land the Oil and Gas Lease is No. **E-6597**

If patented land the owner is

Address

We propose to drill well with drilling equipment as follows: **Rotary tools from surface to T.D. using mud circulation.**

The status of plugging bond is **Statewide**

Drilling Contractor **Company tools**

We intend to complete this well in the **Gallup** formation at an approximate depth of **4870** feet.

CASING PROGRAM

We propose to use the following strings of Casing and to cement them as indicated:

Size of Hole	Size of Casing	Weight per Foot	New or Second Hand	Depth	Sacks Cement
13 3/4"	9 5/8"	25.4#	New	170'	125
8 3/4"	5 1/2"	15.50#	New	4870'	250

If changes in the above plans become advisable we will notify you immediately.

ADDITIONAL INFORMATION (If recompletion give full details of proposed plan of work.) **All possible productive zones in the Gallup formation will be perforated and sandoil fractured. (SSSW) E-6597.**

Approved **4-24-56**, 19 **56**
Except as follows:

Sincerely yours,

El Paso Natural Gas Company
(Company or Operator)

By **Charles M. Walker**

Position **Petroleum Engineer**
Send Communications regarding well to

Name **E. J. Coel**

Address **Box 997, Farmington, N.M.**

OIL CONSERVATION COMMISSION

By **Ernest C. Gentry**
Oil and Gas Inspector Dist #3

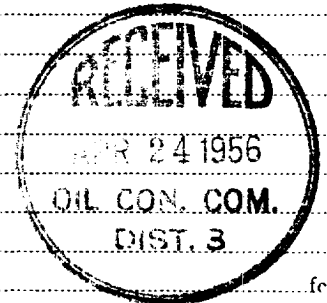

NEW MEXICO
OIL CONSERVATION COMMISSION

Form O-128

WELL LOCATION AND/OR GAS PRORATION PLAT

DATE APRIL 20, 1956

OPERATOR EL PASO NATURAL GAS COMPANY KELLY STATE E-6597

ACREAGE 7 16 25-N 12-W NORTH

660 SOUTH 460 WEST 100

SAN JUAN 6263

GALLUP WILDCAT 40

Note: All distances must be from outer boundaries of section.

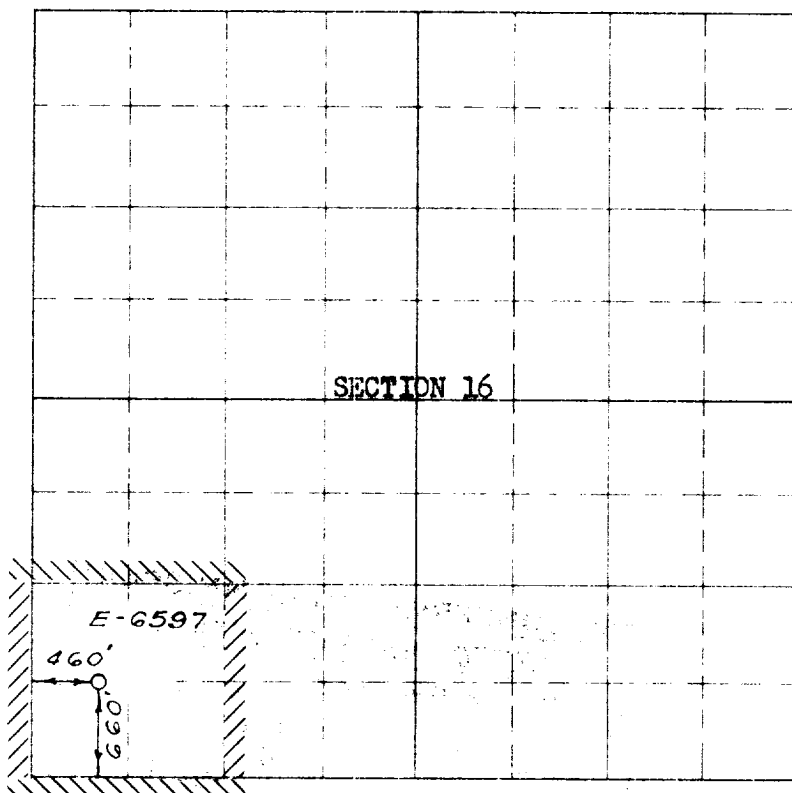

Scale 1 inch equals 1 mile



NOTE

This section of form is to be used for gas wells only

This is to certify that the above plat was prepared from field notes of actual surveys made by me or under my supervision and that the same are true and correct to the best of my knowledge and belief.

Date Surveyed MARCH 21, 1956

C. O. Walker
Registered Professional Engineer and/or Land Surveyor

1. Is this well a Dual Comp.

Yes _____ No X

2. If the answer to Question 1 is yes, are there any other dually completed wells within the dedicated acreage.

Yes _____ No _____

Name Twelfth Well

Position petroleum Engineer

Representing El Paso Natural Gas Co.

Address Box 997, Farmington, N.M.

(Seal)

OIL CONSERVATION COMMISSION		
AZTEC DISTRICT OFFICE		
No. Copies Received <u>4</u>		
DISTRIBUTION		
	NO. FURNISHED	
Operator	1	
Santa Fe	1	
Proration Office	1	
State Land Office	2	
U. S. G. S.		
Transporter		✓
File	1	

10-10-1914