

	13	
X		

(SUBMIT IN TRIPLICATE)

UNITED STATES
DEPARTMENT OF THE INTERIOR
GEOLOGICAL SURVEY

Land Office Santa Fe, N.M.
Lease No. SF078064
Unit Carson

SUNDRY NOTICES AND REPORTS ON WELLS

NOTICE OF INTENTION TO DRILL	<input checked="" type="checkbox"/>	SUBSEQUENT REPORT OF WATER SHUT-OFF	
NOTICE OF INTENTION TO CHANGE PLANS		SUBSEQUENT REPORT OF SHOOTING OR ACIDIZING	
NOTICE OF INTENTION TO TEST WATER SHUT-OFF		SUBSEQUENT REPORT OF ALTERING CASING	
NOTICE OF INTENTION TO RE-DRILL OR REPAIR WELL		SUBSEQUENT REPORT OF RE-DRILLING OR REPAIR	
NOTICE OF INTENTION TO SHOOT OR ACIDIZE		SUBSEQUENT REPORT OF ABANDONMENT	
NOTICE OF INTENTION TO PULL OR ALTER CASING		SUPPLEMENTARY WELL HISTORY	APR 6 1957
NOTICE OF INTENTION TO ABANDON WELL			

(INDICATE ABOVE BY CHECK MARK NATURE OF REPORT, NOTICE, OR OTHER DATA)

April 1, 1957

Well No. Carson Unit
14-13 is located 660 ft. from [N] line and 660 ft. from [E] line of sec. 13
SW SW 13 25N 12W NMN
($\frac{1}{4}$ Sec. and Sec. No.) (Twp.) (Range) (Meridian)
San Juan New Mexico
(Field) (County or Subdivision) (State or Territory)

The elevation of the ~~derrick floor~~ above sea level is 6405 ft. (Approx. ground)

DETAILS OF WORK

(State names of and expected depths to objective sands; show sizes, weights, and lengths of proposed casings; indicate mudding jobs, cementing points, and all other important proposed work)

1. Drill 12 1/4" hole to 200' \pm .
2. Run and cement 8 5/8" casing at 200' \pm with 100 sacks construction cement.
3. Drill 7 7/8" hole to 5040' (casing)
4. A supplementary notice will be issued prior to completion.

Surface Formation is upper cretaceous.



I understand that this plan of work must receive approval in writing by the Geological Survey before operations may be commenced.

Company SHELL OIL COMPANY
Address 108 North Behrend
Farmington, New Mexico
By B. E. Shepard
Title Exploitation Engineer



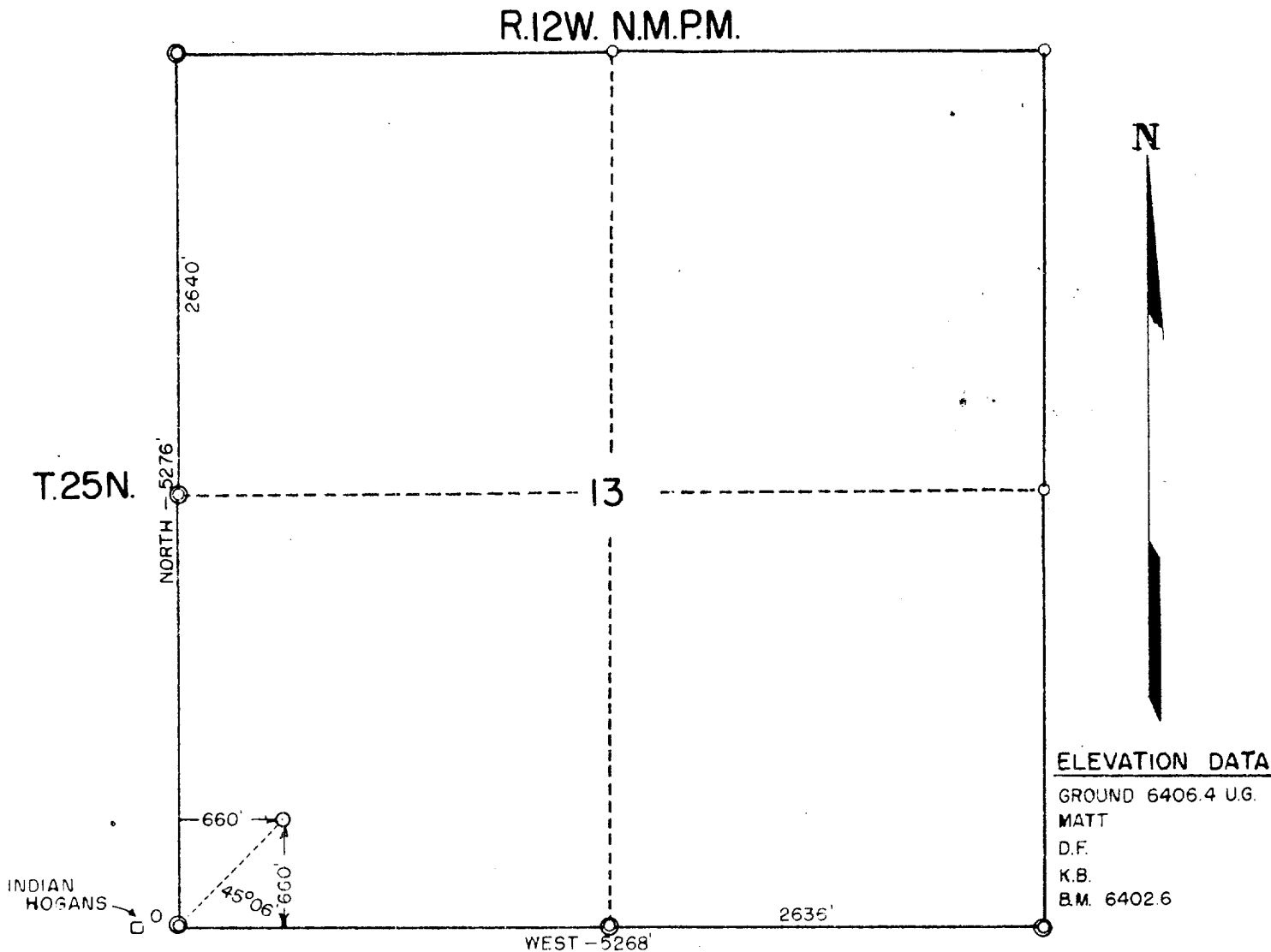

REFERENCE POINT DATUM--

1"x2" STAKES SET AT 10' N., S., E., & W. OF LOC.

© = G.L.O. BRASS CAP FOUND

1"x2" hubs & 3' flag set at 150' N., S., E., & W. of Loc.

1"x2" hub & 8' flag set at Loc. being 660' N. & 660' E.

of the SW cor. of Sec. 13, T.25N., R.12W., N.M.P.M.

An Indian Hogan bears S.50°23'W. - 992' from Loc.

" " " S.52°10'W. - 1076' " "

1"x2" hub and 3' flag bears N.45°W. a distance of 362' from the Loc. for B.M.

This is to certify that the above plat was prepared from field notes of an actual survey made by me on March 31, 1957, and that the same is true and correct to the best of my knowledge and belief.

April 2, 1957

John A. Kroeger
John A. Kroeger-Reg. U.S. N.M. Reg. No. 1941

Drawn By: A.C.T.

Checked By: *JAK*

Date: 4-1-57

SHELL OIL COMPANY

Scale 1" = 1000'

LOCATION OF CARSON UNIT 14-13

SAN JUAN COUNTY, N.M., SEC. 13, T.25N., R.12W., N.M.P.M.