

NUMBER OF COPIES RECEIVED		DISTRIBUTION	
SANTA FE	1	FILE	1
FILE	1	U.S.G.S.	1
LAND OFFICE	1	LAND OFFICE	1
TRANSPORTER	1	OIL	1
PRORATION OFFICE	1	GAS	1
OPERATOR	1		

**NEW MEXICO OIL CONSERVATION COMMISSION**  
**Santa Fe, New Mexico**

Form C-101  
Revised (12/1/55)

**NOTICE OF INTENTION TO DRILL**

Notice must be given to the District Office of the Oil Conservation Commission and approval obtained before drilling or recompletion begins. If changes in the proposed plan are considered advisable, a copy of this notice showing such changes will be returned to the sender. Submit this notice in QUINTUPLICATE. One copy will be returned following approval. See additional instructions in Rules and Regulations of the Commission. If State Land submit 6 Copies Attach Form C-128 in triplicate to first 3 copies of form C-101

Monahans, Texas  
(Please)

October 15, 1962  
(Date)

OIL CONSERVATION COMMISSION  
SANTA FE, NEW MEXICO

Gentlemen:

You are hereby notified that it is our intention to commence the Drilling of a well to be known as  
Standard Oil Company of Texas, A Division of California Oil Company  
(Company or Operator)

State E-7698  
(Lease)

Well No. 1, in N (Unit) The well is

located 660 feet from the South line and 1979 feet from the West line of Section 16, T. 25N, R. 18W, NMPM.

(GIVE LOCATION FROM SECTION LINE) Undesignated Pool, San Juan County

660' FSL, 1979' FSL

D	C	B	A
E	F	G	H
L	K	J	I
M	N	O	P

If State Land the Oil and Gas Lease is No. E6597-2

If patented land the owner is.....

Address.....

We propose to drill well with drilling equipment as follows: Rotary Tools

The status of plugging bond is..... Blanket

Drilling Contractor Unknown at present time.

We intend to complete this well in the (Gallup) Navajo formation at an approximate depth of 4800' feet.

**CASING PROGRAM**

We propose to use the following strings of Casing and to cement them as indicated:

Size of Hole	Size of Casing	Weight per Foot	New or Second Hand	Depth	Sacks Cement
<u>11"</u>	<u>8-5/8"</u>	<u>26#</u>	<u>New</u>	<u>200</u>	<u>To Surface</u>
<u>7-7/8"</u>	<u>4 1/2"</u>	<u>9.5#</u>	<u>New</u>	<u>4900</u>	<u>150</u>

If changes in the above plans become advisable we will notify you immediately.

ADDITIONAL INFORMATION (If recompletion give full details of proposed plan of work.)

Approved.....  
Except as follows:

10-18, 19 62

Sincerely yours,  
Standard Oil Company of Texas, A  
Division of California Oil Company  
(Company or Operator)

By J. L. Rowland

Position District Engineer

Send Communications regarding well to  
Standard Oil Company of Texas, A  
Name Division of California Oil Company

Address Drawer "B", Monahans, Texas

OIL CONSERVATION COMMISSION

By.....

1914

1914

1914

1914

1914

1914

1914

1914

1914

## NEW MEXICO OIL CONSERVATION COMMISSION

## Well Location and Acreage Dedication Plat

October 17, 1962

Section A.

Date

Operator STANDARD OIL COMPANY OF TEXAS Lease State E-7698  
 Well No. 1 Unit Letter N Section 16 Township 25 NORTH Range 13 WEST NMPM  
 Located 660 Feet From the SOUTH Line, 1979 Feet From the WEST Line  
 County SAN JUAN G. L. Elevation 6273.6' Dedicated Acreage 40 Acres  
 Name of Producing Formation Gallup Pool Wildcat

1. Is the Operator the only owner in the dedicated acreage outlined on the plat below?  
 Yes X No \_\_\_\_\_
2. If the answer to question one is "no", have the interests of all the owners been consolidated by communitization agreement or otherwise? Yes \_\_\_\_\_ No \_\_\_\_\_. If answer is "yes", Type of Consolidation.
3. If the answer to question two is "no", list all the owners and their respective interests below:

Owner

Land Description

Section B.

Note: All distances must be from outer boundaries of section.

This is to certify that the information in Section A above is true and complete to the best of my knowledge and belief.  
Standard Oil Co. of Texas, a div. of California Oil Company

*[Signature]*  
E.C. Hain

(Representative)  
Box 1979

(Address)  
Farmington, N.M.

Ref: GLO plat dated 19 July 1915

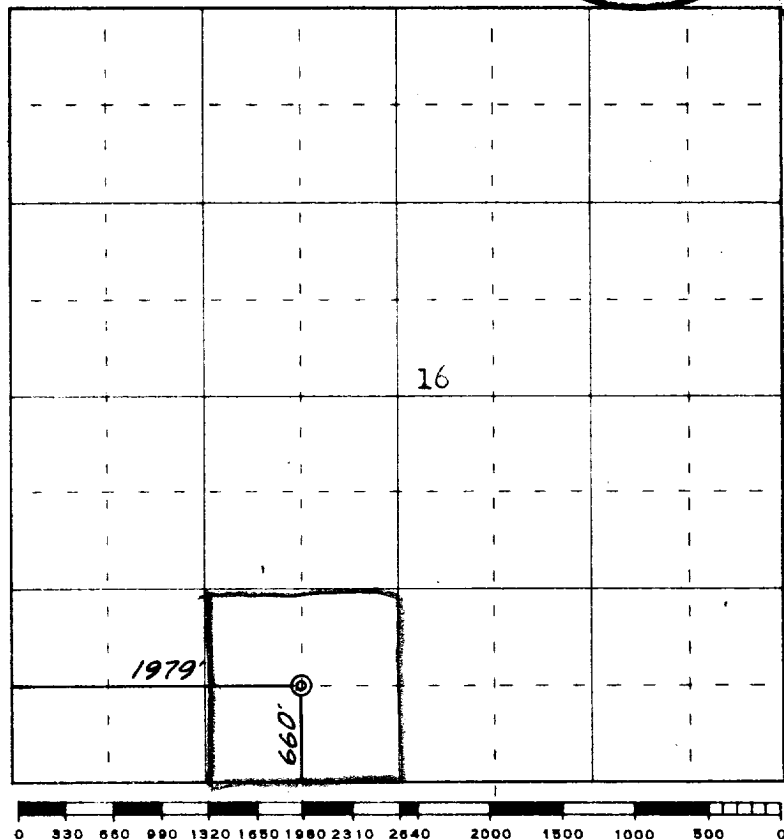

Scale 4 inches equal 1 mile

This is to certify that the above plat was prepared from field notes of actual surveys made by me or under my supervision and that the same are true and correct to the best of my knowledge and belief.

(Seal)

Date Surveyed 13 October 1962

*[Signature]*  
 Registered Professional Engineer and/or Land Surveyor  
James P. Lease, N. Max. Reg. No. 1463  
 San Juan Engineering Company

Farmington, New Mexico