

NEW MEXICO OIL CONSERVATION COMMISSION
Santa Fe, New Mexico

NOTICE OF INTENTION TO DRILL OR RECOMPLETE

Notice must be given to the District Office of the Oil Conservation Commission and approval obtained before drilling or recompletion begins. If changes in the proposed plan are considered advisable, a copy of this notice showing such changes will be returned to the sender. Submit this notice in **QUINTUPLICATE**. One copy will be returned following approval. See additional instructions in Rules and Regulations of the Commission. **If State Land submit 6 Copies**

Farmington, New Mexico

(Place)

May 8, 1956

(Date)

OIL CONSERVATION COMMISSION
 SANTA FE, NEW MEXICO

Gentlemen:

You are hereby notified that it is our intention to commence the (Drilling) (~~Recompletion~~) of a well to be known as

El Paso Natural Gas Company

(Company or Operator)

Kelly State

(Lease)

Well No. **8**, in **0** (Unit) The well is

located **760** feet from the **South** line and **1980** feet from the

East

line of Section **16**, T. **25N**, R. **12W**, NMPM.

(GIVE LOCATION FROM SECTION LINE) **Wildcat** Pool, **San Juan** County

If State Land the Oil and Gas Lease is No. **E-6597**

If patented land the owner is

Address

We propose to drill well with drilling equipment as follows: **Rotary tools from surface to T.D. using mud circulation.**

The status of plugging bond is **Statewide**

Drilling Contractor **Company tool**

We intend to complete this well in the **Gallup** formation at an approximate depth of **4873** feet.

CASING PROGRAM

We propose to use the following strings of Casing and to cement them as indicated:

Size of Hole	Size of Casing	Weight per Foot	New or Second Hand	Depth	Sacks Cement
13 3/4"	9 5/8"	25.4⁴	New	170'	125
8 3/4"	5 1/2"	15.50⁴	New	4873'	250

If changes in the above plans become advisable we will notify you immediately.

ADDITIONAL INFORMATION (If recompletion give full details of proposed plan of work.) All possible productive zones in the Gallup formation will be perforated and sand-oil fractured. (SWSE) E-6597.

Approved *May 8, 1956*, 19
 Except as follows:

OIL CONSERVATION COMMISSION

By *[Signature]*
 PETROLEUM ENGINEER DIST. NO. 3

Sincerely yours,

El Paso Natural Gas Company
 (Company or Operator)

By *[Signature]*

Position **Petroleum Engineer**
 Send Communications regarding well to

Name **E. J. Coel**

Address **Box 997, Farmington, N.M.**



OIL CONSERVATION COMMISSION
AZTEC DISTRICT OFFICE

No. Copies Received 6

DISTRIBUTION:

	NO. COPIES	
Operator	1	
Santa Fe	1	
Operation Office		
State Lead Office	1	
U. S. G. S.	2	
Transporter		
File	1	✓

NEW MEXICO
OIL CONSERVATION COMMISSION

Form O-127

WELL LOCATION AND/OR GAS PRODUCTION PLAT

DATE APRIL 25, 1956

OWNER EL PASO NATURAL GAS COMPANY STATE KELLY STATE WELL NO. E-6597

SECTION 8 TOWNSHIP 16 RANGE 25-N MERIDIAN 12-W

COUNTY 760 BEARING SOUTH DISTANCE 1980 BEARING EAST DISTANCE

SAN JUAN BEARING 6250

NEAREST TOWN GALLUP NEAREST RAILROAD WILDCAT NEAREST HIGHWAY 40

Note: All distances measured from center boundary of section.

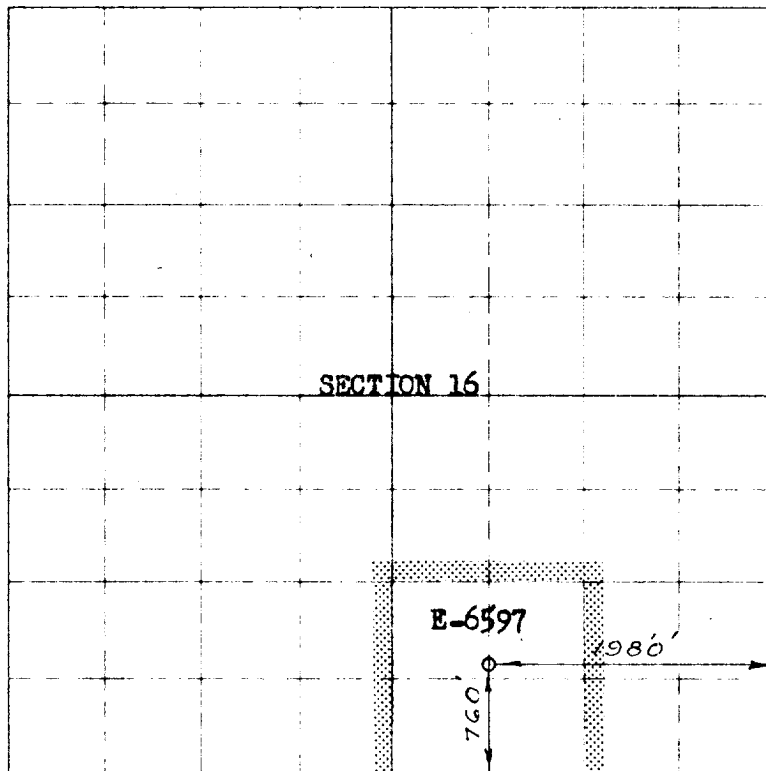

Scale: 1 inch = 400 feet



NOTE

This section of form is to be used for gas wells only.

This is to certify that the above plat was prepared from field notes of actual surveys made by me or under my supervision and that the same are true and correct to the best of my knowledge and belief.

Date Surveyed MARCH 22, 1956

E. O. Walker
Registered Professional Engineer and ☒ Land Surveyor

1. Is this well a Dual Comp?

Yes _____ No ☒

2. If the answer to Question 1 is yes, are there any other landly completed wells within the dedicated acreage.

Yes _____ No _____

Name D. C. Johnston

Position Petroleum Engineer

representing El Paso Natural Gas Co.

Address Box 997, Farmington, N.M.

Scale:

Farmington, New Mexico

OIL CONSERVATION COMMISSION		
AZTEC DISTRICT OFFICE		
No. Copies Received <u>5</u>		
DISTRIBUTION		
	1	
Director	1	
Assistant	1	
Executive Office		
State Land Office	1	
U. S. G. S.	1	
Traffic Officer		
File	1	✓