

(SUBMIT IN TRIPLICATE)

UNITED STATES
DEPARTMENT OF THE INTERIOR
GEOLOGICAL SURVEY

Land Office Santa Fe, N.M.

Lease No. SP 78064

Unit Carson Unit

SUNDRY NOTICES AND REPORTS ON WELLS

NOTICE OF INTENTION TO DRILL	<input checked="" type="checkbox"/>	SUBSEQUENT REPORT OF WATER SHUT-OFF	
NOTICE OF INTENTION TO CHANGE PLANS		SUBSEQUENT REPORT OF SHOOTING OR ACIDIZING	
NOTICE OF INTENTION TO TEST WATER SHUT-OFF		SUBSEQUENT REPORT OF ALTERING CASING	
NOTICE OF INTENTION TO RE-DRILL OR REPAIR WELL		SUBSEQUENT REPORT OF RE-DRILLING OR REPAIR	
NOTICE OF INTENTION TO SHOOT OR ACIDIZE		SUBSEQUENT REPORT OF ABANDONMENT	
NOTICE OF INTENTION TO PULL OR ALTER CASING		SUPPLEMENTARY WELL HISTORY	
NOTICE OF INTENTION TO ABANDON WELL			

JUN 5 1959
GEOLOGICAL SURVEY
NEW MEX.

(INDICATE ABOVE BY CHECK MARK NATURE OF REPORT, NOTICE, OR OTHER DATA)

June 5, 1959

Carson Unit
Well No. 44-13 is located 735 ft. from 13 line and 735 ft. from 13 line of sec. 13

13 25N 12E 13N
(1/4 Sec. and Sec. No.) (Twp.) (Range) (Meridian)

13 San Juan New Mexico
(Field) (County or Subdivision) (State or Territory)

The elevation of the ~~surface of the ground~~ is 413.4 ft. (approx. ground)

DETAILS OF WORK

(State names of and expected depths to objective sands; show sizes, weights, and lengths of proposed casings; indicate mudding jobs, cementing points, and all other important proposed work)

1. Drill 12-1/4" hole to 100'.
2. Cement 8-5/8", 24#, J-55 casing at 100' with 150 sacks construction cement. (Circulated)
3. Drill 7-7/8" hole to 5000' (objective - Gallup)
4. Cement 4-1/2", 9.5#, J-55 casing at 4975' with 150 sacks construction cement.
5. Perforate four 1/2" holes/ft. selected intervals 4900-5400'.
6. Spot 200 gal. acid; sand oil fracture with 50,000 gal. crude, 15/gal. acid.
7. Install pump, recover load and free oil, establish initial rate.

I understand that this plan of work must receive approval in writing by the Geological Survey before operations may be commenced.

Company Shell Oil Company

Address 705 West Municipal Drive

Barlington, New Mexico

Original signed by
B. W. SHEPARD

By B. W. Shepard

Title Exploitation Engineer

1

NEW MEXICO OIL CONSERVATION COMMISSION

Well Location and Acreage Dedication Plat

Section A.

Date **13, JANUARY 1958**

Carson Unit

Lease **E. W. Mudge #3**

SY 078064

Operator **SHELL OIL COMPANY**Well No. **44-13** Unit Letter **P** Section **13**Located **735** Feet From **THE SOUTH** Line, **735**Township **25 NORTH** Range **12 WEST** NMPMCounty **SAN JUAN** G. L. Elevation **6413.4**Feet From **THE EAST** LineName of Producing Formation **Callup**Dedicated Acreage **40** AcresPool **Bisti**

1. Is the Operator the only owner in the dedicated acreage outlined on the plat below?

Yes **X** No

2. If the answer to question one is "no", have the interests of all the owners been consolidated by communitization agreement or otherwise? Yes No If answer is "yes", Type of Consolidation.

3. If the answer to question two is "no", list all the owners and their respective interests below:

Owner

Land Deed

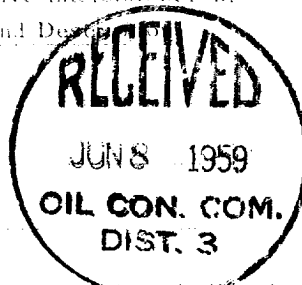

Section B.

Note: All distances must be from outer boundaries of section.

This is to certify that the information
in Section A above is true and complete
to the best of my knowledge and belief.

Shell Oil Company

(Operator)

Original signed by

B. W. SHEPARD

(Representative)

101 South Behrend AvenueAddress
Farmington, New Mexico

REF. GLO Plat dated, 19 July 1915
T.B.M. Iron pin 128' S 36 $\frac{1}{2}$ ° E of
Location. Elev. 6414.55

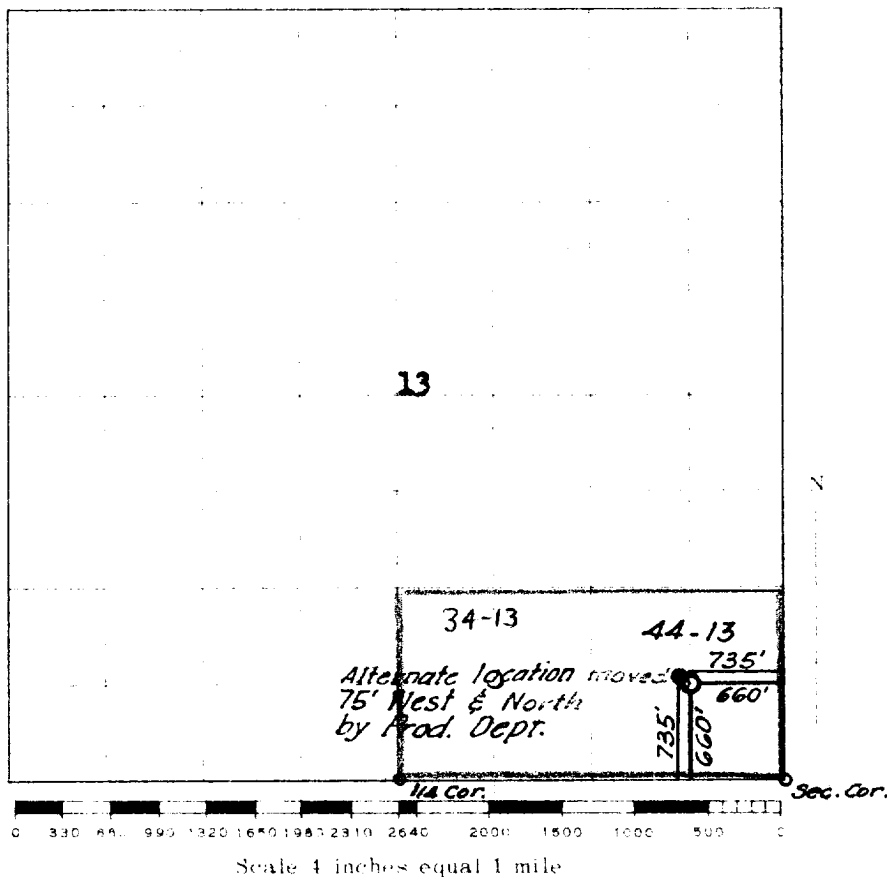

This is to certify that the above plat was prepared from field notes of actual surveys made by me or under my supervision and that the same are true and correct to the best of my knowledge and belief.

Date Surveyed **10 JANUARY 1958**

Registered Professional Engineer and/or Land Surveyor

JAMES P. LEESE NEW MEXICO REG. NO. 1463

220-180



Farmington, New Mexico
