

Form 9-331a
(Feb. 1961)

(SUBMIT IN TRIPLICATE)

UNITED STATES
DEPARTMENT OF THE INTERIOR
GEOLOGICAL SURVEY

Land Office Santa Fe, N. M.

Lease No. SP 078067

Unit Carson Unit

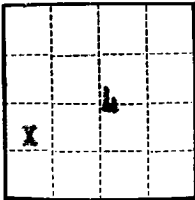

SUNDRY NOTICES AND REPORTS ON WELLS

NOTICE OF INTENTION TO DRILL	<input checked="" type="checkbox"/>	SUBSEQUENT REPORT OF WATER SHUT-OFF	RECEIVED SEP 17 1959 U.S. GEOLOGICAL SURVEY FARMINGTON NEW MEXICO
NOTICE OF INTENTION TO CHANGE PLANS		SUBSEQUENT REPORT OF SHOOTING OR ACIDIZING	
NOTICE OF INTENTION TO TEST WATER SHUT-OFF		SUBSEQUENT REPORT OF ALTERING CASING	
NOTICE OF INTENTION TO RE-DRILL OR REPAIR WELL		SUBSEQUENT REPORT OF RE-DRILLING OR REPAIR	
NOTICE OF INTENTION TO SHOOT OR ACIDIZE		SUBSEQUENT REPORT OF ABANDONMENT	
NOTICE OF INTENTION TO PULL OR ALTER CASING		SUPPLEMENTARY WELL HISTORY	
NOTICE OF INTENTION TO ABANDON WELL			

(INDICATE ABOVE BY CHECK MARK NATURE OF REPORT, NOTICE, OR OTHER DATA)

September 16, 1959

Carson Unit
Well No. 13-14 is located 1880 ft. from [S] line and 560 ft. from [W] line of sec. 14

14 (1/4 Sec. and Sec. No.) 25N (Twp.) 12W (Range) MDN (Meridian)
Dist 1 (Field) San Juan (County or Subdivision) New Mexico (State or Territory)

The elevation of ~~the land surface~~ is 6360 ft. (approx. ground)

DETAILS OF WORK

(State names of and expected depths to objective sands; show sizes, weights, and lengths of proposed casings; indicate mudding jobs, cementing points, and all other important proposed work)

Proposed Works:

1. Drill 12-1/4" hole to 100'±.
2. Cement 8-5/8", 2lb, J-55 casing at 100'± with 100 sacks cement (circulated).
3. Drill 7-7/8" hole to 1970'± (objective-Gallup).
4. Cement 4-1/2", 9.5, J-55 casing at 1965' with 150 sacks cement.
5. Perforate four 1/2" holes/ft. selected intervals between 1950-1950'±.
6. Spot 200 gallons mud acid, sand oil fracture with 50,000 gallons crude, 1#/gallon sand.
7. Recover load and frac oil, establish initial rate.

N-80

I understand that this plan of work must receive approval in writing by the Geological Survey before operations may be commenced.

Company Shell Oil Company

Address Post Office Box 198

Farmington, New Mexico

Original signed by
B. W. SHEPARD

By B. W. Shepard

Title Exploitation Engineer

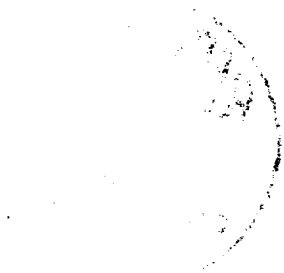

NEW MEXICO OIL CONSERVATION COMMISSION

Well Location and Acreage Dedication Plat

Section A.

September 14, 1959

Operator Shell Oil Company Lease Carson Unit
 Well No. 13-14 Unit Letter _____ Section 14 Township 25N Range 12W NMPM
 Located 1880 Feet From the south Line, 560' Feet From the west Line
 County San Juan G. L. Elevation 6260 Dedicated Acreage 40 Joint Acres 80
 Name of Producing Formation Gallup Pool Blst1

1. Is the Operator the only owner in the dedicated acreage outlined on the plat below?

Yes ☒ No _____

2. If the answer to question one is "no", have the interests of all the owners been consolidated by communitization agreement or otherwise? Yes _____ No _____. If answer is "yes", Type of Consolidation.

3. If the answer to question two is "no", list all the owners and their respective interests below:

Owner

Land Description



Section B.

Note: All distances must be from outer boundaries of section.

This is to certify that the information
 in Section A above is true and complete
 to the best of my knowledge and belief.

Shell Oil Company

(Operator) Signed by

E. W. SHEPARD

(Representative)

(Address)

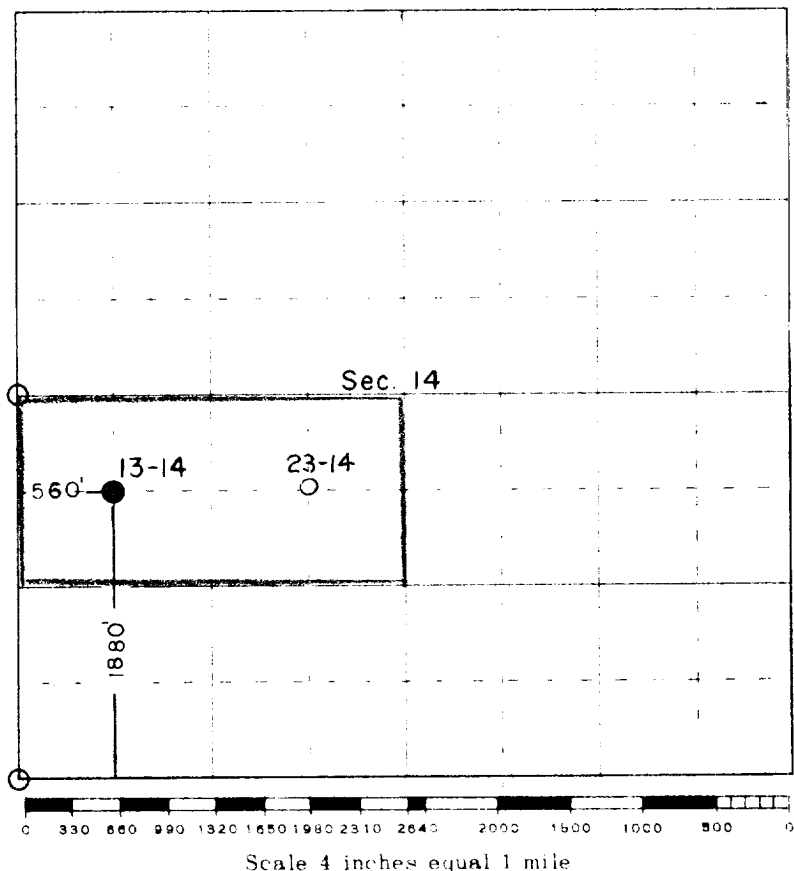
Post Office Box 158Farmington, New Mexico

This is to certify that the above plat was prepared from field notes of actual surveys
 made by me or under my supervision and that the same are true and correct to the best
 of my knowledge and belief.

Date Surveyed

Sept. 11, 1959

Blaine H. Fitzgerald L.S. #3184
 Registered Professional Engineer and/or Land Surveyor

720-012

Farmington, New Mexico

