

(SUBMIT IN TRIPLICATE)

Land Office Santa Fe, N.M.

Lease No. 036254

Unit _____

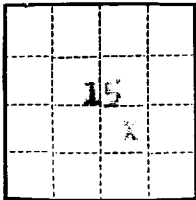

UNITED STATES
DEPARTMENT OF THE INTERIOR
GEOLOGICAL SURVEY

SUNDRY NOTICES AND REPORTS ON WELLS

RECEIVED
NOV 14 1959
U. S. GEOLOGICAL SURVEY
FARMINGTON, NEW MEXICO

NOTICE OF INTENTION TO DRILL	<input checked="" type="checkbox"/>	SUBSEQUENT REPORT OF WATER SHUT-OFF
NOTICE OF INTENTION TO CHANGE PLANS	<input type="checkbox"/>	SUBSEQUENT REPORT OF SHOOTING OR ACIDIZING
NOTICE OF INTENTION TO TEST WATER SHUT-OFF	<input type="checkbox"/>	SUBSEQUENT REPORT OF ALTERING CASING
NOTICE OF INTENTION TO RE-DRILL OR REPAIR WELL	<input type="checkbox"/>	SUBSEQUENT REPORT OF RE-DRILLING OR REPAIR
NOTICE OF INTENTION TO SHOOT OR ACIDIZE	<input type="checkbox"/>	SUBSEQUENT REPORT OF ABANDONMENT
NOTICE OF INTENTION TO PULL OR ALTER CASING	<input type="checkbox"/>	SUPPLEMENTARY WELL HISTORY
NOTICE OF INTENTION TO ABANDON WELL	<input type="checkbox"/>	

(INDICATE ABOVE BY CHECK MARK NATURE OF REPORT, NOTICE, OR OTHER DATA)

Well No. 33-15 is located 1900 ft. from N line and 1000 ft. from W line of sec. 15
N 15 (1/4 Sec. and Sec. No.) 25 N (Twp.) 12 E (Range) WAVE (Meridian)
Dist 1 (Field) San Juan (County or Subdivision) New Mexico (State or Territory)

The elevation of the derrick floor above sea level is 6225 ft. (approx. ground)

DETAILS OF WORK

(State names of and expected depths to objective sands; show sizes, weights, and lengths of proposed casings; indicate mudding jobs, cementing points, and all other important proposed work)

Proposed Work:

1. Drill 12-1/4" hole to 100'±.
2. Cement 8-5/8", 24#, J-55 casing at 100' with 50 sacks cement (circulated).
3. Drill 7-7/8" hole to 4050'±. (objective - Gallup).
4. Cement 4-1/2", 9.5#, J-55 casing at 4050' with 150 sacks cement.
5. Perforate four 1/2" holes/ft. selected intervals between 4750-4820'.
6. Sand oil fracture with 50,000 gal. crude 18/gal. sand.
7. Recover load and free oil, establish initial rate.

I understand that this plan of work must receive approval in writing by the Geological Survey before operations may be commenced.

Company Shell Oil Company

Address P.O. Box 158

Farmington, New Mexico

Original signed by
D. W. SHEPARD

By _____

B. A. Shepard

Title Exploitation Engineer

NEW MEXICO OIL CONSERVATION COMMISSION

Well Location and Acreage Dedication Plat

Section A.

Date November 13, 1959

Operator SHELL OIL COMPANYLease L. M. Phillips #2 NM 036254Well No. 33-15 Unit Letter J Section 15 Township 25 NORTH Range 12 WEST NMPMLocated 1980 Feet From the SOUTH Line, 1980 Feet From the EAST LineCounty SAN JUAN G. L. Elevation 6225.4 Dedicated Acreage 40 (80 JOINT) AcresName of Producing Formation Gallup Pool Bist1

1. Is the Operator the only owner in the dedicated acreage outlined on the plat below?

Yes ☒ No ☐2. If the answer to question one is "no", have the interests of all the owners been consolidated by communitization agreement or otherwise? Yes ☐ No ☐ If answer is "yes", Type of Consolidation.

3. If the answer to question two is "no", list all the owners and their respective interests below:

Owner

Land Description

Section B.

Note: All distances must be from outer boundaries of section.

This is to certify that the information in Section A above is true and complete to the best of my knowledge and belief.

Shell Oil Company

(Operator)
Original signed by
B. W. SHEPARD
(Representative)

(Address)

Post Office- Box 158

Formington, New Mexico

TBM: 1x2" STAKE 385' NORTH
OF LOC.: ELEV. 6222.36

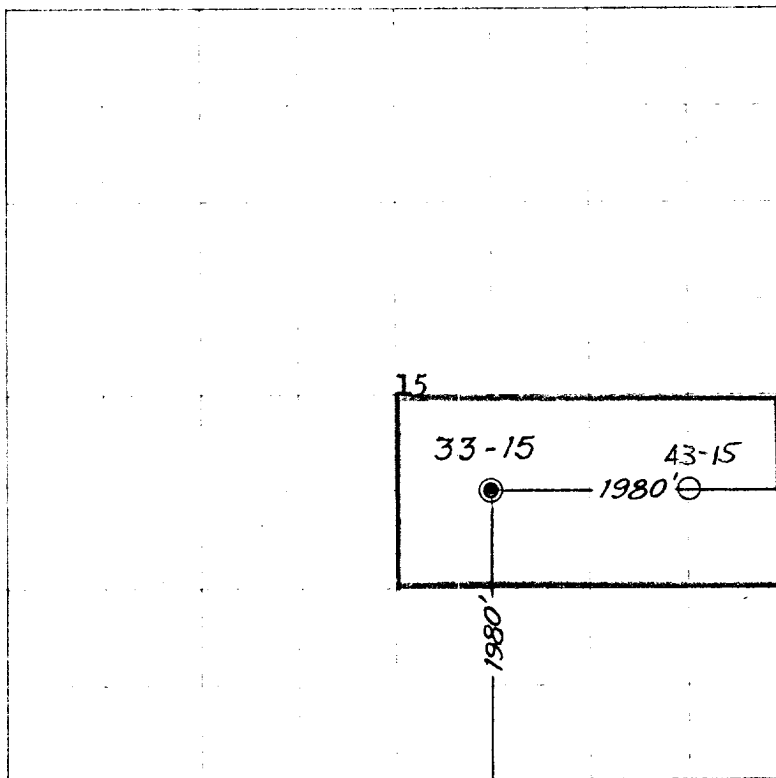

0 330 660 990 1320 1650 1980 2310 2640 2000 1500 1000 500 0

Scale 4 inches equal 1 mile

This is to certify that the above plat was prepared from field notes of actual surveys made by me or under my supervision and that the same are true and correct to the best of my knowledge and belief.

Date Surveyed 22 AUGUST 1957

James P. Lense
Registered Professional Engineer and/or Land Surveyor
James P. Lense N. Mex. Reg. No. 1463

