

(SUBMIT IN TRIPLICATE)

Indian Agency Navajo

UNITED STATES  
DEPARTMENT OF THE INTERIOR  
GEOLOGICAL SURVEY

Allottee Tribal

Lease No. 14-20-603-1263

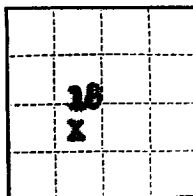

SUNDRY NOTICES AND REPORTS ON WELLS

NOTICE OF INTENTION TO DRILL	<input checked="" type="checkbox"/>	SUBSEQUENT REPORT OF WATER SHUT-OFF	
NOTICE OF INTENTION TO CHANGE PLANS		SUBSEQUENT REPORT OF SHOOTING OR ACIDIZING	
NOTICE OF INTENTION TO TEST WATER SHUT-OFF		SUBSEQUENT REPORT OF ALTERING CASING	
NOTICE OF INTENTION TO REDRILL OR REPAIR WELL		SUBSEQUENT REPORT OF REDRILLING OR REPAIR	
NOTICE OF INTENTION TO SHOOT OR ACIDIZE		SUBSEQUENT REPORT OF ABANDONMENT	
NOTICE OF INTENTION TO PULL OR ALTER CASING		SUPPLEMENTARY WELL HISTORY	
NOTICE OF INTENTION TO ABANDON WELL			

(INDICATE ABOVE BY CHECK MARK NATURE OF REPORT, NOTICE, OR OTHER DATA)

December 30, 1957

Well No. 23-16 is located 1980 ft. from XX line and 1984 ft. from XX line of sec. 18  
SW 18 29N 11W N.M.P.M.  
(1/4 Sec. and Sec. No.) (Twp.) (Range) (Meridian)  
Rio San Juan New Mexico  
(Field) (County or Subdivision) (State or Territory)

The elevation 6988 ft.

DETAILS OF WORK

(State names of and expected depths to objective sands; show sizes, weights, and lengths of proposed casings; indicate mudding jobs, cementing points, and all other important proposed work)

Proposed Work:

1. Drill 12-1/4" hole to 100'.
2. Cement 6-5/8" casing at 100' with 50 sacks treated cement.
3. Drill 7-7/8" hole to 5005'.
4. Cement 4-1/2" casing at 5005' with 150 sacks construction cement.
5. Clean out to 4985'.
6. Perforate four 1/2" holes/ft. in intervals determined by logs.
7. Sand-oil fracture with 50,000 gal. crude oil and 1/2 gal. sand.
8. Swab well in, make production test and establish rate.

I understand that this plan of work must receive approval in writing by the Geological Survey before operations may be commenced.

Company Shell Oil Company  
Address 101 South Deland Avenue  
Farmington, New Mexico

Original signed by  
B. W. SHEPARD  
By B. W. Shepard  
Title Exploitation Engineer

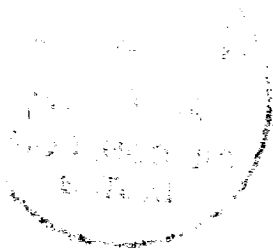

Original in  
New York

## NEW MEXICO OIL CONSERVATION COMMISSION

## Well Location and Acreage Dedication Plat

Section A.

Date December 5, 1957

Operator Shell Oil Company Lease Allotted 14-20-603-1283  
 Well No. 23-18 Unit Letter K Section 18 Township 25N Range 11W NMPM  
 Located 1980 Feet From S Line, 1888' Feet From W Line  
 County San Juan G. L. Elevation \_\_\_\_\_ Dedicated Acreage 40 80.50 Acres  
 Name of Producing Formation Gallup Pool Bisti

1. Is the Operator the only owner in the dedicated acreage outlined on the plat below?

Yes \_\_\_\_\_ No X2. If the answer to question one is "no", have the interests of all the owners been consolidated by communitization agreement or otherwise? Yes X No \_\_\_\_ If answer is "yes", Type of Consolidation.Carson Unit

3. If the answer to question two is "no", list all the owners and their respective interests below:

Owner

Land Description

Section B.

This is to certify that the information  
 in Section A above is true and complete  
 to the best of my knowledge and belief.

Shell Oil Company

(Operator)

B W Shepard

(Representative)

101 South Behrend Avenue

(Address)

Farmington, New Mexico

Note: All distances must be from outer boundaries of section.

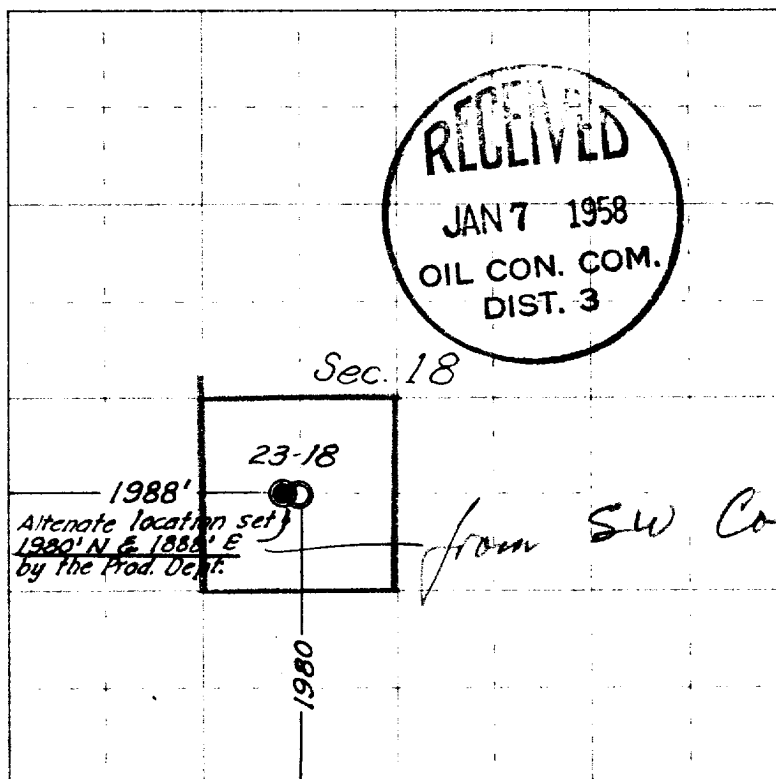

0 330 660 990 1320 1650 1980 2310 2640 2000 1500 1000 500 0

Scale 1 inch equals 1 mile

This is to certify that the above plat was prepared from field notes of actual surveys made by me or under my supervision and that the same are true and correct to the best of my knowledge and belief.

Date Surveyed Nov 27 1957

Jack Baker LS #2452  
 Registered Professional Engineer and/or Land Surveyor

Z 20-741

Farmington, New Mexico

## NEW MEXICO OIL CONSERVATION COMMISSION

## Well Location and Acreage Dedication Plat

Section A.

Date **December 5, 1957**Operator **Shell Oil Company**Lease **~~Admitted~~ 14-20-803-1283**Well No. **23-18** Unit Letter **K** Section **18**Located **1980** Feet From **S** Line, **1888'**Township **25N** Range **11W**County **San Juan** G. L. ElevationFeet From **W**Name of Producing Formation **Gallup**Dedicated Acreage **80.50**  
Pool **Bisti**

1. Is the Operator the only owner in the dedicated acreage outlined on the plat below?

Yes ☐ No ☒2. If the answer to question one is "no", have the interests of all the owners been consolidated by a written agreement or otherwise? Yes ☒ No ☐ If answer is "Yes", Type of Consolidation:**Carson Unit**

3. If the answer to question two is "no", list all the owners and their respective interests below.

Owner

Land Description

Section B.

Note: All distances must be from center to center of section.

This is to certify that the information in Section A above is true and complete to the best of my knowledge and belief.

**Shell Oil Company**

(Operator)

**B. W. Shepard**  
(Representative)**101 South Behrend Avenue**

(Address)

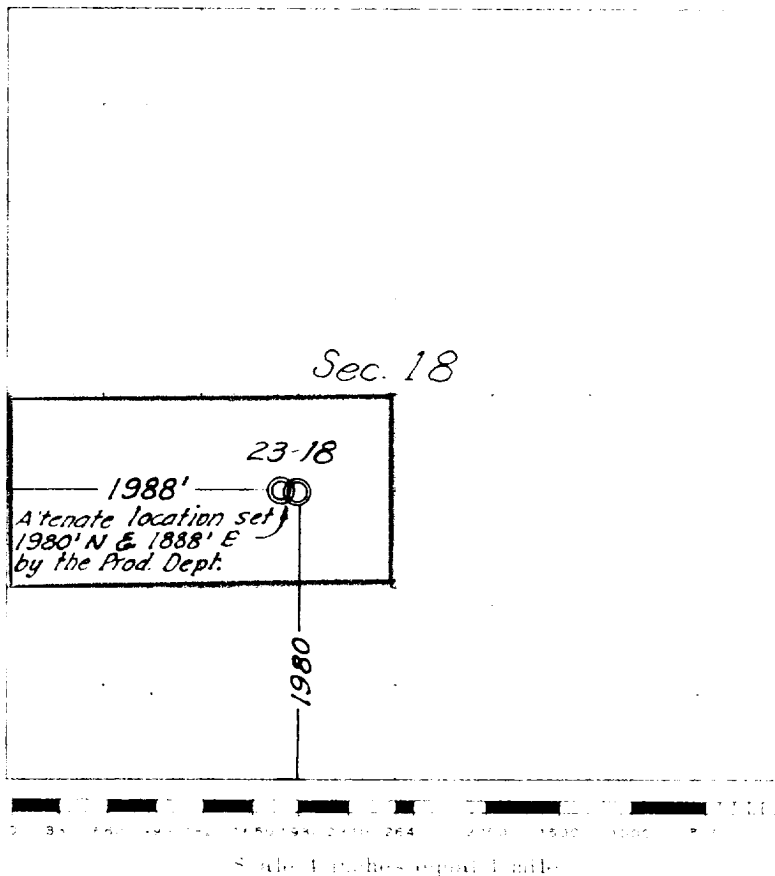
**Farmington, New Mexico**

This is to certify that the above plat was prepared from field notes and actual survey made by me or under my supervision and that the same are true and correct to the best of my knowledge and belief.

(Seal)

Date Surveyed

Registered Professional Engineer and/or Land Surveyor

Farmington, New Mexico

7-20-741

3-25-68

Shell Oil Company

WELLS REQUIRING FILE CORRECTION ONLY

LEASE NAME & WELL NUMBER	LOCATION	POOL	PRESENT ACREAGE	CORRECT ACREAGE
Carson Unit #3	L-7-25N-11W	Bisti Gallup	80 (N/2 SW/4)	80.11 ✓
Carson Unit #24-7	N-7-25N-11W	Bisti Gallup	80 (S/2 SW/4)	80.25 ✓
Carson Unit #21-18	C-18-25N-11W	Bisti Gallup	80 (N/2 NW/4)	80.35 ✓
Carson Unit #12-18	(E-18-25N-11W	Bisti Gallup	80 (S/2 NW/4)	80.42 ✓
Carson Unit #22-18	(F-18-25N-11W	Bisti Gallup	80 (S/2 NW/4)	80.42 ✓
Carson Unit #23-18	(K-18-25N-11W	Bisti Gallup	80 (N/2 SW/4)	80.50 ✓
Carson Unit #13-18	(L-18-25N-11W	Bisti Gallup	80 (N/2 SW/4)	80.50 ✓
Carson Unit #14-18	(M-18-25N-11W	Bisti Gallup	80 (S/2 SW/4)	80.57 ✓
Carson Unit #24-18	(N-18-25N-11W	Bisti Gallup	80 (S/2 SW/4)	80.57 ✓
Carson Unit #21-19	(C-19-25N-11W	Bisti Gallup	80 (N/2 NW/4)	80.56 ✓
Carson Unit #11-19	(D-19-25N-11W	Bisti Gallup	40 (N/2 NW/4)	80.56 ✓
Carson Unit #12-19	(E-19-25N-11W	Bisti Gallup	80 (S/2 NW/4)	80.47 ✓
Carson Unit #22-19	(F-19-25N-11W	Bisti Gallup	80 (S/2 NW/4)	80.47 ✓
Carson Unit #23-19	K-19-25N-11W	Bisti Gallup	80 (N/2 SW/4)	80.37 ✓
Carson Unit #11-30	D-30-25N-11W	Bisti Gallup	80 (N/2 NW/4)	80.25 ✓

Ch. 6  
with 6 acreage  
on Unit #2