

(SUBMIT IN TRIPLICATE)

Indian Agency Navajo

UNITED STATES
DEPARTMENT OF THE INTERIOR
GEOLOGICAL SURVEY

Allottee Allotted Lands

Lease No. 14-30-60-1284

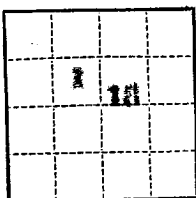

SUNDRY NOTICES AND REPORTS ON WELLS RECEIVED

NOTICE OF INTENTION TO DRILL	<input checked="" type="checkbox"/>	SUBSEQUENT REPORT OF WATER SHUT-OFF	
NOTICE OF INTENTION TO CHANGE PLANS		SUBSEQUENT REPORT OF SHOOTING OR ACIDIZING	JAN 6 1960
NOTICE OF INTENTION TO TEST WATER SHUT-OFF		SUBSEQUENT REPORT OF ALTERING CASING	
NOTICE OF INTENTION TO REDRILL OR REPAIR WELL		SUBSEQUENT REPORT OF REDRILLING OR REPAIRS	
NOTICE OF INTENTION TO SHOOT OR ACIDIZE		SUBSEQUENT REPORT OF ABANDONMENT	
NOTICE OF INTENTION TO PULL OR ALTER CASING		SUPPLEMENTARY WELL HISTORY	
NOTICE OF INTENTION TO ABANDON WELL			

(INDICATE ABOVE BY CHECK MARK NATURE OF REPORT, NOTICE, OR OTHER DATA)

December 31, 1959

Well No. 22-18 is located 1980 ft. from N line and 1380 ft. from W line of sec. 18
34 Sec. and Sec. No. 25N 11W 25N W
 (Field) (Twp.) (Range) (Meridian)
Dist San Juan New Mexico
 (County or Subdivision) (State or Territory)

The elevation of the derrick floor above sea level is 697 ft. (approx. ground)

DETAILS OF WORK

(State names of and expected depths to objective sands; show sizes, weights, and lengths of proposed casings; indicate mudding jobs, cementing points, and all other important proposed work)

1. Drill 12-1/4" hole to 100'
2. Run and cement 8-5/8", 24', J-53 casing at 100'± with 100 sacks cement (circulated)
3. Drill 7-7/8" hole to 5045'± (objective Gallup)
4. Run and cement 4-1/2", 9.5', J-55 casing at 5040'± with 150 sacks cement.
5. Perforate four 1/2" holes/ft. selected intervals between 4500' and 4600'.
6. Spot 200 gallons mud acid. Sand oil fracture with 50,000 gal. acid, 10 gal. sand.
7. Recover lost and free oil, establish initial production.

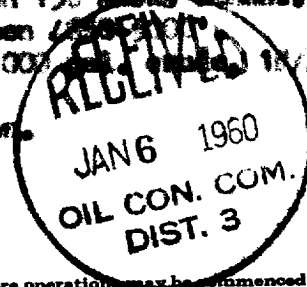

I understand that this plan of work must receive approval in writing by the Geological Survey before operations may be commenced.

Company Shell Oil Company

Address Post Office Box 198
Farmington, New Mexico

Original signed by
B. W. SHEPARD
 By B. W. Shepard
 Title Exploitation Engineer



NEW MEXICO OIL CONSERVATION COMMISSION

Well Location and Acreage Dedication Plat

Section A.

Date December 30, 1959

Operator Shell Oil Company Lease Carson Unit
 Well No. 22-18 Unit Letter F Section 18 Township 25 N. Range 11 W. NMPM
 Located 1980' Feet From The North Line, 1980 Feet From The West Line
 County San Juan G. L. Elevation 6357 Dedicated Acreage 40 (6-10-1959) Acres
 Name of Producing Formation Gallup Pool Bisti

1. Is the Operator the only owner in the dedicated acreage outlined on the plat below? 90.42
 Yes X No _____
2. If the answer to question one is "no", have the interests of all the owners been consolidated by communitization agreement or otherwise? Yes _____ No _____. If answer is "yes", Type of Consolidation.
3. If the answer to question two is "no", list all the owners and their respective interests below:

Owner

Land Description

Section B.

This is to certify that the information in Section A above is true and complete to the best of my knowledge and belief.

Shell Oil Company

(Operator)

Original signed by

B. W. SHEPARD

(Representative)

P.O. Box 158

(Address)

Farmington, New Mexico

Note: All distances must be from outer boundaries of section.

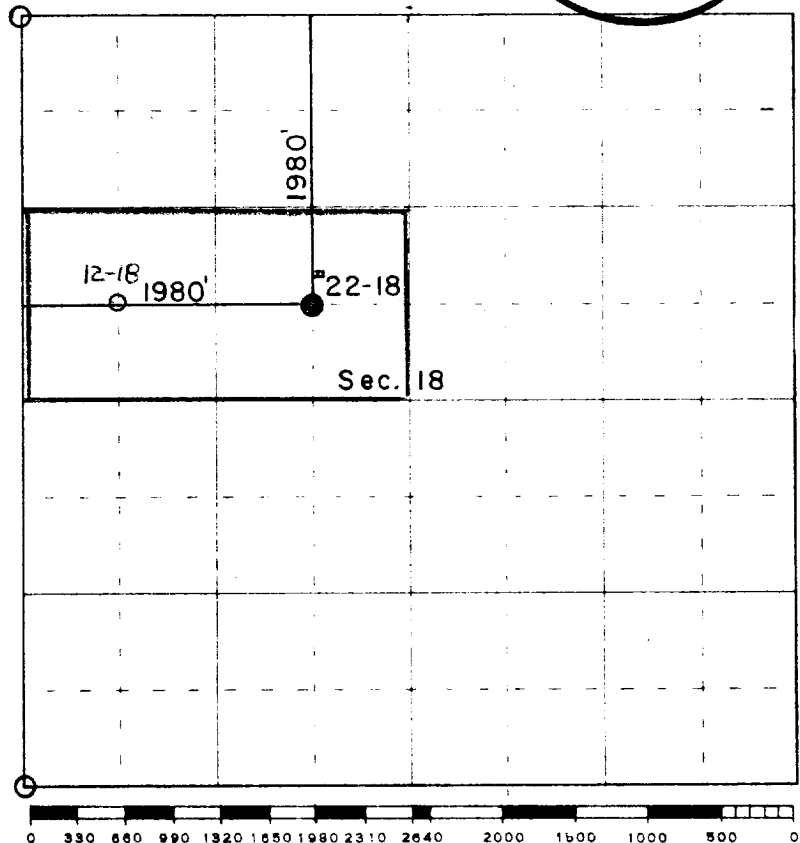

Scale 4 inches equal 1 mile

This is to certify that the above plat was prepared from field notes of actual surveys made by me or under my supervision and that the same are true and correct to the best of my knowledge and belief.

(Seal)

Date Surveyed 12-29-59

Blaine H. Fitzgerald L.S. 3181
 Registered Professional Engineer and/or Land Surveyor

Farmington, New Mexico