

(SUBMIT IN TRIPLICATE)

 UNITED STATES
 DEPARTMENT OF THE INTERIOR
 GEOLOGICAL SURVEY

 Land Office Santa Fe
 Lease No. SF 078475
 Unit _____

SUNDRY NOTICES AND REPORTS ON WELLS

| | | | |
|--|-------------------------------------|--|--|
| NOTICE OF INTENTION TO DRILL | <input checked="" type="checkbox"/> | SUBSEQUENT REPORT OF WATER SHUT-OFF | |
| NOTICE OF INTENTION TO CHANGE PLANS | | SUBSEQUENT REPORT OF SHOOTING OR ACIDIZING | |
| NOTICE OF INTENTION TO TEST WATER SHUT-OFF | | SUBSEQUENT REPORT OF ALTERING CASING | |
| NOTICE OF INTENTION TO RE-DRILL OR REPAIR WELL | | SUBSEQUENT REPORT OF RE-DRILLING OR REPAIR | |
| NOTICE OF INTENTION TO SHOOT OR ACIDIZE | | SUBSEQUENT REPORT OF ABANDONMENT | |
| NOTICE OF INTENTION TO PULL OR ALTER CASING | | SUPPLEMENTARY WELL HISTORY | |
| NOTICE OF INTENTION TO ABANDON WELL | | | |

(INDICATE ABOVE BY CHECK MARK NATURE OF REPORT, NOTICE, OR OTHER DATA)

7-31, 19 59

 Well No. 1 is located 1650 ft. from {N} line and 1650 ft. from {E} line of sec. 17
NE 1/4 17 25N 8-E 100W
 (1/4 Sec. and Sec. No.) (Twp.) (Range) (Meridian)

Wildcat Dakota San Juan New Mexico
 (Field) (County or Subdivision) (State or Territory)

 The elevation of the Ground ~~derrick floor~~ above sea level is 6452 ft.

DETAILS OF WORK

(State names of and expected depths to objective sands; show sizes, weights, and lengths of proposed casings; indicate mudding jobs, cementing points, and all other important proposed work)

Plan to drill w/rotary tools to an estimated total depth of 7000' and complete well in Dakota formation. Plan to dual complete if productive zone other than Dakota is encountered. Will core Dakota zone. Will set 200' of 9 5/8" O.D. 36# J-40 surface casing w/cement circulated to surface and set 7" O.D. 23# J-55 production casing at approx. total depth of 7000'. Plan to fracture treat Dakota formation with 30,000 gallons oil and 30,000# sand.

I understand that this plan of work must receive approval in writing by the Geological Survey before operations may be commenced.

Company PESTON NATIONAL GAS COMPANYAddress 2111 West MainFarmington, New MexicoBy Calvin M. ReyesTitle Petroleum Engineer

NEW MEXICO OIL CONSERVATION COMMISSION

Well Location and Acreage Dedication Plat

Section A.

Date **JULY 27, 1959**

Operator **WESTERN NATURAL GAS COMPANY** Lease **J. B. STEPHENSON** **SF 078475**
 Well No. **1** Unit Letter **G** Section **17** Township **25-N** Range **8-W** NMPM
 Located **1650** Feet From **NORTH** Line, **1650** Feet From **EAST** Line
 County **SAN JUAN** G. L. Elevation **6452** Dedicated Acreage **320** Acres
 Name of Producing Formation **DAKOTA** Pool **WILDCAT DAKOTA**

1. Is the Operator the only owner in the dedicated acreage outlined on the plat below?

Yes ☒ No ☐2. If the answer to question one is "no", have the interests of all the owners been consolidated by communitization agreement or otherwise? Yes ☐ No ☐ If answer is "yes", Type of Consolidation.

3. If the answer to question two is "no", list all the owners and their respective interests below:

Owner

Land Description

Section B.

Note: All distances must be from outer boundaries of section.

This is to certify that the information
 in Section A above is true and complete
 to the best of my knowledge and belief.

Western Natural Gas Co.
 (Operator)
Calvin M. Rayes
 (Representative)
211 1/2 W. Main
 (Address)
Farmington, New Mexico

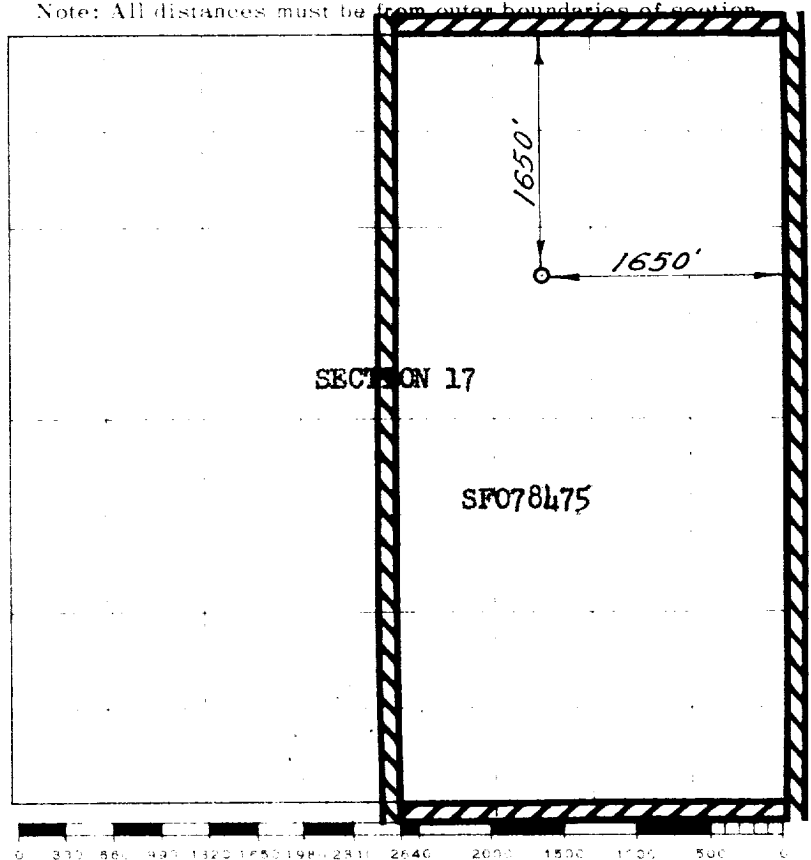

Scale 4 inches equal 1 mile

This is to certify that the above plat was prepared from field notes of actual surveys made by me or under my supervision and that the same are true and correct to the best of my knowledge and belief.

(Seal)

Date Surveyed, **JUNE 25, 1959**

Farmington, New Mexico

Registered Professional Engineer and/or Land Surveyor