

NEW MEXICO OIL CONSERVATION COMMISSION

Well Location and Acreage Dedication Plat

Section A.

Date January 29, 1958

Operator El Paso Natural Gas Products Company Lease Kelly State  
Well No. 12 Unit Letter        Section 16 Township 25 North Range 12 West NMPM  
Located 330 Feet From North Line, 2310 Feet From West Line  
County San Juan G. L. Elevation 6200 Dedicated Acreage 80 Acres  
Name of Producing Formation Gallego Pool West-Lower Gallego

1. Is the Operator the only owner\* in the dedicated acreage outlined on the plat below?  
Yes X No
2. If the answer to question one is "no," have the interests of all the owners been consolidated by communitization agreement or otherwise? Yes        No       . If answer is "yes,"  
Type of Consolidation
3. If the answer to question two is "no," list all the owners and their respective interests below:

Owner

Land Description

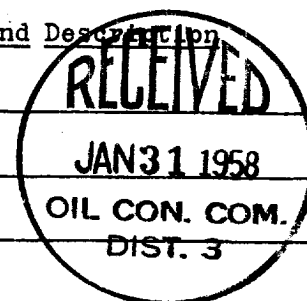

Section. B

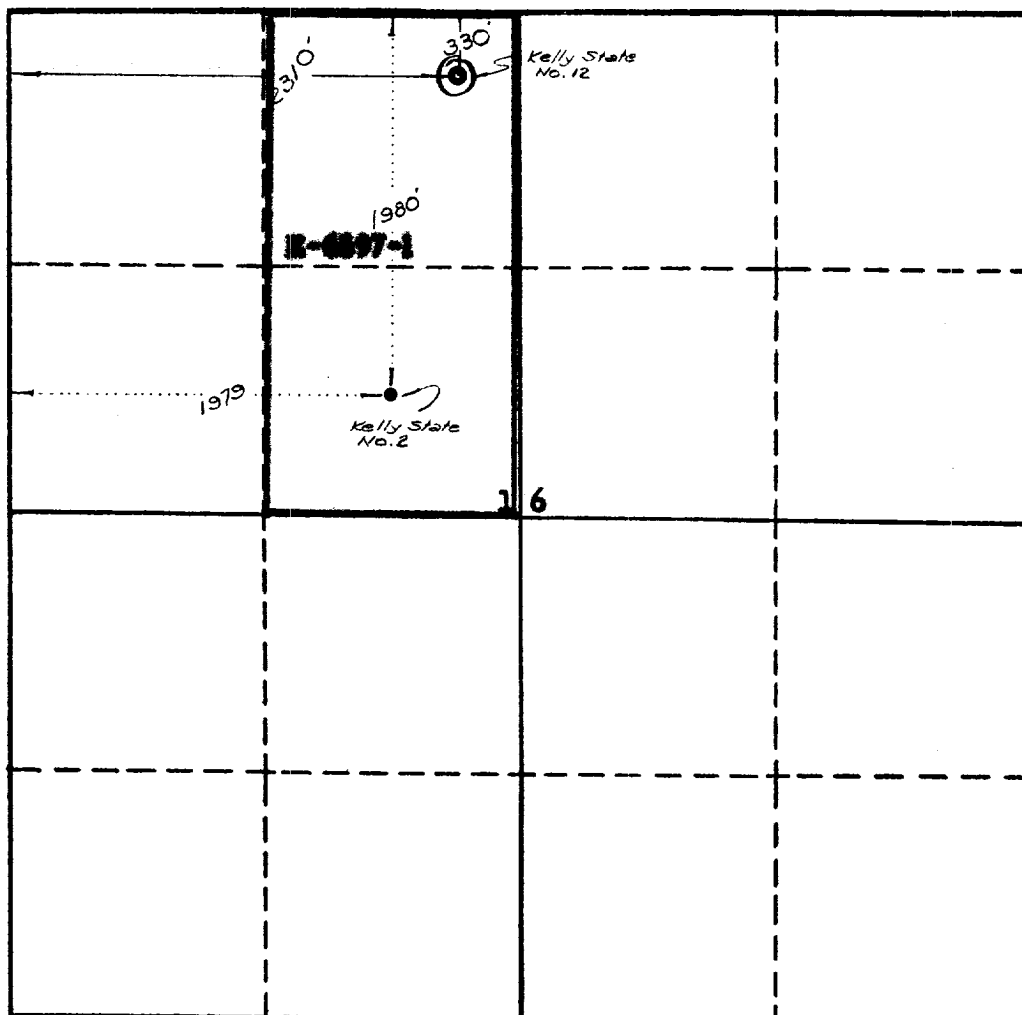

This is to certify that the information in Section A above is true and complete to the best of my knowledge and belief.

El Paso Natural Gas Products Co.

(Operator)

J. E. Seger  
(Representative)

Box 1844, Farmington, New Mex.

Address

This is to certify that the well location shown on the plat in Section B was plotted from field notes of actual surveys made by me or under my supervision and that the same is true and correct to the best of my knowledge and belief.

Date Surveyed Nov. 5, 1957

Revised/Issued 1-24-58

Ernest V. Echohawk  
Registered Land Surveyor.

Certificate No. 1545



<b>OIL CONSERVATION COMMISSION</b>	
<b>AZTEC DISTRICT OFFICE</b>	
No. Copies Received	
DISTRIBUTION	
TO	
BY	
DATE	
CHIEF	
ASST. CHIEF	
SECRETARY	
PROPERTY CLERK	
BOOK CLERK	
U. S. G.	
TRANSPORT	
FILE	