

Form 9-331b
(April 1952)

(SUBMIT IN TRIPLICATE)

Indian Agency _____

Window Book _____

Allottee _____

Lease No. 14-20-03-515

UNITED STATES
DEPARTMENT OF THE INTERIOR
GEOLOGICAL SURVEY

SUNDRY NOTICES AND REPORTS ON WELLS

NOTICE OF INTENTION TO DRILL	<input checked="" type="checkbox"/>	SUBSEQUENT REPORT OF WATER SHUT-OFF
NOTICE OF INTENTION TO CHANGE PLANS	<input type="checkbox"/>	SUBSEQUENT REPORT OF SHOOTING OR ACIDIZING
NOTICE OF INTENTION TO TEST WATER SHUT-OFF	<input type="checkbox"/>	SUBSEQUENT REPORT OF ALTERING CASING
NOTICE OF INTENTION TO REDRILL OR REPAIR WELL	<input type="checkbox"/>	SUBSEQUENT REPORT OF REDRILLING OR REPAIR
NOTICE OF INTENTION TO SHOOT OR ACIDIZE	<input type="checkbox"/>	SUBSEQUENT REPORT OF ABANDONMENT
NOTICE OF INTENTION TO PULL OR ALTER CASING	<input type="checkbox"/>	SUPPLEMENTARY WELL HISTORY
NOTICE OF INTENTION TO ABANDON WELL	<input type="checkbox"/>	

RECEIVED

DEC 15 1959

U. S. GEOLOGICAL SURVEY
FARMINGTON, NEW MEXICO

(INDICATE ABOVE BY CHECK MARK NATURE OF REPORT, NOTICE, OR OTHER DATA)

December 15, 1959

Well No. Nav. 3 is located 990 ft. from N line and 1650 ft. from E line of sec. 9

N 1/4 Sec. 9 25 N 19 E N.E. 1/4
(1/4 Sec. and Sec. No.) (Twp.) (Range) (Meridian)

Wildcat San Juan New Mexico
(Field) (County or Subdivision) (State or Territory)

The elevation of the derrick floor above sea level is 6049 ft.

DETAILS OF WORK

(State names of and expected depths to objective sands; show sizes, weights, and lengths of proposed casings; indicate mudding jobs, cementing points, and all other important proposed work)

It is intended:

To drill 9 7/8" hole to 80' and set 7 5/8" casing as surface pipe. Cement 1/50 sack regular.
To drill 6 3/4" hole w/ Cable Tools to top of Dakota, w/ Pottery rig to 200' or through the Entrada and run logs. Entrada will be cored if necessary. 4" casing will be run as production casing.
Completion procedure will be determined from core and log information.

I understand that this plan of work must receive approval in writing by the Geological Survey before operations may be commenced.

Company Drilling and Coring Exploration Co.

Address 1809 Laguna

Farmington, New Mexico

By Carl E. Narmen

Title Partner
Drilling & Coring Exploration Co.

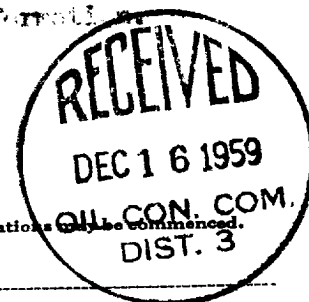

Handwritten: Held 0-110 for C-128
Ret'd to office 12-16-59

Handwritten: PT
L

1

NEW MEXICO OIL CONSERVATION COMMISSION
WELL LOCATION AND ACREAGE DEDICATION PLAT

FORM C-128
Revised 5/1/57

SEE INSTRUCTIONS FOR COMPLETING THIS FORM ON THE REVERSE SIDE

SECTION A

Operator <i>Drilling & Coring Exploration Co</i>		Lease <i>Navajo</i>		Well No. <i>3</i>	
Unit Letter <i>C</i>	Section <i>20</i>	Township <i>25 N</i>	Range <i>19 W</i>	County <i>San Juan</i>	
Actual Footage Location of Well: <i>990</i> feet from the <i>South</i> line and <i>1650</i> feet from the <i>EAST</i> line					
Ground Level Elev. <i>5000</i>	Producing Formation <i>ENTRADA</i>		Pool <i>WILLCAT</i>		Dedicated Acreage: <i>40</i> Acres

1. Is the Operator the only owner in the dedicated acreage outlined on the plat below? YES _____ NO X. ("Owner" means the person who has the right to drill into and to produce from any pool and to appropriate the production either for himself or for himself and another. (65-3-29 (e) NMSA 1935 Comp.)
2. If the answer to question one is "no," have the interests of all the owners been consolidated by communization agreement or otherwise? YES X NO _____. If answer is "yes," Type of Consolidation FEDERAL
3. If the answer to question two is "no," list all the owners and their respective interests below:

Owner	Land Description

SECTION B

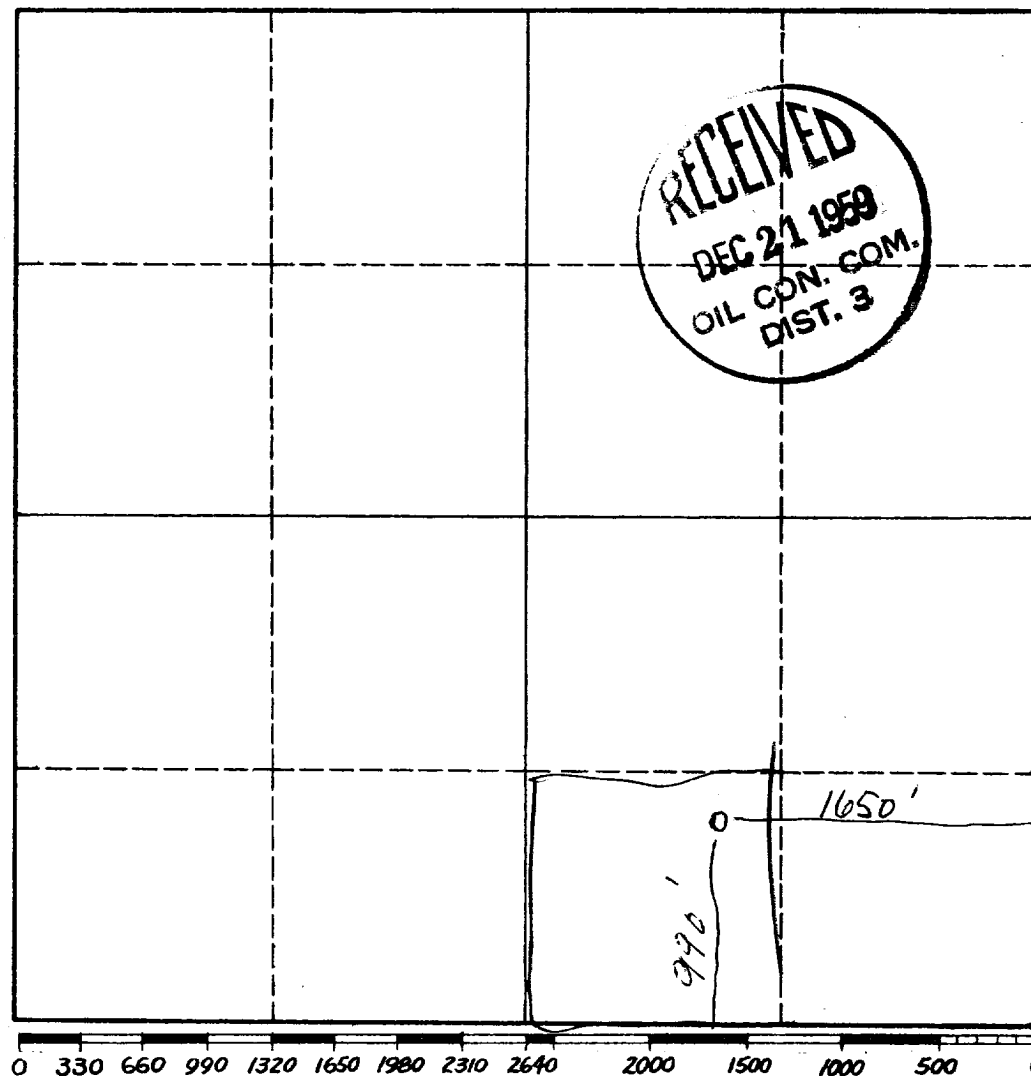

CERTIFICATION

I hereby certify that the information in SECTION A above is true and complete to the best of my knowledge and belief.

Name	<i>Earl E. Harmon</i>
Position	<i>Partner</i>
Company	<i>Drilling & Coring Exploration Co</i>
Date	<i>12-18-59</i>

I hereby certify that the well location shown on the plat in SECTION B was plotted from field notes of actual surveys made by me or under my supervision, and that the same is true and correct to the best of my knowledge and belief.

Date Surveyed	<i>Dec. 14, 1959</i>
Registered Professional Engineer and/or Land Surveyor	
<i>Stephen K. Ramsey</i>	
Certificate No.	<i>803</i>

INSTRUCTIONS FOR COMPLETION OF FORM C-128

1. Operator shall furnish and certify to the information called for in Section A.
2. Operator shall outline the dedicated acreage for *both* oil and gas wells on the plat in Section B.
3. A registered professional engineer or land surveyor registered in the State of New Mexico or approved by the Commission shall show on the plat the location of the well and certify this information in the space provided.
4. All distances shown on the plat must be from the outer boundaries of the Section.
5. If additional space is needed for listing owners and their respective interests as required in question 3 of Section A, please use space below.

[illegible]

NEW MEXICO OIL CONSERVATION COMMISSION
Well Location and Acreage Dedication Plat

Section A.

Date 12-15-59

Operator DRILLING & CORING EXPLORATION CO. Lease NAVAJO
Well No. 3 Unit Letter _____ Section 9 Township 25 N Range 19 W NMPM
Located 990 Feet From south Line, 1650 Feet From east Line
County San Juan G. L. Elevation 6049 Dedicated Acreage 40 Acres
Name of Producing Formation ENTRADA Pool WILSON

1. Is the Operator the only owner* in the dedicated acreage outlined on the plat below?
Yes ✓ No X.
2. If the answer to question one is "no," have the interests of all the owners been consolidated by communitization agreement or otherwise? Yes X No _____. If answer is "yes," Type of Consolidation FEEDBACK
3. If the answer to question two is "no," list all the owners and their respective interests below:

Owner

Land Description

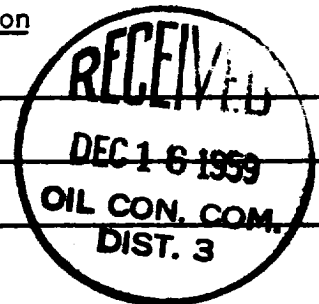

Section B

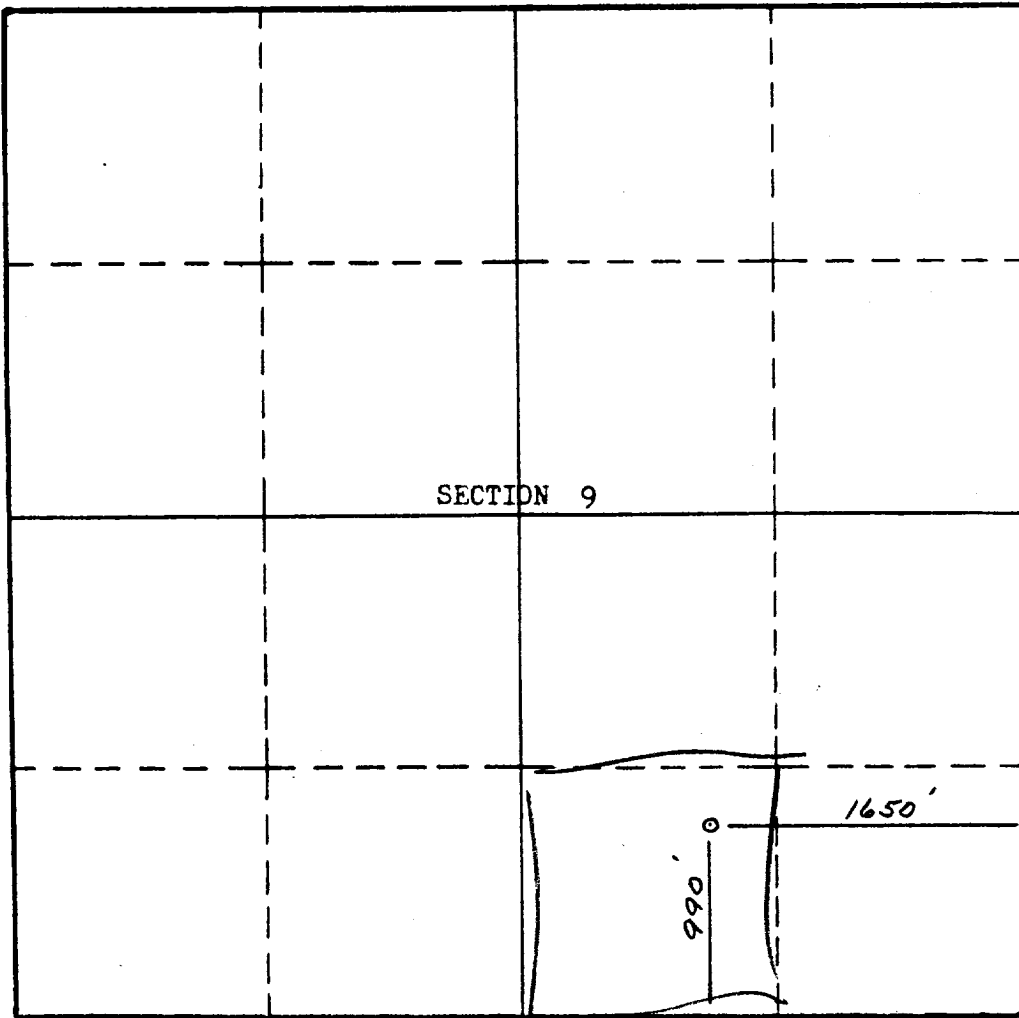

This is to certify that the information in Section A above is true and complete to the best of my knowledge and belief.

E. Edgar N. Lohmann
(Operator)

Partner
(Representative)

1809 Laguna, Farmington, N.M.
Address

This is to certify that the well location shown on the plat in Section B was plotted from field notes of actual surveys made by me or under my supervision and that the same is true and correct to the best of my knowledge and belief.

Date Surveyed Dec 14, 1959
Stephen B. Linn
Registered Professional
Engineer and/or Land Surveyor.

Certificate No. 809

OIL CONSERVATION COMMISSION		
AZTEC DISTRICT OFFICE		
No. Copies Forwarded <u>2</u>		
DISTRIBUTION		
	NO. COPIES	
Director		
Secretary	1	
Operations Manager		
State Land Office		
U. S. G. S.		
Transporter		
File	1	✓