

(SUBMIT IN TRIPLICATE)

Indian Agency _____

Window Rock

Allottee Joan White

Lease No. 14-20-603-326

UNITED STATES
DEPARTMENT OF THE INTERIOR
GEOLOGICAL SURVEY

X		

SUNDRY NOTICES AND REPORTS ON WELLS

NOTICE OF INTENTION TO DRILL	X	SUBSEQUENT REPORT OF WATER SHUT-OFF	
NOTICE OF INTENTION TO CHANGE PLANS		SUBSEQUENT REPORT OF SHOOTING OR ACIDIZING	
NOTICE OF INTENTION TO TEST WATER SHUT-OFF		SUBSEQUENT REPORT OF ALTERING CASING	
NOTICE OF INTENTION TO REDRILL OR REPAIR WELL		SUBSEQUENT REPORT OF REDRILLING OR REPAIR	
NOTICE OF INTENTION TO SHOOT OR ACIDIZE		SUBSEQUENT REPORT OF ABANDONMENT	
NOTICE OF INTENTION TO PULL OR ALTER CASING		SUPPLEMENTARY WELL HISTORY	
NOTICE OF INTENTION TO ABANDON WELL			

(INDICATE ABOVE BY CHECK MARK NATURE OF REPORT, NOTICE, OR OTHER DATA)

August 27, 1959

CBU

Well No. 27 is located 1980 ft. from (N) line and 1980 ft. from (E) line of sec. 9

NE/4 of SW/4 Sec. 9
(1/4 Sec. and Sec. No.)

25-N
(Twp.)

12-W
(Range)

N M P M
(Meridian)

Bisti Lower Gallup
(Field)

San Juan
(County or Subdivision)

New Mexico
(State or Territory)

The elevation of the ^{Ground}derrick floor above sea level is 6205 ft.

DETAILS OF WORK

(State names of and expected depths to objective sands; show sizes, weights, and lengths of proposed casings; indicate mudding jobs, cementing points, and all other important proposed work)

This 4950' Lower Gallup oil well will be drilled as follows:
A 12 1/2" hole will be drilled to 300'. 8 5/8" 24# J-55 Csg will be set at 300' & cemented to surface. A 7 7/8" hole will be drilled to 4950'. 4 1/2" 9.5# J-53 Csg will be set at 4950' & cemented to 4000'. The Lower Gallup pay will be Gun perforated & Sand fractured for Production.



I understand that this plan of work must receive approval in writing by the Geological Survey before operations may be commenced.

Company Sunray Mid-Continent Oil Co.

Address 166 Petroleum Center Bldg.

Farmington,

New Mexico

By _____

Title Engineer

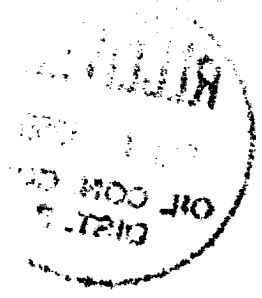

NEW MEXICO OIL CONSERVATION COMMISSION
WELL LOCATION AND ACREAGE DEDICATION PLAT

FORM C-128
Revised 5/1/57

SEE INSTRUCTIONS FOR COMPLETING THIS FORM ON THE REVERSE SIDE

SECTION A

Operator SUNRAY MID-CONTINENT OIL CO.		Lease CENTRAL BISTI UNIT		Well No. 27
Unit Letter K	Section 9	Township 25 NORTH	Range 12 WEST	County SAN JUAN
Actual Footage Location of Well: 1980 feet from the SOUTH line and 1980 feet from the WEST line				
Ground Level Elev. 6205.2	Producing Formation Lower Galtop	Pool Block Lower Galtop	Dedicated Acreage: 40 Acres	

1. Is the Operator the only owner in the dedicated acreage outlined on the plat below? YES _____ NO ☒ . ("Owner" means the person who has the right to drill into and to produce from any pool and to appropriate the production either for himself or for himself and another. (65-3-29 (e) NMSA 1935 Comp.)
2. If the answer to question one is "no," have the interests of all the owners been consolidated by communitization agreement or otherwise? YES ☒ NO _____. If answer is "yes," Type of Consolidation Block Agreement
3. If the answer to question two is "no," list all the owners and their respective interests below:

Owner	Land Description

SECTION B

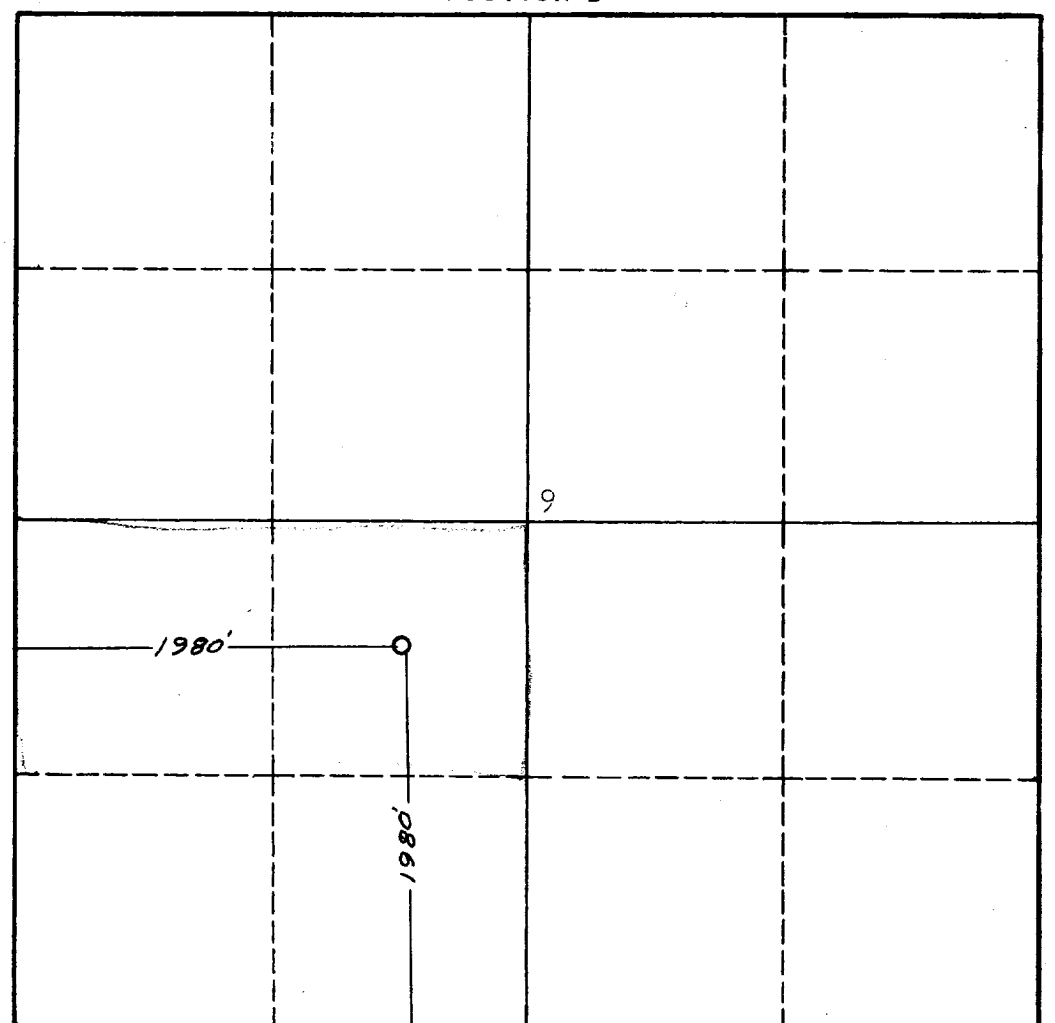

RECEIVED
SEP 1 1959
OIL CONSERVATION COM.
DIST. 3

I hereby certify that the information in SECTION A above is true and complete to the best of my knowledge and belief.

Name <u>Hal M. Stenwald</u>
Position <u>Engineer</u>
Company <u>Sunray Mid-Continent Oil Co.</u>
Date <u>9-27-59</u>

I hereby certify that the well location shown on the plat in SECTION B was plotted from field notes of actual surveys made by me or under my supervision, and that the same is true and correct to the best of my knowledge and belief.

Date Surveyed July 20, 1959
Registered Professional Engineer and/or Land Surveyor <u>James P. Lense</u> JAMES P. LENSE
Certificate No. 1463

INSTRUCTIONS FOR COMPLETION OF FORM C-128

1. Operator shall furnish and certify to the information called for in Section A.
2. Operator shall outline the dedicated acreage for *both* oil and gas wells on the plat in Section B.
3. A registered professional engineer or land surveyor registered in the State of New Mexico or approved by the Commission shall show on the plat the location of the well and certify this information in the space provided.
4. All distances shown on the plat must be from the outer boundaries of the Section.
5. If additional space is needed for listing owners and their respective interests as required in question 3 of Section A, please use space below.