

**(SUBMIT IN TRIPLICATE)**

UNITED STATES  
DEPARTMENT OF THE INTERIOR  
GEOLOGICAL SURVEY

**Indian Agency** .....

~~Window Rock~~

Allottee T-Tah-Nip

Lease No. 14-20-603-1228

## SUNDRY NOTICES AND REPORTS ON WELLS

NOTICE OF INTENTION TO DRILL	<input checked="" type="checkbox"/>	SUBSEQUENT REPORT OF WATER SHUT-OFF	<input type="checkbox"/>
NOTICE OF INTENTION TO CHANGE PLANS	<input type="checkbox"/>	SUBSEQUENT REPORT OF SHOOTING OR ACIDIZING	<input type="checkbox"/>
NOTICE OF INTENTION TO TEST WATER SHUT-OFF	<input type="checkbox"/>	SUBSEQUENT REPORT OF ALTERING CASING	<input type="checkbox"/>
NOTICE OF INTENTION TO REDRILL OR REPAIR WELL	<input type="checkbox"/>	SUBSEQUENT REPORT OF REDRILLING OR REPAIR	<input type="checkbox"/>
NOTICE OF INTENTION TO SHOOT OR ACIDIZE	<input type="checkbox"/>	SUBSEQUENT REPORT OF ABANDONMENT	<input type="checkbox"/>
NOTICE OF INTENTION TO PULL OR ALTER CASING	<input type="checkbox"/>	SUPPLEMENTARY WELL HISTORY	<input type="checkbox"/>
NOTICE OF INTENTION TO ABANDON WELL	<input type="checkbox"/>		

(INDICATE ABOVE BY CHECK MARK NATURE OF REPORT, NOTICE, OR OTHER DATA)

August 27, 1959

Well No. 26 is located 1980 ft. from N line and 660 ft. from E line of sec. 9

NE/4 of SE/4 Sec. 9      25-P      12-W      N M P M  
(1/4 Sec. and Sec. No.)      (Twp.)      (Range)      (Meridian)

Bisti Lower Gallup      San Juan      New Mexico  
(Field)      (County or Subdivision)      (State or Territory)

The elevation of the ~~derrick~~<sup>Ground</sup> floor above sea level is 61.57 ft.

## DETAILS OF WORK

(State names of and expected depths to objective sands; show sizes, weights, and lengths of proposed casings; indicate mudding jobs, cementing points, and all other important proposed work)

This 4920' Gallup oil Well will be drilled as follows. A 12½" hole will be drilled to 300'. 8 5/8" 24# J-55 Csg will be run to 300' & cemented to surface. A 7 7/8" hole will be drilled to 4920'. 4½" 9.5# J-55 Csg will be run to 4920' & cemented to 4000'. The Lower Gallup pay will be Gun perforated & Sand fractured for production.

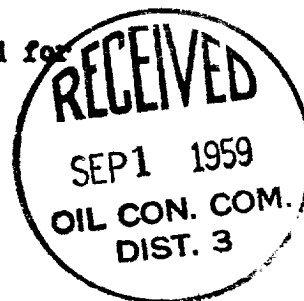

**I understand that this plan of work must receive approval in writing by the Geological Survey before operations may be commenced.**

Company Sunray Mid-Continent Oil Co.

Address 166 Petroleum Center Bldg.

**Farmington.**-----

New Mexico

ORIGINAL SIGNED BY  
H. M. GILBERT

By \_\_\_\_\_

Title **Engineer**

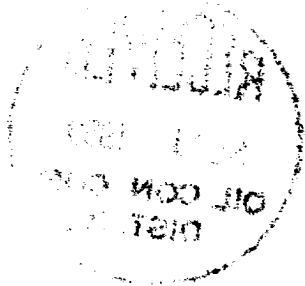

NEW MEXICO OIL CONSERVATION COMMISSION  
WELL LOCATION AND ACREAGE DEDICATION PLAT

FORM C-128  
Revised 5/1/57

SEE INSTRUCTIONS FOR COMPLETING THIS FORM ON THE REVERSE SIDE

SECTION A

Operator <b>SUNRAY MID-CONTINENT OIL CO.</b>		Lease <b>C.B.U.</b>		Well No. <b>26</b>
Unit Letter <b>I</b>	Section <b>9</b>	Township <b>25 NORTH</b>	Range <b>12 WEST</b>	County <b>SAN JUAN</b>
Actual Footage Location of Well: <b>1980</b> feet from the <b>SOUTH</b> line and <b>660</b> feet from the <b>EAST</b> line				
Ground Level Elev. <b>6156.9</b>	Producing Formation <b>Lower Gallup</b>	Pool <b>Bisti Lower Gallup</b>	Dedicated Acreage: <b>80</b> Acres	

1. Is the Operator the only owner in the dedicated acreage outlined on the plat below? YES \_\_\_\_\_ NO X . ("Owner" means the person who has the right to drill into and to produce from any pool and to appropriate the production either for himself or for himself and another. (65-3-29 (e) NMSA 1935 Comp.)
2. If the answer to question one is "no," have the interests of all the owners been consolidated by communization agreement or otherwise? YES X NO \_\_\_\_\_. If answer is "yes," Type of Consolidation Unit Agreement.
3. If the answer to question two is "no," list all the owners and their respective interests below:

Owner	Land Description

SECTION B

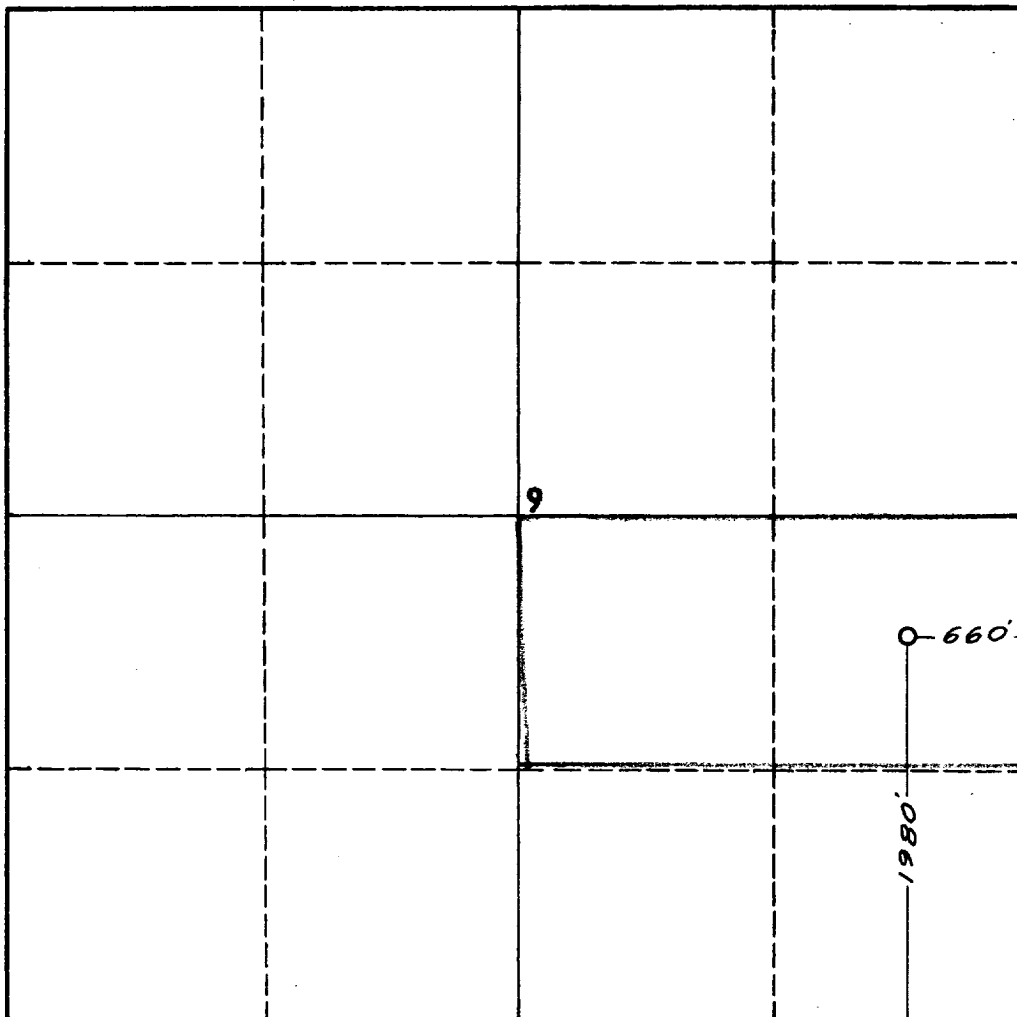

I hereby certify that the information in SECTION A above is true and complete to the best of my knowledge and belief.

Name Hal M. Stierwalt  
Position Engineer  
Company Sunray Mid-Continent Oil Co.  
Date 8-27-59

I hereby certify that the well location shown on the plat in SECTION B was plotted from field notes of actual surveys made by me or under my supervision, and that the same is true and correct to the best of my knowledge and belief.

Date Surveyed July 20, 1959  
Registered Professional Engineer and/or Land Surveyor James P. Leese  
Certificate No. 1463

## INSTRUCTIONS FOR COMPLETION OF FORM C-128

1. Operator shall furnish and certify to the information called for in Section A.
2. Operator shall outline the dedicated acreage for *both* oil and gas wells on the plat in Section B.
3. A registered professional engineer or land surveyor registered in the State of New Mexico or approved by the Commission shall show on the plat the location of the well and certify this information in the space provided.
4. All distances shown on the plat must be from the outer boundaries of the Section.
5. If additional space is needed for listing owners and their respective interests as required in question 3 of Section A, please use space below.