

(SUBMIT IN TRIPLICATE)

UNITED STATES
DEPARTMENT OF THE INTERIOR
GEOLOGICAL SURVEY

Land Office Santa Fe, N. M.

Lease No. SP 978066

Unit _____

SUNDRY NOTICES AND REPORTS ON WELLS

| | | |
|---|-------------------------------------|---|
| NOTICE OF INTENTION TO DRILL..... | <input checked="" type="checkbox"/> | SUBSEQUENT REPORT OF WATER SHUT-OFF..... |
| NOTICE OF INTENTION TO CHANGE PLANS..... | | SUBSEQUENT REPORT OF SHOOTING OR ACIDIZING..... |
| NOTICE OF INTENTION TO TEST WATER SHUT-OFF..... | | SUBSEQUENT REPORT OF ALTERING CASING..... |
| NOTICE OF INTENTION TO RE-DRILL OR REPAIR WELL..... | | SUBSEQUENT REPORT OF RE-DRILLING OR REPAIR..... |
| NOTICE OF INTENTION TO SHOOT OR ACIDIZE..... | | SUBSEQUENT REPORT OF ABANDONMENT..... |
| NOTICE OF INTENTION TO PULL OR ALTER CASING..... | | SUPPLEMENTARY WELL HISTORY..... |
| NOTICE OF INTENTION TO ABANDON WELL..... | | |

(INDICATE ABOVE BY CHECK MARK NATURE OF REPORT, NOTICE, OR OTHER DATA)

Well No. Gov't is located 1980 ft. from [N] line and 660 ft. from [E] line of sec. 10
43-10
NE 1/4 Sec. 10 (T 25N R 12W (M 107K)
Blsti (Field) San Juan (Subdivision) New Mexico

The elevation of the derrick floor above sea level is 6207 ft. (approx. ground)

DETAILS OF WORK

(State names of and expected depths to objective sands; show sizes, weights, and lengths of proposed casings; indicate mudding jobs, cementing points, and all other important proposed work)

1. Drill 12 1/2" hole to 200'±.
2. Cement 8 5/8" casing at 200'± with 100 sacks construction cement.
3. Drill 7 7/8" hole to 4940'±.
4. Cement 4 1/2" casing at 4940'±.
5. Clean out to 4920'±.
6. Perforate four 1/2" holes/ft select intervals between 4800-4940.
7. If applicable, sand oil fracture with 30,000 gal crude oil and 15,000# sand.
8. Hang tubing at bottom of perforations.
9. Sub well into production, establish initial rate.

I understand that this plan of work must receive approval in writing by the Geological Survey before operations may commence.

Company Shell Oil Company

Address 108 W. Betrand

Farmington, N. Mexico

By B W Shepard

Title B. W. Shepard
Exploitation Engineer

1944
1945
1946
1947

1948
1949
1950



NEW MEXICO OIL CONSERVATION COMMISSION

Well Location and Acreage Dedication Plat

Section A.

Date _____

Operator Shell Oil Company

Lease I. M. Phillips # 2

Gov't ~~Well~~ No. 43-10 Letter I Section 10 Township 25N Range 12W Range

Located 1980 Feet From 5 Line, 660 Feet From E Line

County San Juan A. L. Elevation 6207 Dedicated Acreage 40 Acreage

Well Pool Callup Pool Blati

1. Is the owner of the land in the dedicated acreage outlined on the plat below?
Yes X No _____
2. If the answer to question one is "no," have the interests of all the owners been consolidated by a partition agreement or otherwise? Yes _____ No _____. If answer is "yes," list the consolidation _____
3. If the answer to question two is "no," list all the owners and their respective interests below: _____

Owner

Land Description

RECEIVED
JUN 25 1981
U. S. GEOLOGICAL SURVEY
WASHINGTON, NEW MEXICO

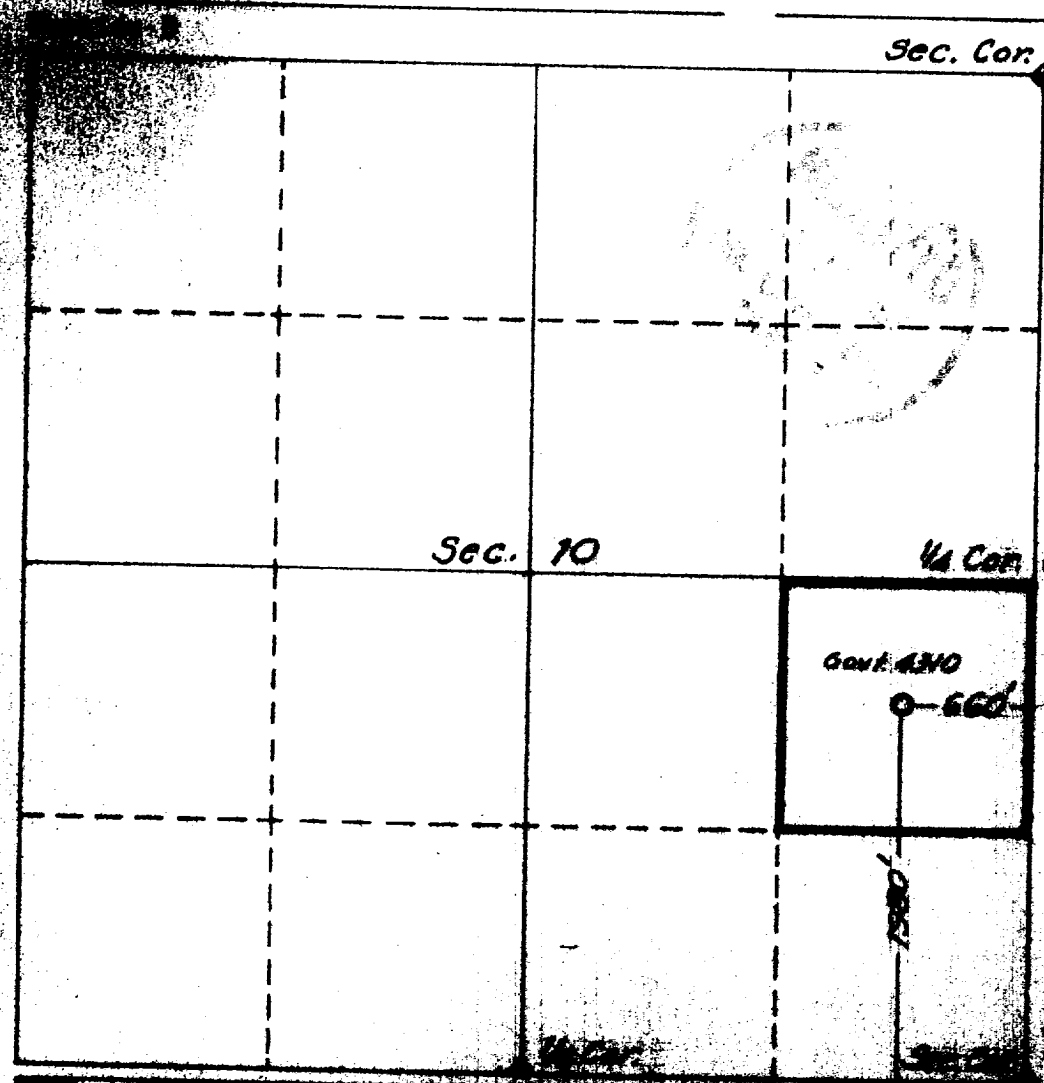

This is to certify that the information above is true to the best of my knowledge and belief.

Shell Oil

(Operator)

B.W. Shuman

(Signature)

188 North 2nd

Albuquerque, N.M.

(Notary Public)

This is to certify that the well location and acreage dedication plat in this document is a true and correct copy of the original as filed with the New Mexico State Surveyor's Office.

