

(SUBMIT IN TRIPLICATE)

UNITED STATES
DEPARTMENT OF THE INTERIOR
GEOLOGICAL SURVEY

Land Office Santa Fe, N. M.
Lease No. Mi 036254
Unit _____

SUNDRY NOTICES AND REPORTS ON WELLS

NOTICE OF INTENTION TO DRILL	<input checked="" type="checkbox"/>	SUBSEQUENT REPORT OF WATER SHUT-OFF	
NOTICE OF INTENTION TO CHANGE PLANS		SUBSEQUENT REPORT OF SHOOTING OR ACIDIZING	
NOTICE OF INTENTION TO TEST WATER SHUT-OFF		SUBSEQUENT REPORT OF ALTERING CASING	
NOTICE OF INTENTION TO RE-DRILL OR REPAIR WELL		SUBSEQUENT REPORT OF RE-DRILLING OR REPAIR	
NOTICE OF INTENTION TO SHOOT OR ACIDIZE		SUBSEQUENT REPORT OF ABANDONMENT	
NOTICE OF INTENTION TO PULL OR ALTER CASING		SUPPLEMENTARY WELL HISTORY	
NOTICE OF INTENTION TO ABANDON WELL			

(INDICATE ABOVE BY CHECK MARK NATURE OF REPORT, NOTICE, OR OTHER DATA)

RECEIVED
AUG 29 1957
U. S. GEOLOGICAL SURVEY
FARMINGTON, NEW MEXICO

August 23, 19 57

Well No. 42-9 is located 210 ft. from N line and 775 ft. from E line of sec. 9
NE 9 25N 12W RM 18
(1/4 Sec. and Sec. No.) (Twp.) (Range) (Meridian)
Dist 1 San Juan New Mexico
(Field) (County or Subdivision) (State or Territory)

The elevation of the derrick floor above sea level is 6170 ft. (approx. ground)

DETAILS OF WORK

(State names of and expected depths to objective sands; show sizes, weights, and lengths of proposed casings; indicate mudding jobs, cementing points, and all other important proposed work)

Proposed Work:

1. Drill 12-1/4" hole to 100'±.
2. Run and cement 8-5/8" casing at 100'± (depending on water flow) with 50 sacks treated cement. Test 200 and casing at 700 psi 15 minutes.
3. Drill 7-7/8" hole to 4850'±.
4. Run and cement 4-1/2" casing at 4845'± with 150 sacks treated cement. Hold 1500 psi on casing for 15 minutes.
5. Clean out to 4830'.
6. Perforate four 1/2" holes/ft. in selected intervals determined from logs.
7. If applicable, sand oil fracture with 30,000 gal. crude sand 1-2/gal. sand.
8. Swab well into production and establish initial rate.

I understand that this plan of work must receive approval in writing by the Geological Survey before operations may be commenced.

Company Shell Oil Company

Address 101 S. Behrend

Farmington, N. M.

By

B. W. Shepard

Title Exploitation Engineer

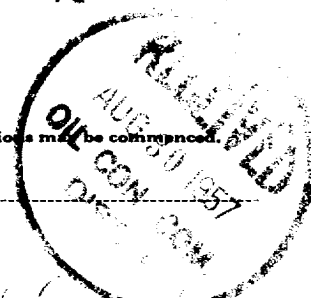

NEW MEXICO OIL CONSERVATION COMMISSION

Well Location and Acreage Dedication Plat

Section A.

Date August 27, 1957

Operator SHELL OIL COMPANY Lease L. M. Phillips #2 NM 036254
 Well No. 42-9 Unit Letter H Section 9 Township 25 NORTH Range 12 WEST NMPM
 Located 2110 Feet From the NORTH Line, 775 Feet From the EAST Line
 County SAN JUAN G. L. Elevation _____ Dedicated Acreage 40 Acres
 Name of Producing Formation Gallup Pool Bist1

1. Is the Operator the only owner in the dedicated acreage outlined on the plat below?

Yes ☒ No ☐2. If the answer to question one is "no", have the interests of all the owners been consolidated by communization agreement or otherwise? Yes ☐ No ☐ If answer is "yes", Type of Consolidation _____

3. If the answer to question two is "no", list all the owners and their respective interests below:

Owner

Land Description

RECEIVED

AUG 29 1957

GEOLOGICAL SURVEY
FARMINGTON, NEW MEXICO

Section B.

Note: All distances must be from outer boundaries of section.

This is to certify that the information
 in Section A above is true and complete
 to the best of my knowledge and belief.

Shell Oil Company

(Operator)

B. W. Shepard

(Representative)

101 S. Behrend

(Address)

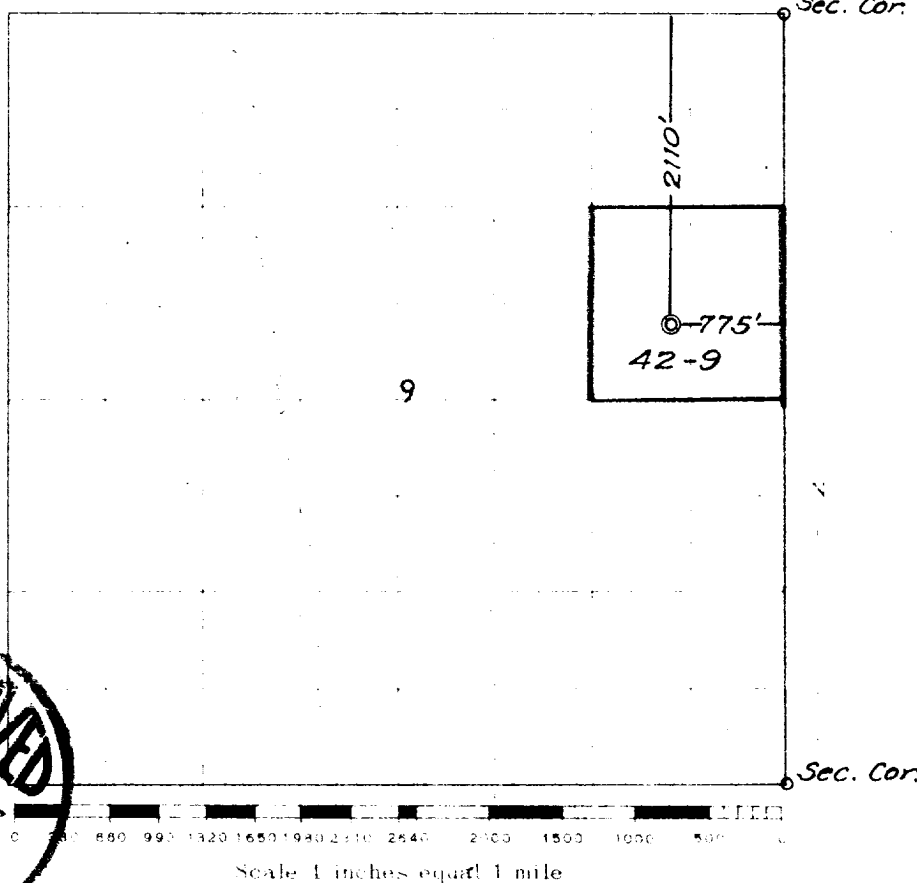
Farmington, N. M.

This is to certify that the above plat was prepared from field notes of actual surveys
 made by me or under my supervision and that the same are true and correct to the best
 of my knowledge and belief.

(Seal)

Farmington, New Mexico

Date Surveyed 27 AUGUST 1957

James P. Leese
 Registered Professional Engineer and/or Land Surveyor
 James P. Leese N. Mex. Reg. No. 1463