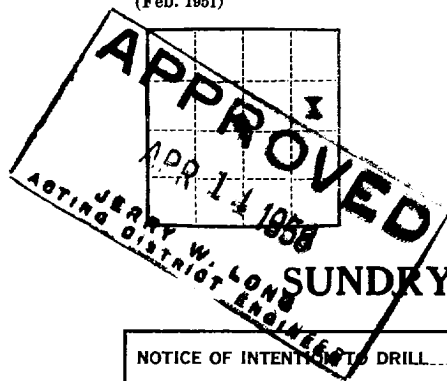

(SUBMIT IN TRIPLICATE)

UNITED STATES
DEPARTMENT OF THE INTERIOR
GEOLOGICAL SURVEYLand Office Santa Fe, N. M.Lease No. BN 036254Unit - -

SUNDRY NOTICES AND REPORTS ON WELLS

NOTICE OF INTENTION TO DRILL	SUBSEQUENT REPORT OF WATER SHUT-OFF
NOTICE OF INTENTION TO CHANGE PLANS	SUBSEQUENT REPORT OF SHOOTING OR ACIDIZING
NOTICE OF INTENTION TO TEST WATER SHUT-OFF	SUBSEQUENT REPORT OF ALTERING CASING
NOTICE OF INTENTION TO RE-DRILL OR REPAIR WELL	SUBSEQUENT REPORT OF RE-DRILLING OR REPAIR
NOTICE OF INTENTION TO SHOOT OR ACIDIZE	SUBSEQUENT REPORT OF ABANDONMENT
NOTICE OF INTENTION TO PULL OR ALTER CASING	SUPPLEMENTARY WELL HISTORY
NOTICE OF INTENTION TO ABANDON WELL	<u>Subsequent report of location change X</u>

(INDICATE ABOVE BY CHECK MARK NATURE OF REPORT, NOTICE, OR OTHER DATA)

September 9, 19 57

Government

Well No. 42-9 is located 1781 ft. from N line and 660 ft. from E line of sec. 9NE 9

(¼ Sec. and Sec. No.)

25N

(Twp.)

12W

(Range)

101M

(Meridian)

Dist 1

(Field)

San Juan

(County or Subdivision)

New Mexico

(State or Territory)

The elevation of ~~the wellhead~~ is 6131 ft.

DETAILS OF WORK

(State names of and expected depths to objective sands; show sizes, weights, and lengths of proposed casings; indicate mudding jobs, cementing points, and all other important proposed work)

Changed location from 2110' from the N line and 775' from the E line to 1781' from the N line and 660' from the E line .

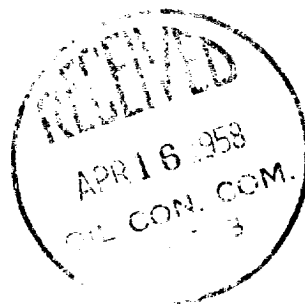

I understand that this plan of work must receive approval in writing by the Geological Survey before operations may be commenced.

Company Shell Oil CompanyAddress 101 S. Behrend Ave.Farmington, N. M.Original signed by
B. W. SHEPARDBy B. W. ShepardTitle Exploitation Engineer

NEW MEXICO OIL CONSERVATION COMMISSION

Well Location and Acreage Dedication Plat

Section A.

Date **September 9, 1957**

L. M. Phillips

Operator **SHELL OIL COMPANY**

Lease

GOVERNMENT

NM 036254

Gov't Well No. **42-9** Unit Letter **H** Section **9**Township **25 NORTH** Range **12 WEST** NMPMLocated **1781.32** Feet From **the NORTH** Line, **660**Feet From **the EAST** LineCounty **SAN JUAN** G. L. Elevation **6150** Est.Dedicated Acreage **40** AcresName of Producing Formation **Callup**Pool **Bisti**

1. Is the Operator the only owner in the dedicated acreage outlined on the plat below?

Yes **X** No

2. If the answer to question one is "no", have the interests of all the owners been consolidated by communitization agreement or otherwise? Yes No If answer is "yes", Type of Consolidation:

3. If the answer to question two is "no", list all the owners and their respective interests below:

Owner

Land Description

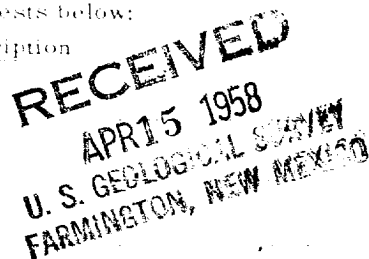

Section B.

Note: All distances must be from outer boundaries of section.

This is to certify that the information in Section A above is true and complete to the best of my knowledge and belief.

Shell Oil Company

(Operator)

B. W. Shepard

(Representative)

101 S. Behrend

(Address)

Farmington, N. M.

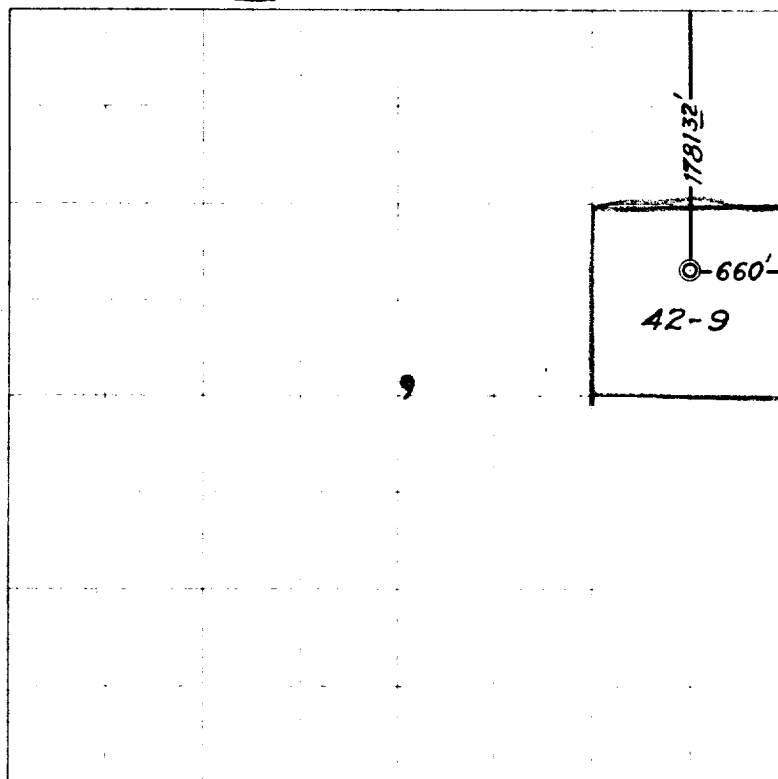

0 330 660 990 1320 1650 1980 2310 2640 2970 3300 3630 3960 4290 4620 4950 5280 5610 5940 6270 6600

Scale 4 inches equal 1 mile

TBM: Iron rod 715' S 30° W of
Location. Elev. 6131.01



This is to certify that the above plat was prepared from field notes of actual surveys made by me or under my supervision and that the same are true and correct to the best of my knowledge and belief.

Date Surveyed **20 AUGUST 1957**

James P. Leese
Registered Professional Engineer and/or Land Surveyor
James P. Leese N. Mex. Reg. No. 1463

NEW MEXICO OIL CONSERVATION COMMISSION

Well Location and Acreage Dedication Plat

Section A.

Date **September 9, 1957**

L. M. Phillips

Operator **SHELL OIL COMPANY**

Lease

GOVERNMENT

NM 036254

Gov't

Well No. **42-9** Unit Letter **H** Section **9**Township **25 NORTH** Range **12 WEST** NMPMLocated **1781.32** Feet From **the NORTH** Line, **660**Feet From **the EAST** LineCounty **SAN JUAN** G. L. Elevation **6150** Est.Dedicated Acreage **80** AcresName of Producing Formation **Callup**Pool **Bisti**

1. Is the Operator the only owner in the dedicated acreage outlined on the plat below?

Yes **X** No

2. If the answer to question one is "no", have the interests of all the owners been consolidated by communization agreement or otherwise? Yes No If answer is "yes", Type of Consolidation

3. If the answer to question two is "no", list all the owners and their respective interests

Owner

Land Description



Section B.

Note: All distances must be from outer boundaries of section.

This is to certify that the information in Section A above is true and complete to the best of my knowledge and belief.

Shell Oil Company

(Operator)

(Representative)

705 West Municipal Drive

(Address)

Farmington, N. M.

**TRM: Iron rod 715' S 30° W of
Location. Elev. 6131.01**

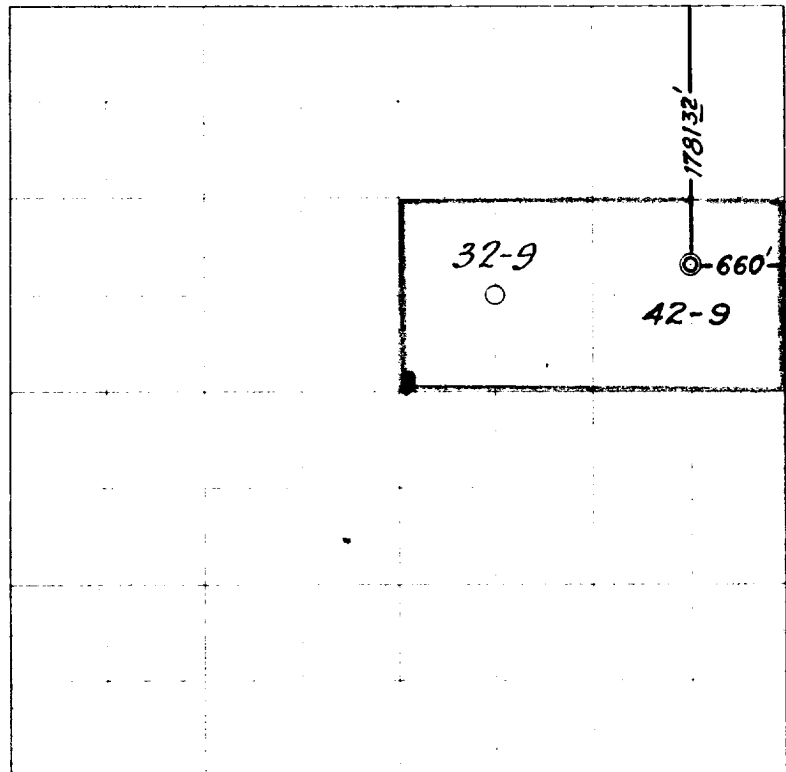

0 330 660 990 1320 1650 1980 2310 2640 2970 3300 3630 3960 4290 4620 4950 5280 5610 5940 6270 6600

Scale 4 inches equal 1 mile

This is to certify that the above plat was prepared from field notes of actual surveys made by me or under my supervision and that the same are true and correct to the best of my knowledge and belief.

Date Surveyed **20 AUGUST 1957**

James P. Leese
Registered Professional Engineer and/or Land Surveyor
James P. Leese **N. Mex. Reg. No. 1463**

Z 20-600-1



Farmington, New Mexico

AZTEC DISTRICT OFFICE
 MAY 1968

1944

4

170A

2

1

✓

NEW MEXICO OIL CONSERVATION COMMISSION
SANTA FE, NEW MEXICO

Form C-110
Revised 7/1/55

(File the original and 4 copies with the appropriate district office)

CERTIFICATE OF COMPLIANCE AND AUTHORIZATION
TO TRANSPORT OIL AND NATURAL GAS

Company or Operator Sunray Mid-Continent Oil Co. Lease CBU

Well No. 23 Unit Letter H S 9 T 25 R 12 Pool Blati Gallup

County San Juan Kind of Lease (State, Fed. or Patented) Federal

If well produces oil or condensate, give location of tanks: Unit A S 9 T 25 R 12

Authorized Transporter of Oil or Condensate Toronto Pipeline for

Address Account of El Paso Products Co.

(Give address to which approved copy of this form is to be sent)

Authorized Transporter of Gas All gas on unit re-injected

Address _____ Date Connected _____

(Give address to which approved copy of this form is to be sent)

If Gas is not being sold, give reasons and also explain its present disposition:

Reasons for Filing: (Please check proper box) New Well _____ ()

Change in Transporter of (Check One): Oil () Dry Gas () C'head () Condensate ()

Change in Ownership _____ () Other _____ (X)

Remarks: _____ (Give explanation below)

Well previously designated as Shell-Phillips # 4 42-9 .

The undersigned certifies that the Rules and Regulations of the Oil Conservation Commission have been complied with.

Executed this the _____ day of _____ 19 _____

ORIGINAL SIGNED BY
HAL M. STIERWALT

By _____

Approved AUG 6 1959 19

Title Engineer

OIL CONSERVATION COMMISSION

Original Signed By

By A. E. KENDRICK

Company Sunray Mid-Continent Oil Co.

Address Room 166 Pet. Bnter Bldg.

Title PETROLEUM ENGINEER DIST. NO. 3

Farmington, New Mexico

