

APPROVED
(SUBMIT IN TRIPLICATE)

UNITED STATES
DEPARTMENT OF THE INTERIOR
GEOLOGICAL SURVEY

Budget Bureau No. 42-R358.4.
Approval expires 12-31-60.

Land Office Santa Fe, N.M.
Lease No. FM 036254
Unit _____

SUNDRY NOTICES AND REPORTS ON WELLS

NOTICE OF INTENTION TO DRILL	<input checked="" type="checkbox"/>	SUBSEQUENT REPORT OF WATER SHUT-OFF	
NOTICE OF INTENTION TO CHANGE PLANS		SUBSEQUENT REPORT OF SHOOTING OR ACIDIZING	
NOTICE OF INTENTION TO TEST WATER SHUT-OFF		SUBSEQUENT REPORT OF ALTERING CASING	
NOTICE OF INTENTION TO RE-DRILL OR REPAIR WELL		SUBSEQUENT REPORT OF RE-DRILLING OR REPAIR	
NOTICE OF INTENTION TO SHOOT OR ACIDIZE		SUBSEQUENT REPORT OF ABANDONMENT	
NOTICE OF INTENTION TO PULL OR ALTER CASING		SUPPLEMENTARY WELL HISTORY	
NOTICE OF INTENTION TO ABANDON WELL			

(INDICATE ABOVE BY CHECK MARK NATURE OF REPORT, NOTICE, OR OTHER DATA)

August 21, 1957

Gov't.

Well No. 31-9 is located 620 ft. from N line and 1830 ft. from E line of sec. 9

NE 2 (1/4 Sec. and Sec. No.) 25N (Twp.) 12W (Range) 181M (Meridian)
Dist 1 (Field) San Juan (County or Subdivision) New Mexico (State or Territory)

The elevation ~~of the wellhead from base level~~ is 6201 ft. (Approximate ground)

DETAILS OF WORK

(State names of and expected depths to objective sands; show sizes, weights, and lengths of proposed casings; indicate mudding jobs, cementing points, and all other important proposed work)

Proposed work:

1. Drill 12 1/2" hole to 100'±.
2. Cement 8-5/8" csg. at 100'± with 50 sacks construction cement.
3. Drill 7-7/8" hole to 4880'±.
4. Cement 4 1/2" casing at 4875'± with 150 sacks construction cement.
5. Perforate four holes/foot in intervals determined by logs.
6. If applicable sand-oil fracture with 30,000 gal. crude oil and 1-2#/gal. sand.
7. Swab well into production, establish initial rate.

I understand that this plan of work must receive approval in writing by the Geological Survey before operations may be commenced.

Company Shell Oil Company
Address 101 South Behrand Avenue
Farmington, New Mexico

By B. W. Shepard
Title Exploitation Engineer

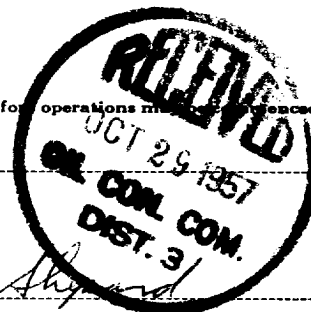

NEW MEXICO OIL CONSERVATION COMMISSION

Well Location and Acreage Dedication Plat

Section A.

Date August 20, 1957Operator SHELL OIL COMPANYLease L. M. Phillips #2 NM 036254

Gov't Well No. 31-9 Unit Letter B Section 9 Township 25 NORTH Range 12 WEST NMPM
 Located 620 Feet From the NORTH Line, 1830 Feet From the EAST Line
 County SAN JUAN G. L. Elevation 6201.12 Dedicated Acreage 40 Acres
 Name of Producing Formation Gallup Pool Bisti

1. Is the Operator the only owner in the dedicated acreage outlined on the plat below?

Yes X No

2. If the answer to question one is "no", have the interests of all the owners been consolidated by communitization agreement or otherwise? Yes No If answer is "yes", Type of Consolidation.

3. If the answer to question two is "no", list all the owners and their respective interests below:

Owner

Land Description

Section B.

Note: All distances must be from outer boundaries of section.

This is to certify that the information
 in Section A above is true and complete
 to the best of my knowledge and belief.

Shell Oil Company

(Operator)

B. W. Shepard

(Representative)

101 South Behrend

(Address)

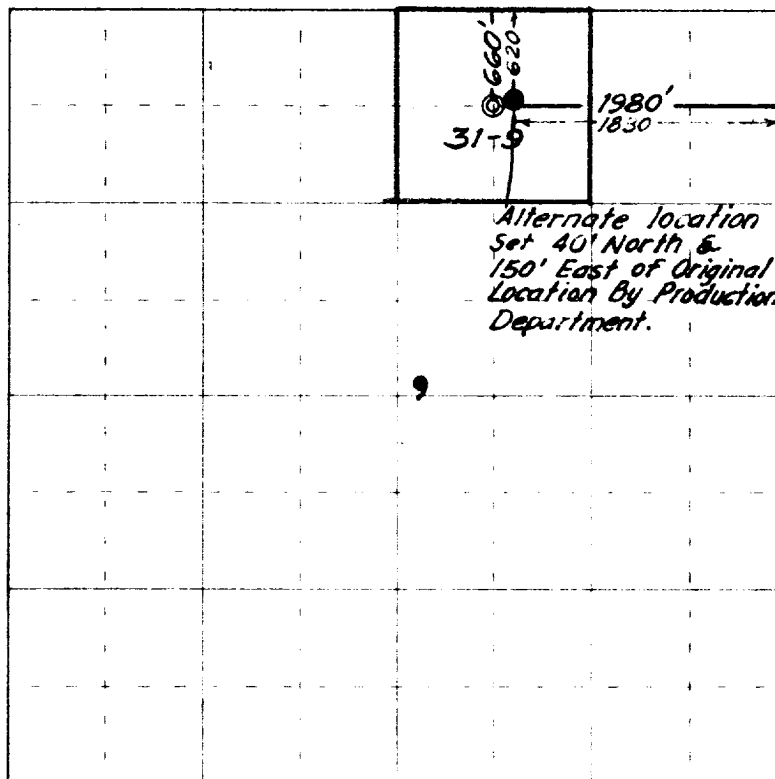
Farmington, New Mexico

0 330 660 990 1320 1650 1980 2310 2640 2000 1500 1000 500 0

Scale 4 inches equal 1 mile



This is to certify that the above plat was prepared from field notes of actual surveys
 made by me or under my supervision and that the same are true and correct to the best
 of my knowledge and belief.

(Seal)

Date Surveyed 19 AUGUST 1957

James P. Lasee
 Registered Professional Engineer and/or Land Surveyor
 James P. Lasee N. Mex. Reg. No. 1463

Farmington, New Mexico