

(SUBMIT IN TRIPLICATE)

Indian Agency 201-551-7271 ext. 3300 fax 201-551-7270 201-551-7271 ext. 3300 fax 201-551-7270 201-551-7271 ext. 3300 fax 201-551-7270

UNITED STATES
DEPARTMENT OF THE INTERIOR
GEOLOGICAL SURVEY

Window Rock

Allottee ~~44-38861-224~~

Lease No. **14-20-603-515**

Sec. 9

SUNDRY NOTICES AND REPORTS ON WELLS

NOTICE OF INTENTION TO DRILL	1	SUBSEQUENT REPORT OF WATER SHUT-OFF	<div style="text-align: right;"> RECEIVED OCT 29 1959 U. S. GEOLOGICAL SURVEY FARMINGTON, NEW MEXICO </div>
NOTICE OF INTENTION TO CHANGE PLANS		SUBSEQUENT REPORT OF SHOOTING OR ACIDIZING	
NOTICE OF INTENTION TO TEST WATER SHUT-OFF		SUBSEQUENT REPORT OF ALTERING CASING	
NOTICE OF INTENTION TO REDRILL OR REPAIR WELL		SUBSEQUENT REPORT OF REDRILLING OR REPAIR	
NOTICE OF INTENTION TO SHOOT OR ACIDIZE		SUBSEQUENT REPORT OF ABANDONMENT	
NOTICE OF INTENTION TO PULL OR ALTER CASING		SUPPLEMENTARY WELL HISTORY	
NOTICE OF INTENTION TO ABANDON WELL			

(INDICATE ABOVE BY CHECK MARK NATURE OF REPORT. NOTICE, OR OTHER DATA)

October 29. 19 59

Well No. 2 is located 330 ft. from N line and 2310 ft. from W line of sec. 9

NE/4 NE/4 NW/4 Sec. 9 25 N 19 W N.M.P.M.
(14 Sec. and Sec. No.) (Twp.) (Range) (Meridian)

Wildcat San Juan New Mexico
(Field) (County or Subdivision) (State or Territory)

The elevation of the ~~point~~^{G. L.} above sea level is 3993 ft.

DETAILS OF WORK

(State names of and expected depths to objective sands; show sizes, weights, and lengths of proposed casings; indicate mudding jobs, cementing points, and all other important proposed work)

It is intended:

To drill 9 7/8" hole to 80' and set 7 5/8" casing as surface pipe
W/50 sex regular.

To drill 6 3/4" hole w/mud to 2000' or through the Entrada and run logs. Entrada will be cored if necessary.

Completion procedure will be determined from core and log information.

I understand that this plan of work must receive approval in writing by the Geological Survey before operations may be commenced.

Company Drilling and Coring Exploration Co.

Address 1809 Laguna

~~Farmington, New Mexico~~

By Carl Warner

Title _____ **Partner** _____

Drilling & Coring Exploration Co.

L



NEW MEXICO OIL CONSERVATION COMMISSION
Well Location and Acreage Dedication Plat

Section A.

Date October 26, 1959

Operator DRILLING AND CORING EXPLORATION CO. Lease NAVAJO
Well No. 2 Unit Letter C Section 9 Township 25 N Range 19 W NMEP
Located 330 Feet From north Line, 2310 Feet From west Line
County San Juan G. L. Elevation 5993 Dedicated Acreage 40 Acres
Name of Producing Formation Entrada Pool Entrada

1. Is the Operator the only owner* in the dedicated acreage outlined on the plat below?
Yes ☒ No ☐
2. If the answer to question one is "no," have the interests of all the owners been consolidated by communitization agreement or otherwise? Yes ☒ No ☐. If answer is "yes," Type of Consolidation Federal
3. If the answer to question two is "no," list all the owners and their respective interests below:

Owner

Land Description

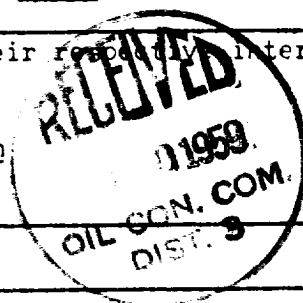

Section B

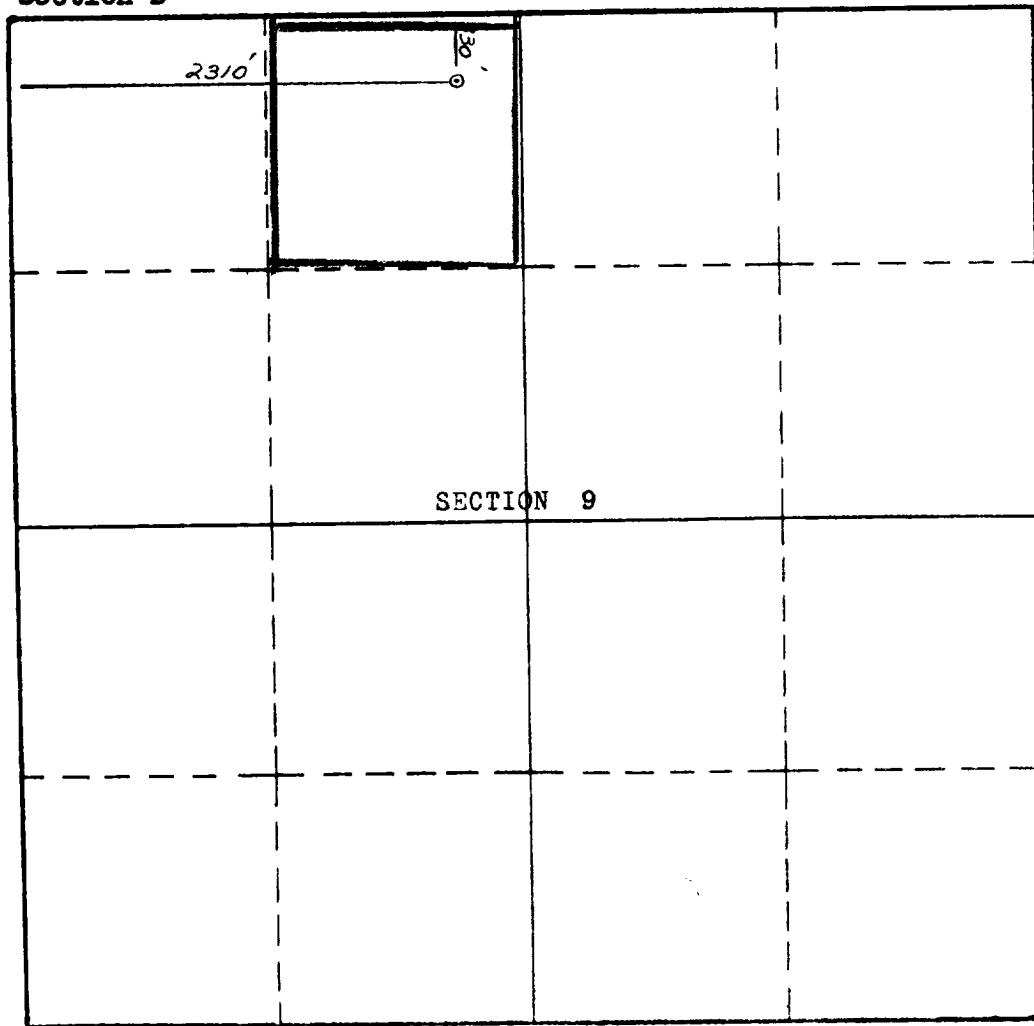

This is to certify that the information in Section A above is true and complete to the best of my knowledge and belief.

Drilling and Coring Exploration
(Operator) Co.

Edgar N. Lohman
(Representative)

1809 Laguna

Address

Farmington, New Mexico

This is to certify that the well location shown on the plat in Section B was plotted from field notes of actual surveys made by me or under my supervision and that the same is true and correct to the best of my knowledge and belief.

Date Surveyed Oct 28, 1959

Stephen H. K...
Registered Professional
Engineer and/or Land Surveyor.

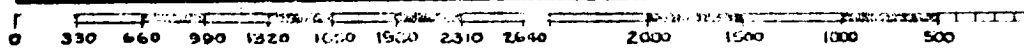

(See instructions for completing this form on the reverse side)

Certificate No. 803