



IN REPLY REFER TO:

UNITED STATES  
DEPARTMENT OF THE INTERIOR  
GEOLOGICAL SURVEY  
P. O. Box 965  
Farmington, New Mexico

COPY TO G.C.C.



May 18, 1956

Sunray Mid-Continent Oil Company  
Box 128  
Hobbs, New Mexico

Re: Santa Fe 078056

Gentlemen:

Receipt is acknowledged of your "Notice of Intention to Drill" dated May 16, 1956 covering your well No. 10 N.M. Federal "C" lease in SW 1/4 SE 1/4 sec. 6, T. 25 N., R. 12 W., N. M. P. M., San Juan County, New Mexico, Wildcat pool.

Your proposed work is hereby approved subject to compliance with the provisions of the "Oil and Gas Operating Regulations" revised May 25, 1942, a copy of which will be sent to you on request, and subject to the following conditions:

1. Drilling operations so authorized are subject to the attached sheet for general conditions of approval.
2. Furnish copies of all logs.

Very truly yours,

Jerry W. Long  
Acting District Engineer

J-Long:ac

UNITED STATES  
DEPARTMENT OF THE INTERIOR  
GEOLOGICAL SURVEY



TO THE DIRECTOR, GEOLOGICAL SURVEY, WASHINGTON, D. C.

FROM THE OIL COMPANY, DIST. -

SUBJECT: [Illegible]

RE: [Illegible]

DATE: [Illegible]

PLACE: [Illegible]

BY: [Illegible]

FOR: [Illegible]

BY: [Illegible]

FOR: [Illegible]

BY: [Illegible]

FOR: [Illegible]

BY: [Illegible]

FOR: [Illegible]

BY: [Illegible]

FOR: [Illegible]

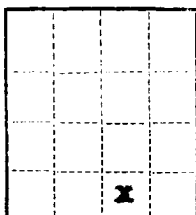

(SUBMIT IN TRIPLICATE)

UNITED STATES  
DEPARTMENT OF THE INTERIOR  
GEOLOGICAL SURVEY

Land Office Santa Fe  
Lease No. USA - 078056  
Unit 0

SUNDRY NOTICES AND REPORTS ON WELLS

NOTICE OF INTENTION TO DRILL.....	<input checked="" type="checkbox"/>	SUBSEQUENT REPORT OF WATER SHUT-OFF.....	
NOTICE OF INTENTION TO CHANGE PLANS.....		SUBSEQUENT REPORT OF SHOOTING OR ACIDIZING.....	
NOTICE OF INTENTION TO TEST WATER SHUT-OFF.....		SUBSEQUENT REPORT OF ALTERING CASING.....	
NOTICE OF INTENTION TO RE-DRILL OR REPAIR WELL.....		SUBSEQUENT REPORT OF RE-DRILLING OR REPAIR.....	
NOTICE OF INTENTION TO SHOOT OR ACIDIZE.....		SUBSEQUENT REPORT OF ABANDONMENT.....	
NOTICE OF INTENTION TO PULL OR ALTER CASING.....		SUPPLEMENTARY WELL HISTORY.....	
NOTICE OF INTENTION TO ABANDON WELL.....			

(INDICATE ABOVE BY CHECK MARK NATURE OF REPORT, NOTICE, OR OTHER DATA)

May 16, 1956

N. M. Federal "C" Lease

Well No. 10 is located 660 ft. from [S] line and 1980 ft. from [E] line of sec. 6

SW/4 of SE/4  
(1/4 Sec. and Sec. No.)

25N  
(Twp.)

12 W  
(Range)

(Meridian)

Dist. Gallup  
(Field)

San Juan  
(County or Subdivision)

New Mexico  
(State or Territory)

The elevation of the ~~derick floor~~ <sup>ground</sup> above sea level is 6209 ft.

DETAILS OF WORK

(State names of and expected depths to objective sands; show sizes, weights, and lengths of proposed casings; indicate mudding jobs, cementing points, and all other important proposed work)

We propose to drill this well with rotary tools to a sufficient depth to test the Gallup Sand expected at approximately 4840'. We propose to set 100' of 8 5/8" casing and cement to surface. We expect to drill through to the Gallup Sand section to a depth of approximately 5000' and if productive, set 5 1/2" casing through the zone and cement at least 300' above the top of the pay zone.

We propose to gun perforate the casing and sand oil frac during completion.

I understand that this plan of work must receive approval in writing by the Geological Survey before operations may be commenced.

Company Sunny Mid-Continent Oil Company

Address Box 128

Hobbs, New Mexico

By J. A. Parry

Title Hobbs Area Superintendent

NEW MEXICO  
OIL CONSERVATION COMMISSION

Form C-128

Well Location and/or Gas Proration Plat

Date 5-16-56

Operator Sunray Mid-Continent Oil Company

Lease N. M. Federal "C"

Well No. Federal C#10 Section 6 Township 25 North Range 12 West NMPM

Located 660 Feet From South Line, 1980 Feet From East Line,

San Juan County, New Mexico. G. L. Elevation 6209

Name of Producing Formation Gallup Sand Pool Bisti-Gallup Dedicated Acreage 40

(Note: All distances must be from outer boundaries of Section)

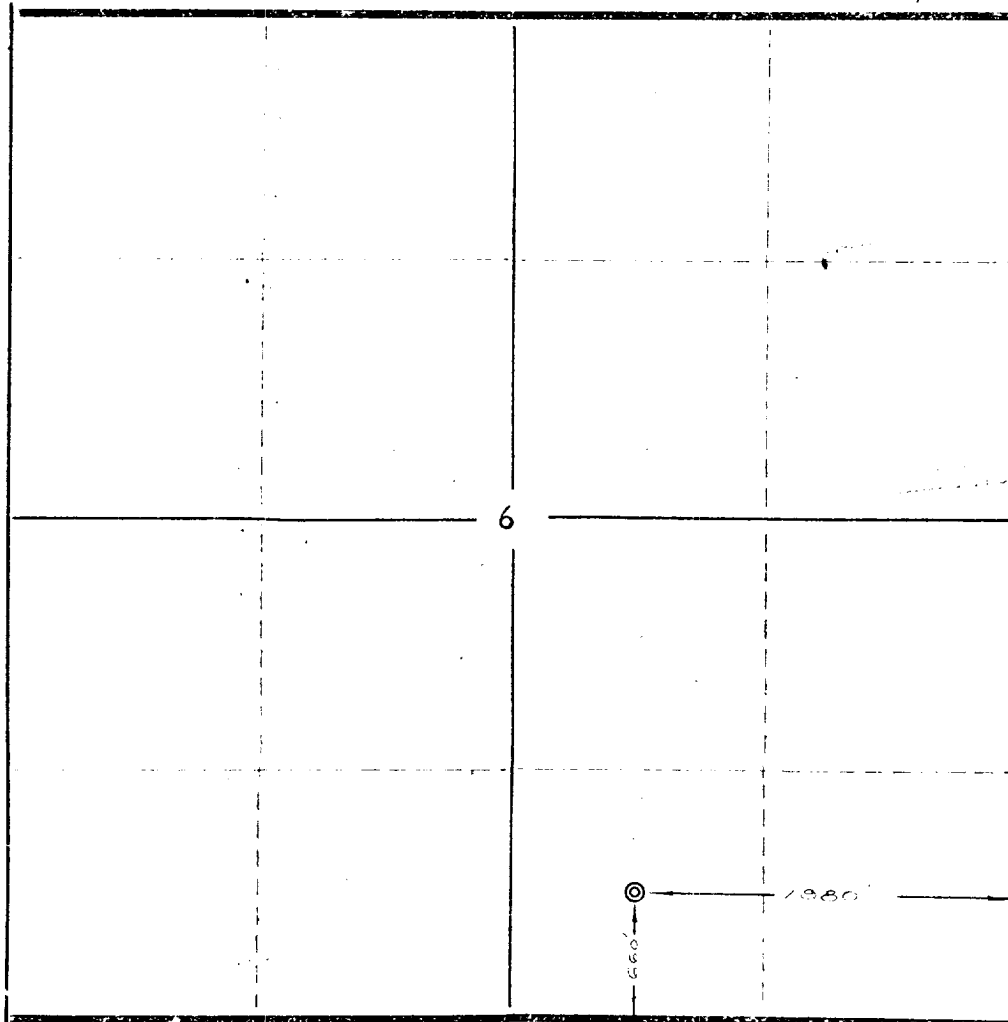

NOTE

This section of form is to be used for gas wells only.

SCALE: 1" = 1000'

1. Is this Well a Dual Comp. ? Yes No ☒
2. If the answer to Question 1 is yes; are there any other dually completed wells within the dedicated acreage?  
Yes No

Name J. A. Parry  
Position Hobbs Area Superintendent  
Representing Sunray Mid-Continent Oil Co.  
Address Box 128 - Hobbs, New Mexico

This is to certify that the above plat was prepared from field notes of actual surveys made by me or under my supervision and that the same are true and correct to the best of my knowledge and belief.

Date Surveyed May 4, 1956

Ernest V. Echohawk  
Reg. Land Surveyor, N. Mex., Reg. No. 1545