

(SUBMIT IN TRIPLICATE)

UNITED STATES
DEPARTMENT OF THE INTERIOR
GEOLOGICAL SURVEY

Land Office

Lease No.

Unit
Navajo Agency Contract
No. 14-20-603-744

SUNDRY NOTICES AND REPORTS ON WELLS

NOTICE OF INTENTION TO DRILL.....	<input checked="" type="checkbox"/>	SUBSEQUENT REPORT OF WATER SHUT-OFF.....
NOTICE OF INTENTION TO CHANGE PLANS.....		SUBSEQUENT REPORT OF SHOOTING OR ACIDIZING.....
NOTICE OF INTENTION TO TEST WATER SHUT-OFF.....		SUBSEQUENT REPORT OF ALTERING CASING.....
NOTICE OF INTENTION TO RE-DRILL OR REPAIR WELL.....		SUBSEQUENT REPORT OF RE-DRILLING OR REPAIR.....
NOTICE OF INTENTION TO SHOOT OR ACIDIZE.....		SUBSEQUENT REPORT OF ABANDONMENT.....
NOTICE OF INTENTION TO PULL OR ALTER CASING.....		SUPPLEMENTARY WELL HISTORY.....
NOTICE OF INTENTION TO ABANDON WELL.....		

(INDICATE ABOVE BY CHECK MARK NATURE OF REPORT, NOTICE, OR OTHER DATA)

March 8, 1960

Well No. 1 is located 660 ft. from {N} line and 1980 ft. from {W} line of sec. 3

NE NW 25N 14W N40W
(1/4 Sec. and Sec. No.) (Twp.) (Range) (Meridian)
San Juan New Mexico
(Field) (County or Subdivision) (State or Territory)

The elevation of the derrick floor above sea level is ft. (Will furnish later)

DETAILS OF WORK

(State names of and expected depths to objective sands; show sizes, weights, and lengths of proposed casings; indicate mudding jobs, cementing points, and all other important proposed work)

Gulf-Skelly Pinabete Navajo No. 1

It is proposed to drill a well to test the Morrison formation to an approximate total depth of 6000'. Approximately 300' of 8 5/8" ID Surface casing will be set and cemented to surface. If commercial production is encountered, 5 1/2" production string will be set. All possible productive zones will be adequately tested or evaluated by means of coring, DST's and E-log.

I understand that this plan of work must receive approval in writing by the Geological Survey before operations can be commenced.

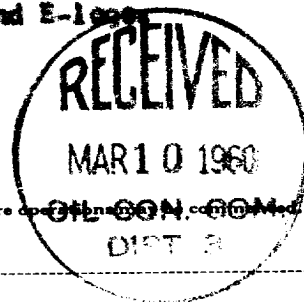

Company Gulf Oil Corporation

Address Production Department

P. O. Box 1346

Salt Lake City, Utah

ORIGINAL SIGNED

By T. A. TRAX

Title Area Production Manager

NEW MEXICO OIL CONSERVATION COMMISSION

Well Location and Acreage Dedication Plat

Section A.

Date March 11, 1960

Operator Gulf Oil Corporation Lease Pinabete Navajo
Well No. 1 Unit Letter 9 Section 3 Township 25 North Range 14 West NMPM
Located 660 Feet From North Line, 1960 Feet From West Line
County San Juan G. L. Elevation 6264 Dedicated Acreage 380 Acres
Name of Producing Formation _____ Pool Wildcat

1. Is the Operator the only owner* in the dedicated acreage outlined on the plat below?
Yes _____ No X
2. If the answer to question one is "no," have the interests of all the owners been consolidated by communitization agreement or otherwise? Yes X No _____. If answer is "yes,"
Type of Consolidation by means of Operating Agreement
3. If the answer to question two is "no," list all the owners and their respective interests below:

Owner

Land Description

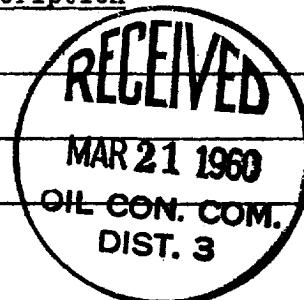

Section B

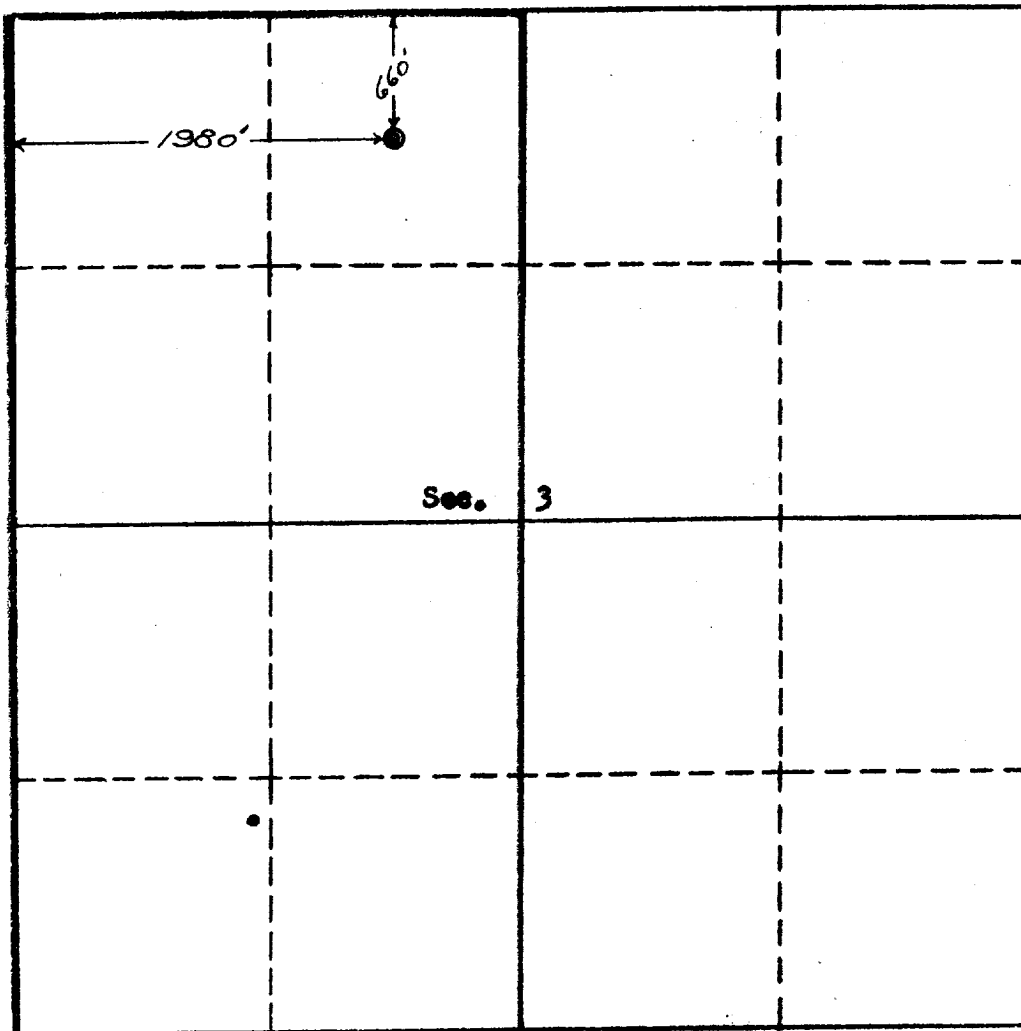

This is to certify that the information in Section A above is true and complete to the best of my knowledge and belief.

Gulf Oil Corporation
(Operator)

[Signature]
(Representative)

Prod. Dept. P. O. Box #1346
Salt Lake City, Utah
Address

This is to certify that the well location shown on the plat in Section B was plotted from field notes of actual surveys made by me or under my supervision and that the same is true to the best of my knowledge and belief.

Date Surveyed March 9, 1960

Ernest V. Echoshaw
Ernest V. Echoshaw
Registered Land Surveyor.

Certificate No. 1545

