

UNITED STATES
DEPARTMENT OF THE INTERIOR
GEOLOGICAL SURVEY

30-045-21247

APPLICATION FOR PERMIT TO DRILL, DEEPEN, OR PLUG BACK

1a. TYPE OF WORK

DRILL ☒DEEPEN ☐PLUG BACK ☐

b. TYPE OF WELL

OIL
WELL ☐GAS
WELL ☒

OTHER

SINGLE
ZONE ☒MULTIPLE
ZONE ☐

2. NAME OF OPERATOR

TENNECO OIL COMPANY

3. ADDRESS OF OPERATOR

Suite 1200 Lincoln Tower Bldg. Denver, Colo. 80203

4. LOCATION OF WELL (Report location clearly and in accordance with any State requirements.)*

At surface

1100' FSL and 1800' FEL

At proposed prod. zone

14. DISTANCE IN MILES AND DIRECTION FROM NEAREST TOWN OR POST OFFICE*

15. DISTANCE FROM PROPOSED*

LOCATION TO NEAREST

PROPERTY OR LEASE LINE, FT.

(Also to nearest drig. unit line, if any)

16. NO. OF ACRES IN LEASE

320

17. NO. OF ACRES ASSIGNED
TO THIS WELL

320

18. DISTANCE FROM PROPOSED LOCATION*
TO NEAREST WELL, DRILLING, COMPLETED,
OR APPLIED FOR, ON THIS LEASE, FT.

19. PROPOSED DEPTH

6120

20. ROTARY OR CABLE TOOLS

Rotary

21. ELEVATIONS (Show whether DF, RT, GR, etc.)

6356.0 GR

22. APPROX. DATE WORK WILL START*

upon approval

23.

PROPOSED CASING AND CEMENTING PROGRAM

SIZE OF HOLE	SIZE OF CASING	WEIGHT PER FOOT	SETTING DEPTH	QUANTITY OF CEMENT
12-1/4	8-5/8	24	600+	Sufficient to circulate
7-7/8	4-1/2	11.6	6120	Cement in two stages with sufficient cement to cover Dakota and Gallup in Lower Hole and possible productive zones in upper hole.

Drill 12-1/4" hole to T.D. of 600'+; run 8-5/8", 24#, casing and cement to surface. Drill out with 7-7/8" hole to approximate T.D. of 6120'. Log and test, if commercial production is indicated run 4-1/2", 11.6# casing to T.D. and cement as required. Perforate casing and treat formation as necessary. B.O.P. to be tested each 24 hours.

IN ABOVE SPACE DESCRIBE PROPOSED PROGRAM: If proposal is to deepen or plug back, give data on present productive zone and proposed new productive zone. If proposal is to drill or deepen directionally, give pertinent data on subsurface locations and measured and true vertical depths. Give blowout preventer program, if any.

24.

SIGNED

W L Shaver

TITLE Sr. Production Clerk

DATE Feb. 26, 1973

(This space for Federal or State office use)

PERMIT NO.

APPROVAL DATE

APPROVED BY

GA

TITLE

CONDITIONS OF APPROVAL, IF ANY:

RECEIVED

MAR 1 1973

U. S. GEOLOGICAL SURVEY
FARMINGTON, N. M.

*See Instructions On Reverse Side



**NEW MEXICO OIL CONSERVATION COMMISSION
WELL LOCATION AND ACERAGE DEDICATION PLAT**

All distances must be from the outer boundaries of the Section

Operator TENNECO OIL COMPANY		Lease CANYON		Well No 1
Unit Letter 0	Section 10	Township 25 NORTH	Range 11 WEST	County SAN JUAN
Actual Footage Location of Well: <div style="display: flex; justify-content: space-between;"> 1100 feet from the SOUTH line and 1800 feet from the EAST line </div>				
Ground Level Elev. 6356.0	Producing Formation DAKOTA	Pool BASIN DAKOTA	Dedicated Acreage 320	Acres

1. Outline the acreage dedicated to the subject well by colored pencil or hatchure marks on the plat below.
2. If more than one lease is dedicated to the well, outline each and identify the ownership thereof (both as to working interest and royalty),
3. If more than one lease of different ownership is dedicated to the well, have the interests of all owners been consolidated by communitization, unitization, force-pooling, etc?

() Yes () No If answer is "yes," type of consolidation

If answer is "no," list the owners and tract descriptions which have actually consolidated. (Use reverse side of this form if necessary.)

No allowable will be assigned to the well until all interests have been consolidated (by communitization, unitization, forced-pooling, or otherwise) or until a non standard unit, eliminating such interests, has been approved by the Commission.

CERTIFICATION

I hereby certify that the information contained herein is true and complete to the best of my knowledge and belief.

W L Shaver
 Name _____
W. L. Shaver
 Position _____
Sr. Production Clerk
 Company _____
TENNECO OIL CO.
 Date _____
2/26/73

I hereby certify that the well location shown on this plat was plotted from field notes of actual surveys made by me or under my supervision, and that the same is true and correct to the best of my knowledge and belief.

19th February, 1973
 Date _____
 Registered Professional Engineer
 and Land Surveyor
JAMES P. LEESE
 NEW MEXICO
 Certificate No. **10854**

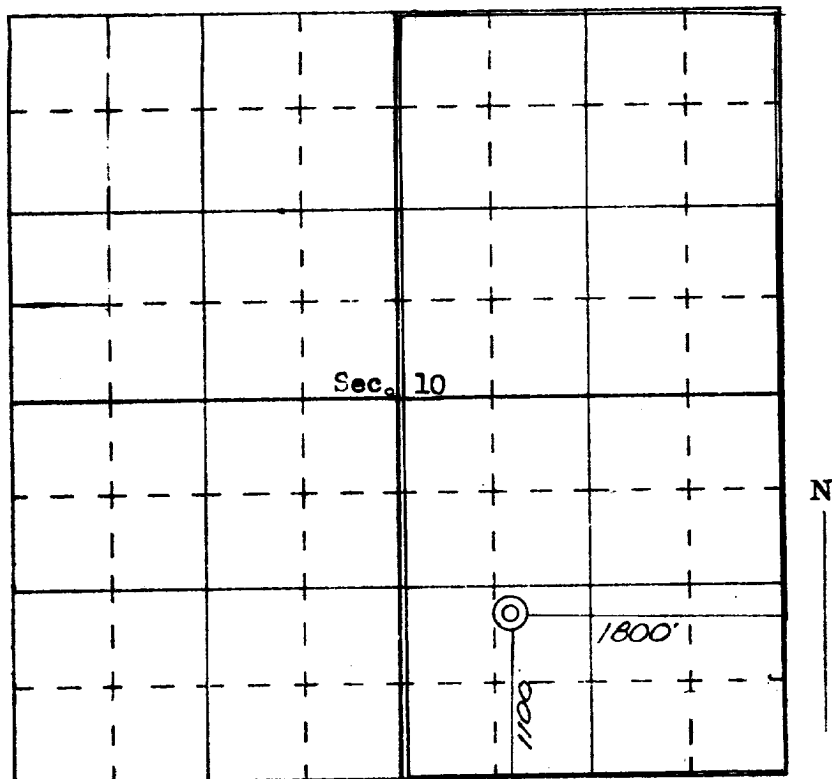

SCALE—4 INCHES EQUALS 1 MILE

SAN JUAN ENGINEERING COMPANY, FARMINGTON, N. M.