



Vicinity Map for
KIRBY EXPLORATION COMPANY #1-3 Federal
1160'FSL 790'FWL Sec 33-T25N-R8W
San Juan County, New Mexico

UNITED STATES
DEPARTMENT OF THE INTERIOR
GEOLOGICAL SURVEY

APPLICATION FOR PERMIT TO DRILL, DEEPEN, OR PLUG BACK

1a. TYPE OF WORK DRILL <input checked="" type="checkbox"/> DEEPEN <input type="checkbox"/> PLUG BACK <input type="checkbox"/>		5. LEASE DESIGNATION AND SERIAL NO. 4532-3
b. TYPE OF WELL OIL WELL <input type="checkbox"/> GAS WELL <input checked="" type="checkbox"/> OTHER <input type="checkbox"/> SINGLE ZONE <input checked="" type="checkbox"/> MULTIPLE ZONE <input type="checkbox"/>		6. IF INDIAN, ALLOTTEE OR TRIBE NAME
2. NAME OF OPERATOR Kirby Exploration Company		7. UNIT AGREEMENT NAME
3. ADDRESS OF OPERATOR P.O. Box 1745, Houston, Texas 77001		8. FARM OR LEASE NAME Federal 33
4. LOCATION OF WELL (Report location clearly and in accordance with any State requirements.)* At surface 1160' FSL & 790 FWL At proposed prod. zone Same		9. WELL NO. 1
14. DISTANCE IN MILES AND DIRECTION FROM NEAREST TOWN OR POST OFFICE* 6 1/2 miles NE of Nageezi, New Mexico		10. FIELD AND POOL, OR WILDCAT Wildcat
15. DISTANCE FROM PROPOSED* LOCATION TO NEAREST PROPERTY OR LEASE LINE, FT. (Also to nearest drlg. unit line, if any)	16. NO. OF ACRES IN LEASE 640	11. SEC., T., R., M., OR BLK. AND SURVEY OR AREA Sec 33 - 25N - 8W
18. DISTANCE FROM PROPOSED LOCATION* TO NEAREST WELL, DRILLING, COMPLETED, OR APPLIED FOR, ON THIS LEASE, FT.	19. PROPOSED DEPTH 2350	12. COUNTY OR PARISH San Juan
21. ELEVATIONS (Show whether DF, RT, GR, etc.) 6787 GL	17. NO. OF ACRES ASSIGNED TO THIS WELL 160	13. STATE New Mexico
20. ROTARY OR CABLE TOOLS Rotary		22. APPROX. DATE WORK WILL START* April 20, 1977

23. PROPOSED CASING AND CEMENTING PROGRAM				
SIZE OF HOLE	SIZE OF CASING	WEIGHT PER FOOT	SETTING DEPTH	QUANTITY OF CEMENT
12 1/4	8 5/8	20#	90'	50 sacks class "B" + 2% CaCl ₂
6 3/4	4 1/2	9.5#	2350'	200 sacks class "B"

Move in rotary tools. Drill 12 1/4 hole to 90 feet. Set 90 feet of new 8 5/8" casing and cement as above. Wait on cement 12 hours. Install 6" 900 series blow out preventers and test. Drill 6 3/4" hole to 2350 feet. No abnormal pressure or temperature is expected. Mud system will be gel-chem weighing 9-9 2# per gallon, W. L. 8-10 c.c. and viscosity of 30-40 seconds per quart. Open hole logging will consist of IES, FDC-CNL and GR Caliper logs. If commercial, 4 1/2" casing will be run and cemented as above. If non-commercial, plug and abandonment will follow U.S.G.S. specifications.

Gas under this lease is not committed to a contract.

IN ABOVE SPACE DESCRIBE PROPOSED PROGRAM: If proposal is to deepen or plug back, give data on present productive zone and proposed new productive zone. If proposal is to drill or deepen directionally, give pertinent data on subsurface locations and measured and true vertical depths. Give blowout preventer program, if any.

24. SIGNED John Alexander TITLE Agent DATE 3-24-77
(This space for Federal or State office use)

PERMIT NO. _____ APPROVAL DATE _____

APPROVED BY _____ TITLE _____ DATE _____
CONDITIONS OF APPROVAL, IF ANY:

*See Instructions On Reverse Side

NEW MEXICO OIL CONSERVATION COMMISSION
WELL LOCATION AND ACREAGE DEDICATION PLAT

Form C-102
Supersedes C-128
Effective 1-1-65

All distances must be from the outer boundaries of the Section.

Operator Kirby Exploration Company			Lease Federal		Well No. 1
Unit Letter M	Section 33	Township 25N	Range 8W	County San Juan	
Actual Footage Location of Well: 1160 feet from the South line and 790 feet from the West line					
Ground Level Elev. 6787	Producing Formation Pictured Cliff		Pool Wildcat		Dedicated Acreage: 160 Acres

1. Outline the acreage dedicated to the subject well by colored pencil or hachure marks on the plat below.
2. If more than one lease is dedicated to the well, outline each and identify the ownership thereof (both as to working interest and royalty).
3. If more than one lease of different ownership is dedicated to the well, have the interests of all owners been consolidated by communitization, unitization, force-pooling, etc?

☐ Yes ☐ No If answer is "yes," type of consolidation _____

If answer is "no," list the owners and tract descriptions which have actually been consolidated. (Use reverse side of this form if necessary.) _____

No allowable will be assigned to the well until all interests have been consolidated (by communitization, unitization, forced-pooling, or otherwise) or until a non-standard unit, eliminating such interests, has been approved by the Commission.

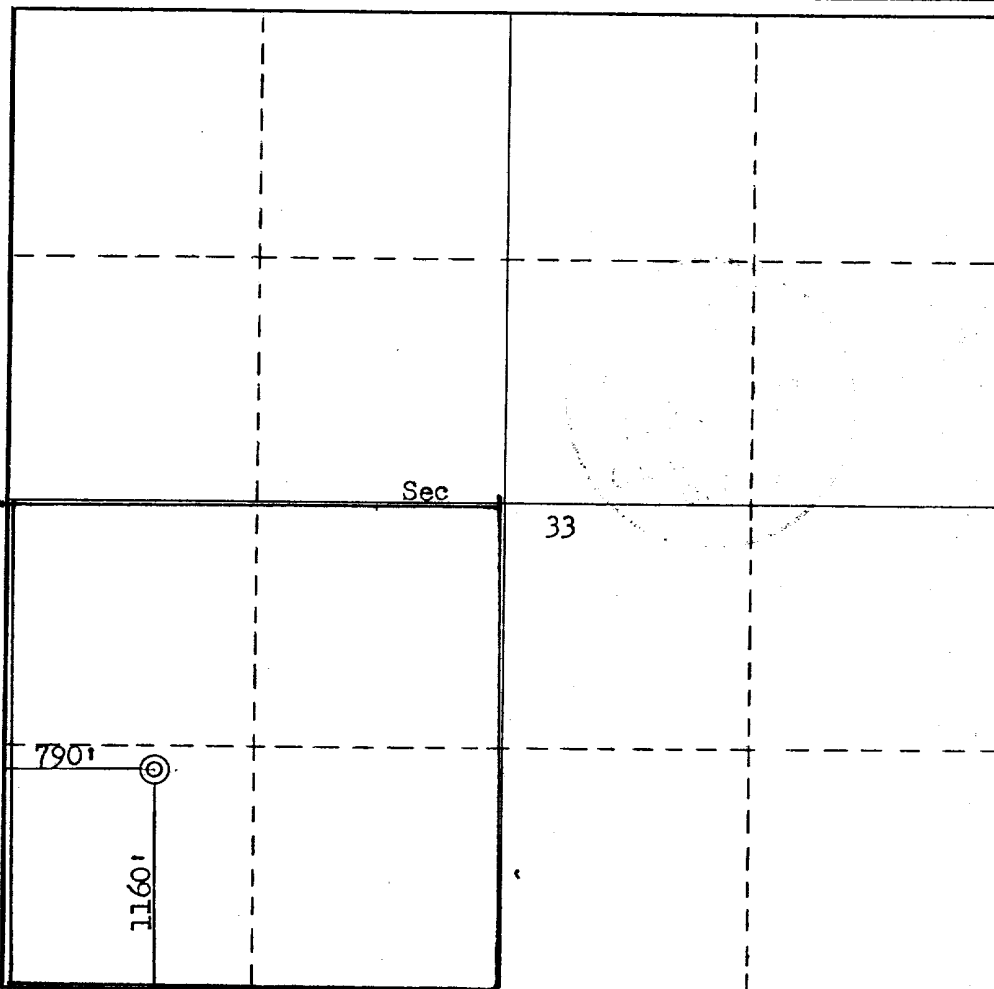

CERTIFICATION

I hereby certify that the information contained herein is true and complete to the best of my knowledge and belief.

John Alexander

Name

Agent

Position

Kirby Exploration Company

Company

3-24-77

Date

John Alexander

I hereby certify that the well location shown on this plat was plotted from field notes of actual surveys made by me or under my supervision, and that the same is true and correct to the best of my knowledge and belief.

Date Surveyed

March 11, 1977

Registered Professional Engineer and/or Land Surveyor

Fred B. Kerr, Jr.

Certificate No.

3950

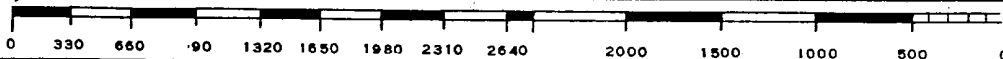

Well Site PLAT

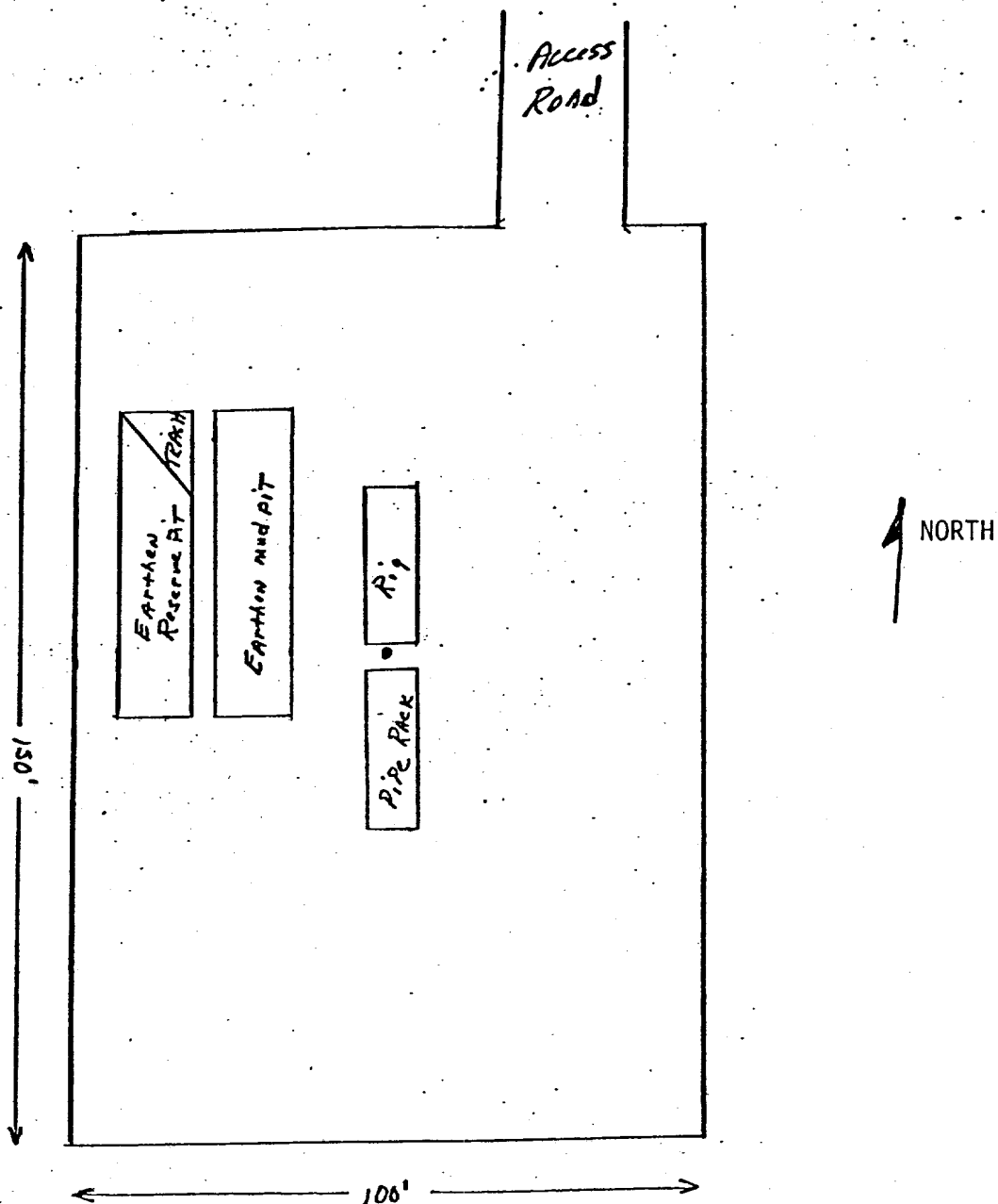

Scale 1" = 30'

Kirby Exploration Company
Federal #1-33
1160' FSL & 790' FWL
Sec 33 - 25N - 8W
San Juan County, New Mexico