

SUBMIT IN TRIPLICATE*
(Other instructions on reverse side)

Form approved.
Budget Bureau No. 42-R1425.

UNITED STATES
DEPARTMENT OF THE INTERIOR
GEOLOGICAL SURVEY

30-045-24827

APPLICATION FOR PERMIT TO DRILL, DEEPEN, OR PLUG BACK

1a. TYPE OF WORK

DRILL ☒

DEEPEN ☐

PLUG BACK ☐

b. TYPE OF WELL

OIL WELL ☐

GAS WELL ☒

OTHER

W.C.

SINGLE ZONE ☐

MULTIPLE ZONE ☐

2. NAME OF OPERATOR

Ludwick Exploration Co.

3. ADDRESS OF OPERATOR

P.O. Box 70

Farmington, New Mexico 87401

4. LOCATION OF WELL (Report location clearly and in accordance with any State requirements.)

At surface

1850' ESL, 970' FEL

At proposed prod. zone

Same

14. DISTANCE IN MILES AND DIRECTION FROM NEAREST TOWN OR POST OFFICE*

29 Miles SE Farmington, New Mexico

15. DISTANCE FROM PROPOSED*

LOCATION TO NEAREST PROPERTY OR LEASE LINE, FT. (Also to nearest drlg. unit line, if any)

970'

16. NO. OF ACRES IN LEASE

160

17. NO. OF ACRES ASSIGNED TO THIS WELL

160

18. DISTANCE FROM PROPOSED LOCATION* TO NEAREST WELL, DRILLING, COMPLETED, OR APPLIED FOR, ON THIS LEASE, FT.

200'

19. PROPOSED DEPTH

P&A Gallup

1400' Pictured Cliffs

20. ROTARY OR CABLE TOOLS

Rotary

21. ELEVATIONS (Show whether DF, RT, GR, etc.)

6449 Gr.

22. APPROX. DATE WORK WILL START*

10-1-1980

PROPOSED CASING AND CEMENTING PROGRAM

SIZE OF HOLE	SIZE OF CASING	WEIGHT PER FOOT	SETTING DEPTH	QUANTITY OF CEMENT
8-3/4	7	24#	90'	50 sx Circ
4-3/4	2-7/8	6.5#	1400'	200 sx Circ

"GENERAL REQUIREMENTS"

This action is subject to administrative appeal pursuant to 30 CFR 290.

SEE NTL-6 ATTACHMENTS

GAS NOT DEDICATED



IN ABOVE SPACE DESCRIBE PROPOSED PROGRAM: If proposal is to deepen or plug back, give data on present productive zone and proposed new productive zone. If proposal is to drill or deepen directionally, give pertinent data on subsurface locations and measured and true vertical depths. Give blowout preventer program, if any.

24.

SIGNED

James C. Kennedy

TITLE Agent

DATE 8-12-1980

(This space for Federal or State office use)

PERMIT NO.

APPROVAL DATE

APPROVED BY

CONDITIONS OF APPROVAL, IF ANY

TITLE

DATE

Barry Wamsley
S. F. E. M. S.
DISTRICT ENGINEER

*See Instructions On Reverse Side

NMOCC

All distances must be from the outer boundaries of the Section.

Operator LUDWICK EXPLORATION CO.			Lease ESKA-NEL-E-WOOD		Well No. 1
Unit Letter I	Section 22	Township 25N	Range 11W	County San Juan	
Actual Footage Location of Well: 1850 feet from the South line and 970 feet from the East line					
Ground Level Elev. 6449	Producing Formation Pictured Cliffs		Pool Wildcat Under		Dedicated Acreage: 160 Acres

1. Outline the acreage dedicated to the subject well by colored pencil or hatchure marks on the plat below.
2. If more than one lease is dedicated to the well, outline each and identify the ownership thereof (both as to working interest and royalty).
3. If more than one lease of different ownership is dedicated to the well, have the interests of all owners been consolidated by communitization, unitization, force-pooling, etc?

☐ Yes ☐ No If answer is "yes," type of consolidation _____

If answer is "no," list the owners and tract descriptions which have actually been consolidated. (Use reverse side of this form if necessary.) _____

No allowable will be assigned to the well until all interests have been consolidated (by communitization, unitization, forced-pooling, or otherwise) or until a non-standard unit, eliminating such interests, has been approved by the Commission.

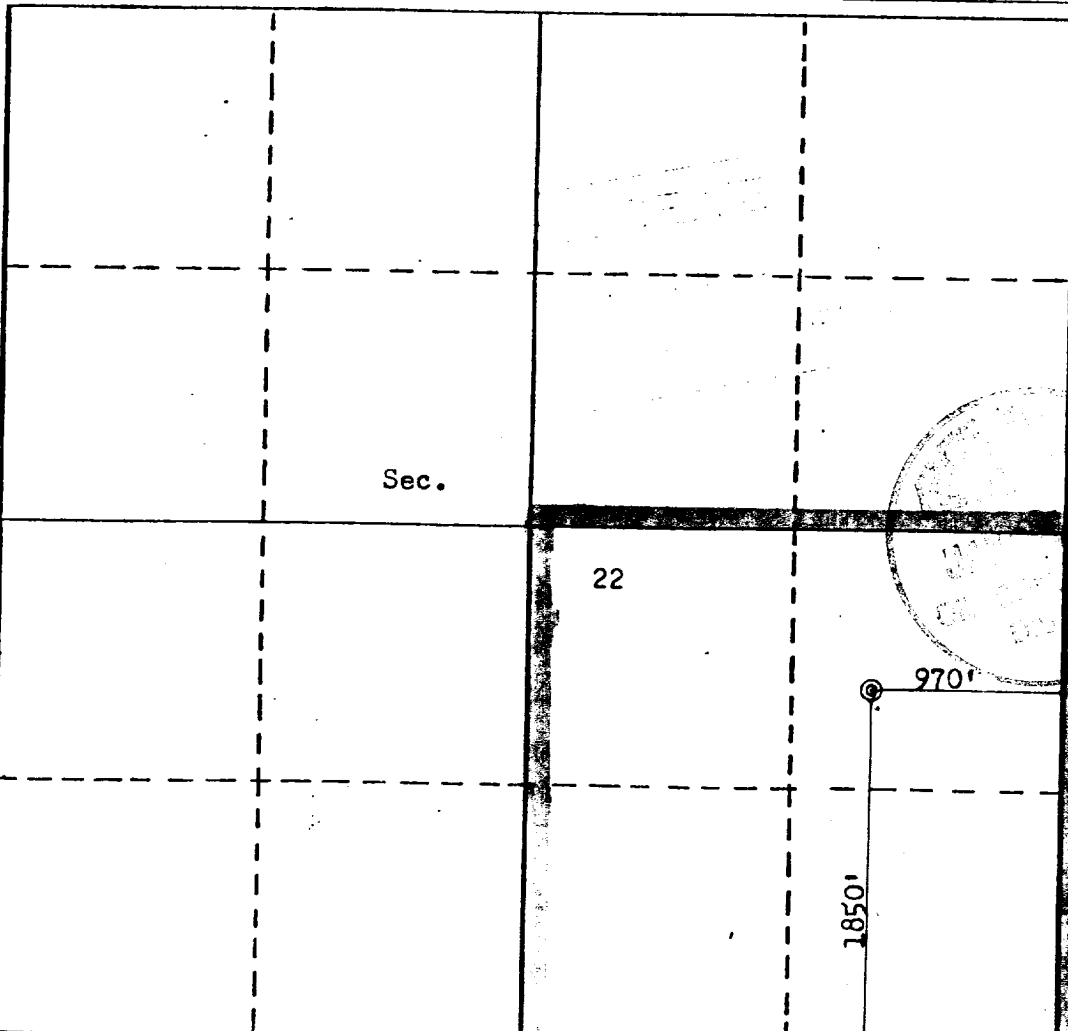

CERTIFICATION

I hereby certify that the information contained herein is true and complete to the best of my knowledge and belief.

Name **Claude C. Kennedy**

Position **Agent**

Company **Ludwick Exploration Co.**

Date **8-12-1980**

I hereby certify that the well location shown on this plat was plotted from field notes of actual surveys made by me or under my supervision, and that the same is true and correct to the best of my knowledge and belief.

Date Surveyed **August 14, 1980**

Registered Professional Engineer

and/or Land Surveyor
22
32
1980
Ed B. Kerr Jr.

Certificate No. **1980**