

STATE OF NEW MEXICO
ENERGY AND MINERALS DEPARTMENT

U.S. DEPARTMENT OF THE INTERIOR
BUREAU OF LAND MANAGEMENT
U.S. CONSERVATION DIVISION
P. O. BOX 2088
SANTA FE, NEW MEXICO 87501

Form C-102
Revised 10-1-78

All distances must be from the outer boundaries of the Section.

Operator Hixon Development Company		Lease Hixon Federal		Well No. 1-J	
Well Letter B	Section 4	Township 25 North	Range 12 West	County San Juan	
Actual Footage Location of Well: 870 feet from the North line and 1450 feet from the East line					
Ground Level Elev. 6160	Producing Formation Pictured Cliffs	Pool WAW Fruitland Sand-Pictured Cliffs		Dedicated Acreage: 160 Acres	

1. Outline the acreage dedicated to the subject well by colored pencil or hatchure marks on the plat below.
2. If more than one lease is dedicated to the well, outline each and identify the ownership thereof (both as to working interest and royalty).
3. If more than one lease of different ownership is dedicated to the well, have the interests of all owners been consolidated by communitization, unitization, force-pooling, etc?

☐ Yes ☐ No If answer is "yes," type of consolidation _____

If answer is "no," list the owners and tract descriptions which have actually been consolidated. (Use reverse side of this form if necessary.) _____

No allowable will be assigned to the well until all interests have been consolidated (by communitization, unitization, forced-pooling, or otherwise) or until a non-standard unit, eliminating such interests, has been approved by the Division.

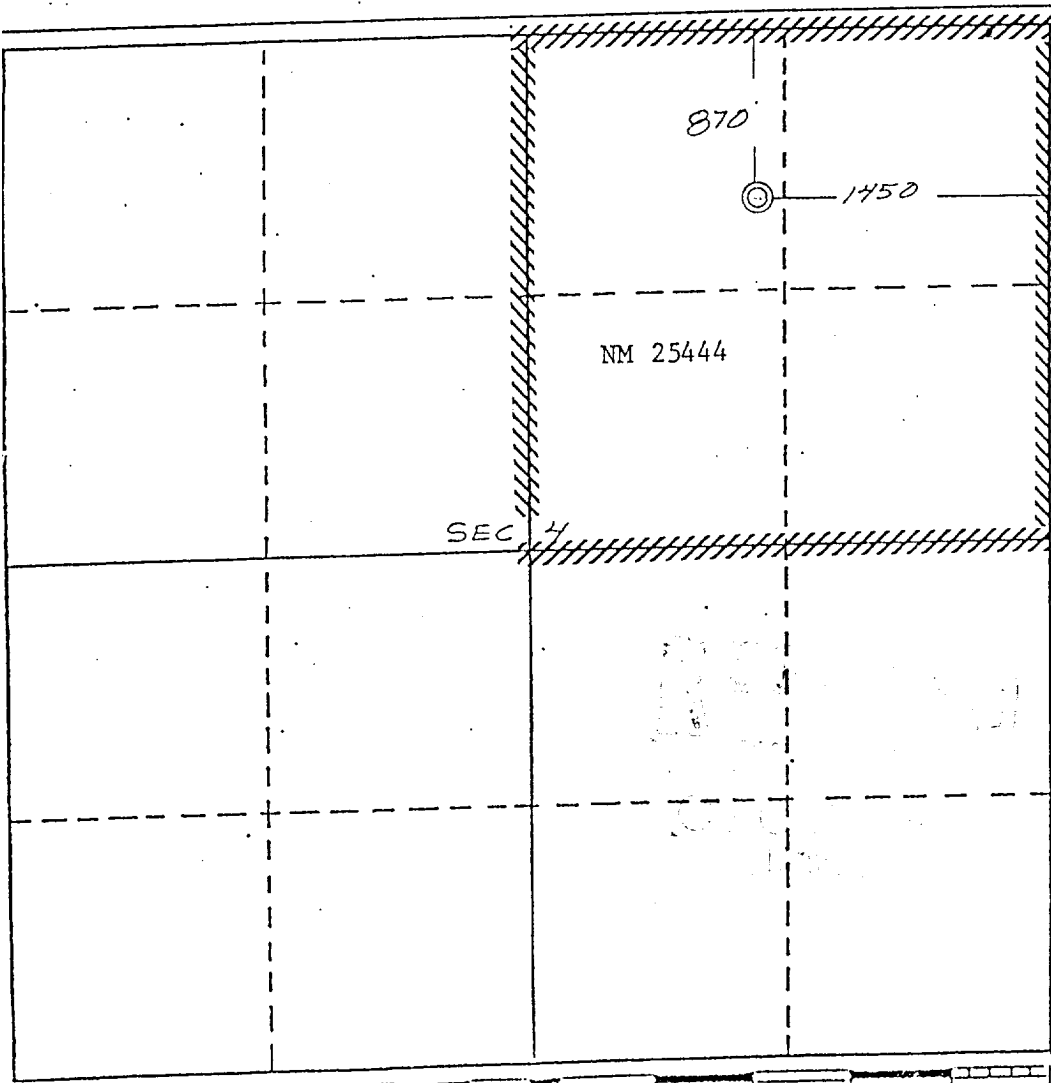

CERTIFICATION

I hereby certify that the information contained herein is true and complete to the best of my knowledge and belief.

Aldrich L. Kuchera

Name
Aldrich L. Kuchera
Position
Petroleum Engineer
Company
Hixon Development Company

Date
April 6, 1983

I hereby certify that the well location shown on this plat was plotted from field notes of actual survey made by me or under my supervision and that the same is true and correct to the best of my knowledge and belief.

Date Surveyed
March 29, 1983
Registered Professional Engineer
and/or Land Surveyor

Edgar L. Risenhoover
Certificate No. 5979
Edgar L. Risenhoover, L.S.