

UNITED STATES  
DEPARTMENT OF THE INTERIOR  
BUREAU OF LAND MANAGEMENT

APPLICATION FOR PERMIT TO DRILL, DEEPEN, OR PLUG BACK

1a. TYPE OF WORK

DRILL ☒

DEEPEN ☐

PLUG BACK ☐

b. TYPE OF WELL

OIL  
WELL ☒

GAS  
WELL ☐

OTHER

SINGLE  
ZONE ☒

MULTIPLE  
ZONE ☐

2. NAME OF OPERATOR

Hixon Development Company

3. ADDRESS OF OPERATOR

P.O. Box 2810, Farmington, N.M. 87499

4. LOCATION OF WELL (Report location clearly and in accordance with any State requirements.)\*

At surface

1650' FSL, 330' FEL, Sec. 26, T25N, R12W

At proposed prod. zone Same

14. DISTANCE IN MILES AND DIRECTION FROM NEAREST TOWN OR POST OFFICE\*

25 miles southwest of Farmington

15. DISTANCE FROM PROPOSED\*  
LOCATION TO NEAREST  
PROPERTY OR LEASE LINE, FT.  
(Also to nearest drlg. unit line, if any)

330'

16. NO. OF ACRES IN LEASE

80

18. DISTANCE FROM PROPOSED LOCATION\*  
TO NEAREST WELL, DRILLING, COMPLETED,  
OR APPLIED FOR, ON THIS LEASE, FT.

850'

19. PROPOSED DEPTH

4940'

17. NO. OF ACRES ASSIGNED  
TO THIS WELL

N 80

20. ROTARY OR CABLE TOOLS

Rotary

21. ELEVATIONS (Show whether DF, RT, GR, etc.)

6405' GLE

DRILLING OPERATIONS AUTHORIZED ARE  
SUBJECT TO COMPLIANCE WITH ATTACHED

22. APPROX. DATE WORK WILL START\*

November 1, 1988

23. "GENERAL REQUIREMENTS"  
PROPOSED CASING AND CEMENTING PROGRAM

This notice is subject to the  
procedural review pursuant to 43 CFR 3160.3  
and approved pursuant to 43 CFR 3160.4.

SIZE OF HOLE	SIZE OF CASING	WEIGHT PER FOOT	SETTING DEPTH	QUANTITY OF CEMENT
12-1/4"	8-5/8"	24#	260'	175 sks.
7-7/8"	5-1/2"	15.5#	4940'	600 sks.

It is proposed to drill the subject Bisti Lower Gallup Pool oil well. It will be evaluated on the basis of open hole logs. Please see attached Onshore Oil and Gas Order No. 1 data.

RECEIVED  
FEB 17 1989  
OIL CON. DIV.  
DIST. 3

IN ABOVE SPACE DESCRIBE PROPOSED PROGRAM: If proposal is to deepen or plug back, give data on present productive zone and proposed new productive zone. If proposal is to drill or deepen directionally, give pertinent data on subsurface locations and measured and true vertical depths. Give blowout preventer program, if any.

24.

SIGNED

*Michael D. Haddenham*  
Michael D. Haddenham

TITLE

Engineering Manager

DATE September 23, 1988

(This space for Federal or State office use)

PERMIT NO.

APPROVAL DATE

APPROVED BY

TITLE

DATE

CONDITIONS OF APPROVAL, IF ANY:

APPROVED  
AS AMENDED

FEB 14 1989  
*K. Fule*  
AREA MANAGER

\*See Instructions On Reverse Side

All distances must be from the outer boundaries of the Section.

Operator Hixon Development Company		Lease Dodd Geiger		Well No. 1
Unit Letter 1	Section 26	Township 25 North	Range 12 West	County San Juan
Actual Footage Location of Well: 1650 feet from the South line and 330 feet from the East line				
Ground Level Elev. 6405	Producing Formation Gallup	Pool Bisti Gallup <i>EXT</i>	Dedicated Acreage: 80 Acres	

1. Outline the acreage dedicated to the subject well by colored pencil or hatchure marks on the plat below.
2. If more than one lease is dedicated to the well, outline each and identify the ownership thereof (both as to working interest and royalty).
3. If more than one lease of different ownership is dedicated to the well, have the interests of all owners been consolidated by communitization, unitization, force-pooling, etc?

☐ Yes ☐ No If answer is "yes," type of consolidation \_\_\_\_\_

If answer is "no," list the owners and tract descriptions which have actually been consolidated. (Use reverse side of this form if necessary.) \_\_\_\_\_

No allowable will be assigned to the well until all interests have been consolidated (by communitization, unitization, forced-pooling, or otherwise) or until a non-standard unit, eliminating such interests, has been approved by the Division.

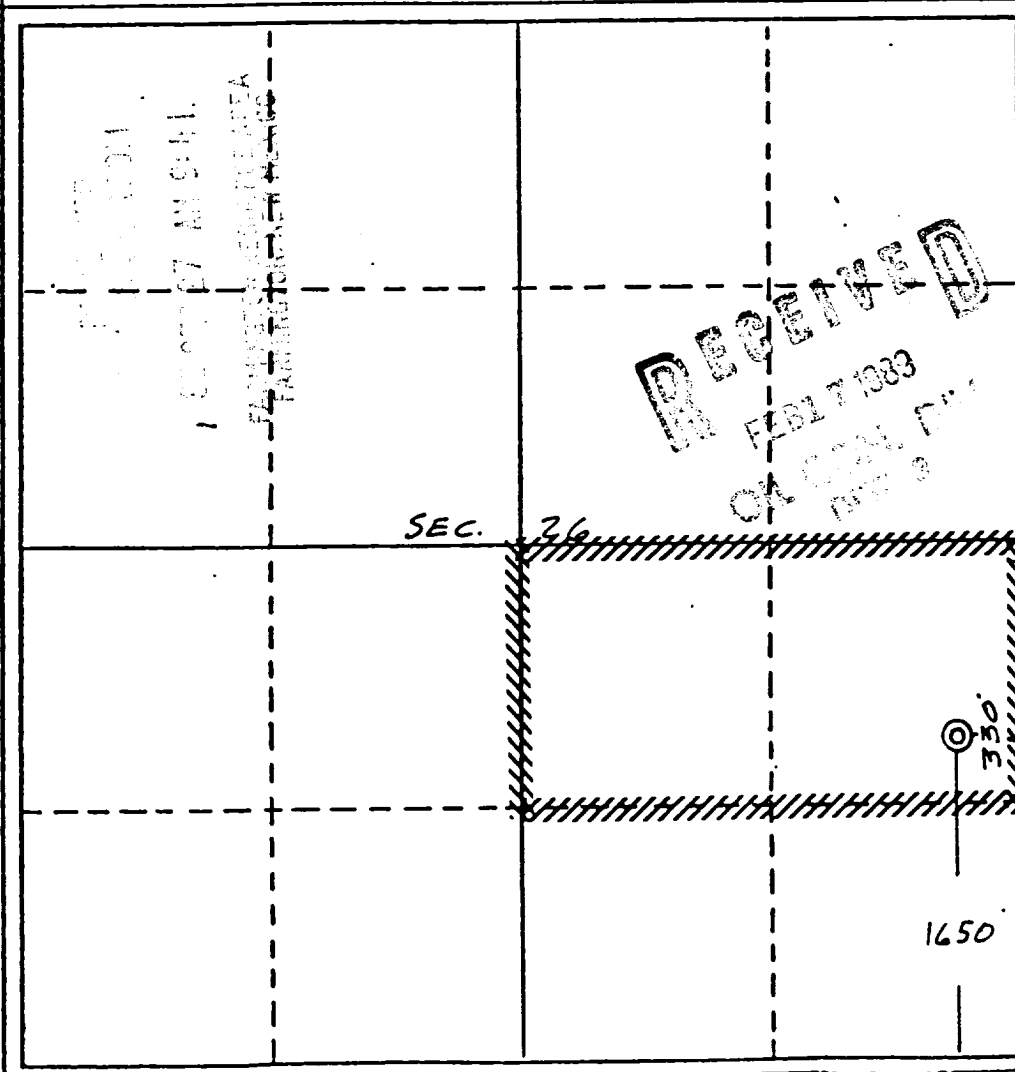

#### CERTIFICATION

I hereby certify that the information contained herein is true and complete to the best of my knowledge and belief.

*John C. Corbett*  
Name

John C. Corbett

Position

Vice President - Exploration

Company

Hixon Development Company

Date

September 14, 1988

*Edgar L. Risenbauer*  
I hereby certify that the location shown on this plat was obtained from field notes or actual surveys made by me or under my supervision, and that the same is true and correct to the best of my knowledge and belief.

Date Surveyed

April 8, 1987

Registered Professional Engineer  
and/or Land Surveyor

*Edgar L. Risenbauer*  
Certificate No. 5979

