

(SUBMIT IN TRIPLICATE)

UNITED STATES
DEPARTMENT OF THE INTERIOR
GEOLOGICAL SURVEY

Land Office **Santa Fe**
079107

Lease No. _____
Unit **NE/4 Sec. 25 is**
Designated Drilling Unit

RECEIVED

MEXICO

SUNDRY NOTICES AND REPORTS ON WELLS

NOTICE OF INTENTION TO DRILL	<input checked="" type="checkbox"/>	SUBSEQUENT REPORT OF WATER SHUT-OFF
NOTICE OF INTENTION TO CHANGE PLANS		SUBSEQUENT REPORT OF SHOOTING OR ACIDIZING
NOTICE OF INTENTION TO TEST WATER SHUT-OFF		SUBSEQUENT REPORT OF ALTERING CASING
NOTICE OF INTENTION TO RE-DRILL OR REPAIR WELL		SUBSEQUENT REPORT OF REDRILLING OR REPAIR
NOTICE OF INTENTION TO SHOOT OR ACIDIZE		SUBSEQUENT REPORT OF ABANDONMENT
NOTICE OF INTENTION TO PULL OR ALTER CASING		SUPPLEMENTARY WELL HISTORY
NOTICE OF INTENTION TO ABANDON WELL		

(INDICATE ABOVE BY CHECK MARK NATURE OF REPORT, NOTICE, OR OTHER DATA)

June 22nd, 1955

Well No. 10 is located 900 ft. from N line and 900 ft. from E line of sec. 25

NE/4 NE/4 Sec. 25
(1/4 Sec. and Sec. No.)

26N
(Twp.)

7W
(Range)

N.M.P.M.
(Meridian)

South Blanco P.C. (Ext)
(Field)

Rio Arriba
(County or Subdivision)

New Mexico
(State or Territory)

The elevation of the derrick floor above sea level is _____ ft. (Not available.
Will furnish later)

DETAILS OF WORK

(State names of and expected depths to objective sands; show sizes, weights, and lengths of proposed casings; indicate mudding jobs, cementing points, and all other important proposed work)

Pictured Cliffs Sand test. Estimated total depth 2300'.

Surface Casing: 90' of 8-5/8" OD 24# J-55 casing cemented with 80 sacks.

Production " : Approximately 2200' of 5-1/2" OD 14# J-55 casing cemented with 100 sacks.

If commercial production is indicated, the producing section will be shot with nitroglycerin and/or sand-oil treated.

I understand that this plan of work must receive approval in writing by the Geological Survey before operations may be commenced.

Company CANDADO PRODUCTION COMPANY

Address 1400 Luhrs Tower

Phoenix, Arizona

By

George Starks

Title President

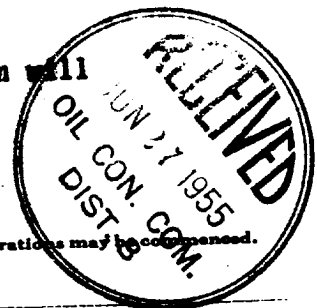

Company Huerfanito Drilling Co.

Lease _____ Well No. _____

Sec. 25 T. 26 N R. 7 W N.W.P.M.

Location 900 feet from north line, 900 feet from east line

Elevation: _____

Rio Arriba County

New Mexico

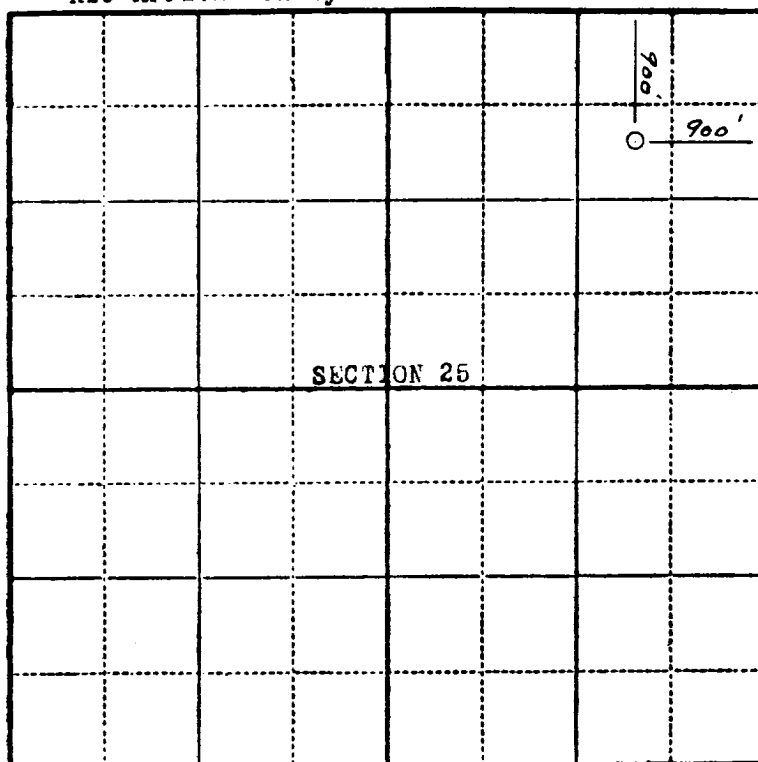

Scale—4 inches equal 1 mlie.

This is to certify that the above plat was prepared from field notes of actual surveys made by me or under my supervision and that the same are true and correct to the best of my knowledge and belief.

Stephen H. Kinney

STEPHEN H. KINNEY
Registered Professional
Engineer and Land Surveyor

Surveyed June 18, 19 55

Seal:

RECEIVED
JUN 21 1955
U.S. GEOLOGICAL SURVEY
FARMINGTON, NEW MEXICO