

(SUBMIT IN TRIPLICATE)

UNITED STATES
DEPARTMENT OF THE INTERIOR
GEOLOGICAL SURVEY

Land Office Santa Fe
Lease No. 07504
Unit Hughes

SUNDRY NOTICES AND REPORTS ON WELLS

NOTICE OF INTENTION TO DRILL	<input checked="" type="checkbox"/>	SUBSEQUENT REPORT OF WATER SHUT-OFF	
NOTICE OF INTENTION TO CHANGE PLANS		SUBSEQUENT REPORT OF SHOOTING OR ACIDIZING	
NOTICE OF INTENTION TO TEST WATER SHUT-OFF		SUBSEQUENT REPORT OF ALTERING CASING	
NOTICE OF INTENTION TO RE-DRILL OR REPAIR WELL		SUBSEQUENT REPORT OF RE-DRILLING OR REPAIR	
NOTICE OF INTENTION TO SHOOT OR ACIDIZE		SUBSEQUENT REPORT OF ABANDONMENT	
NOTICE OF INTENTION TO PULL OR ALTER CASING		SUPPLEMENTARY WELL HISTORY	
NOTICE OF INTENTION TO ABANDON WELL			

(INDICATE ABOVE BY CHECK MARK NATURE OF REPORT, NOTICE, OR OTHER DATA)

December 31, 1950

Well No. 4-29 is located 500 ft. from N line and 950 ft. from E line of sec. 29

NE Section 29

(1/4 Sec. and Sec. No.)

24N

(Twp.)

7N

(Range)

14W

(Meridian)

Belmont P.C. Co.

(Field)

Rio Arriba

(County or Subdivision)

New Mexico

(State or Territory)

The elevation of the derrick floor above sea level is 6930 ft.

DETAILS OF WORK

(State names of and expected depths to objective sands; show sizes, weights, and lengths of proposed casings; indicate mudding jobs, cementing points, and all other important proposed work)

It is intended to drill a well thru the Pictured Cliff formation using rotary tools and to perforate and water fracture possible producing zones. Estimated T.D. 3010'.

Casing Program:

9 5/8" at 120' with 125 sacks regular cement circulated to surface.
5 1/2" at 3010' with 75 sacks regular cement, 75 sacks regular.

The NE 1/4 of Section 29 is dedicated to this well.
NE 1/4 F 075040.

I understand that this plan of work must receive approval in writing by the Geological Survey before operations may be commenced.

Company El Paso Natural Gas Company

Address Box 937

Farmington, New Mexico

By

Title Petroleum Engineer

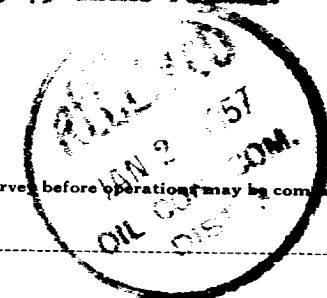

Original Signed EWELL N. WALSH

NEW MEXICO
OIL CONSERVATION COMMISSION

Form C-128

Well Location and/or Gas Proration Plat

Date _____

Operator EL PASO NATURAL GAS COMPANY Lease ~~Hughes~~

Well No. 4-29 Section 29 Township 26 NORTH Range 7 WEST, NMPM

Located 800 Feet From the NORTH Line, 950 Feet From the EAST Line,

RIO ARRIBA County, New Mexico. G. L. Elevation 6919.6 UNGRADED.

Name of Producing Formation ~~Pictured Cliffs~~ Canyon Largo Pool ~~Ballard E. t.~~ Dedicated Acreage 160

(Note: All distances must be from outer boundaries of Section)

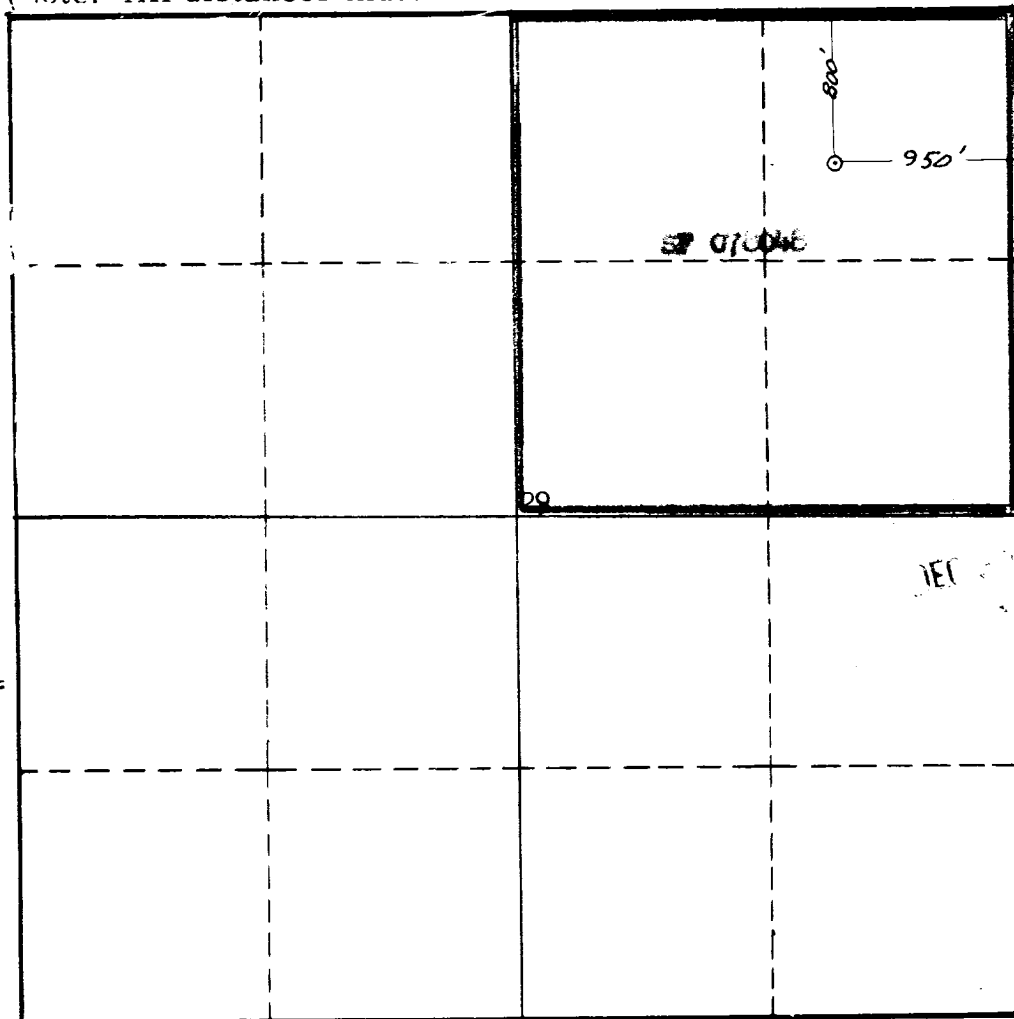

NOTE

This section of
form is to be
used for gas
wells only.



SCALE: 1"=1000'

1. Is this Well a Dual Comp.? Yes No A.
2. If the answer to Question 1 is yes, are there any other dually completed wells within the dedicated acreage? Yes No.

Name Original Signed EWELL N. WALSH
Position Petroleum Engineer
Representing El Paso Natural Gas Co.
Address Box 991, Farmington, N.M.

This is to certify that the above plat was prepared from field notes of actual surveys made by me or under my supervision and that the same are true and correct to the best of my knowledge and belief.

Date Surveyed 10 OCTOBER 1956
James P. Leese
Registered Professional Engineer and/or
Land Surveyor James P. Leese
N. Mex. Reg. No. 1463