

NEW MEXICO OIL CONSERVATION COMMISSION

Well Location and Acreage Dedication Plat

Section A.

Date **NOVEMBER 13, 1957**

Operator **EL PASO NATURAL GAS COMPANY** Lease **SAN JUAN 27-4 UNIT** SF **080670**
 Well No. **10** Unit Letter **G** Section **32** Township **27 N** Range **4 W** NMPM
 Located **1840** Feet From **NORTH** Line, **1500** Feet From **EAST** Line
 County **RIO ARRIBA** G. L. Elevation **6845** Dedicated Acreage **320** Acres
 Name of Producing Formation **PICTURED CLIFF** Pool **TAPACITO - P.C.**

1. Is the Operator the only owner in the dedicated acreage outlined on the plat below?
 Yes ☒ No ☐
2. If the answer to question one is "no", have the interests of all the owners been consolidated by communization agreement or otherwise? Yes ☐ No ☐ . If answer is "yes", Type of Consolidation.

3. If the answer to question two is "no", list all the owners and their respective interests below:

Owner

Land Description

RECEIVED
NOV 20 1957
 OIL SURVEY
 NEW MEXICO

Section B.

Note: All distances must be from outer boundaries of section.

This is to certify that the information in Section A above is true and complete to the best of my knowledge and belief.

El Paso Natural Gas Company
 (Operator)

Original Signed D. C. Johnson
 (Representative)

Box 997
 (Address)

Farmington, New Mexico

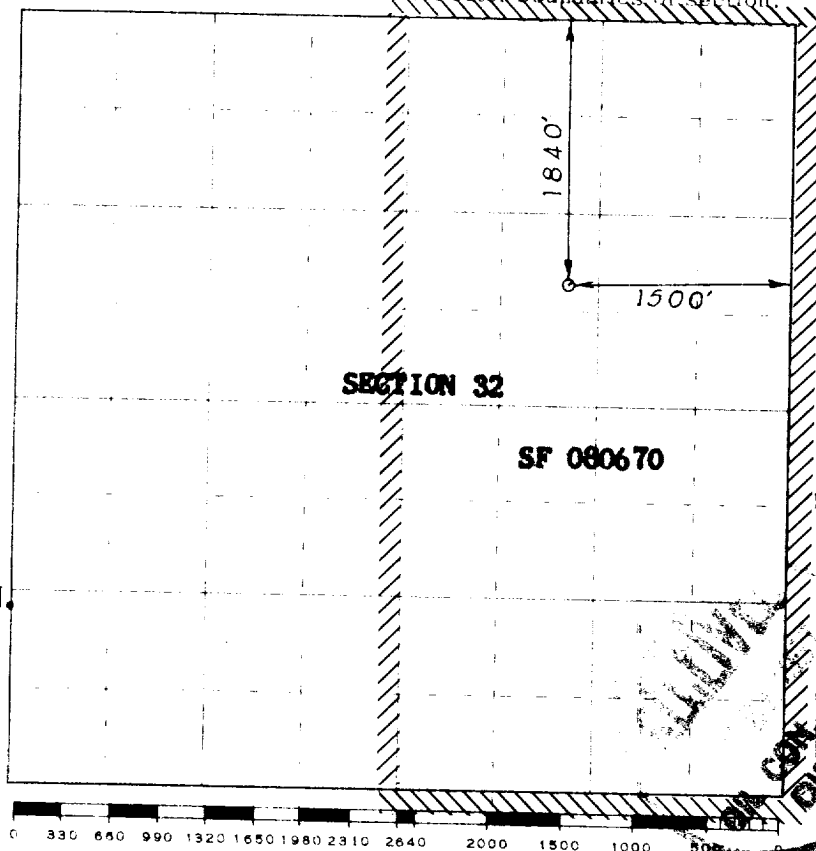

NOTE: THIS PLAT RE-ISSUED TO SHOW CORRECTED ACREAGE DEDICATION.

Scale 4 inches equal 1 mile

This is to certify that the above plat was prepared from field notes of actual surveys made by me or under my supervision and that the same are true and correct to the best of my knowledge and belief.

(Seal)

Farmington, New Mexico

Date Surveyed **MAY 13, 1957**

E. O. Walker
 Registered Professional Engineer and/or Land Surveyor