

(SUBMIT IN TRIPLICATE)

UNITED STATES
DEPARTMENT OF THE INTERIOR
GEOLOGICAL SURVEY

30-039-06850

Budget Bureau No. 42-R359.4
Approval expires 12-31-60.

Indian Agency Alamogordo Tribal

Contract #95 Trust #184

Allottee _____

Lease No. Alamogordo #0

SUNDRY NOTICES AND REPORTS ON WELLS

NOTICE OF INTENTION TO DRILL	XX	SUBSEQUENT REPORT OF WATER SHUT-OFF
NOTICE OF INTENTION TO CHANGE PLANS		SUBSEQUENT REPORT OF SHOOTING OR ACIDIZING
NOTICE OF INTENTION TO TEST WATER SHUT-OFF		SUBSEQUENT REPORT OF ALTERING CASING
NOTICE OF INTENTION TO REDRILL OR REPAIR WELL		SUBSEQUENT REPORT OF REDRILLING OR REPAIRING
NOTICE OF INTENTION TO SHOOT OR ACIDIZE		SUBSEQUENT REPORT OF ABANDONMENT
NOTICE OF INTENTION TO PULL OR ALTER CASING		SUPPLEMENTARY WELL HISTORY
NOTICE OF INTENTION TO ABANDON WELL		

(INDICATE ABOVE BY CHECK MARK NATURE OF REPORT, NOTICE, OR OTHER DATA)

July 23, 1958

Well No. 7 is located 990 ft. from N line and 990 ft. from E line of sec. 36

Sec. 36
(4 Sec. and Sec. No.)

27N
(Twp.)

3N
(Range)

N.M.P.M.
(Meridian)

Blanco NV & Unadilla, CO
(Field)

Rio Arriba
(County or Subdivision)

New Mexico
(State or Territory)

The elevation of the derrick floor above sea level is 7274 ft. O.L.

DETAILS OF WORK

(State names of and expected depths to objective sands; show sizes, weights, and lengths of proposed casings; indicate mudding jobs, cementing points, and all other important proposed work)

We propose to drill the above well to a total depth of 6300' w/rotary tool. We propose to test the following zones at the following approximate depths:

SAND	EXPECTED TOP
Pictured Cliffs	3700'
Mesa Verde	5579'

We expect to test any other zones that appear productive of oil or gas.

CASING PROGRAM: We propose to set approx. 350' of 10-3/4" surface cas. w/approx. 300 lbs. cement. To set approx. 4100' of 7-5/8" intermediate cas. w/approx. 200 lbs. cement. To set approx. 2300' of 5-1/2" liner on bottom @ 6300' w/approx. 225 lbs. cement. We propose to perforate & sand water from the Pictured Cliffs and Mesa Verde zones for completion.

I understand that this plan of work must receive approval in writing by the Geological Survey before operations may be commenced.

Company Magnolia Petroleum Company

Address P. O. Box 2806

Alamogordo, New Mexico

By [Signature]

Title District Superintendent





Form 0-20
12/1/52

UNITED STATES DEPARTMENT OF JUSTICE

LABORATORY AND FORENSIC SCIENCE DIVISION

July 15, 1953

Section A

Operator: [illegible]
Unit No. 1
Date: [illegible]
Time: [illegible]
Place: [illegible]
Subject: [illegible]
Nature of Problem: [illegible]
Is the Operator the only person in the laboratory at the time of the defect?

Is the defect in the operation of the equipment?
Is the defect in the material used?
Is the defect in the method of operation?
Is the defect in the maintenance of the equipment?
Is the defect in the design of the equipment?

REMARKS:
[illegible]

[Large blacked-out area covering the bottom half of the page]



NEW MEXICO OIL CONSERVATION COMMISSION

Well Location and Acreage Dedication Plat

Section A.

Date July 23, 1958

Operator MAGNOLIA PETROLEUM COMPANY Lease JICARILLA "0"
Well No. 7 Unit Letter Section 36 Township 27N Range 3W NMPN
Located 990 Feet From East Line, 900 Feet From North Line
County Rio Arriba G. L. Elevation 7274 Dedicated Acreage 160 Acres
Name of Producing Formation Pictured Cliffs Pool Undesignated

1. Is the Operator the only owner in the dedicated acreage outlined on the plat below?
Yes X No .
2. If the answer to question one is "no," have the interests of all the owners been consolidated by communitization agreement or otherwise? Yes No . If answer is "yes," Type of Consolidation
3. If the answer to question two is "no," list all the owners and their respective interests below:

Owner

Land Description

RECEIVED

JUL 25 1958

U. S. GEOLOGICAL SURVEY
FARMINGTON, NEW MEXICO

Section B.

S 89° 59' W (Call) 79.92' 64

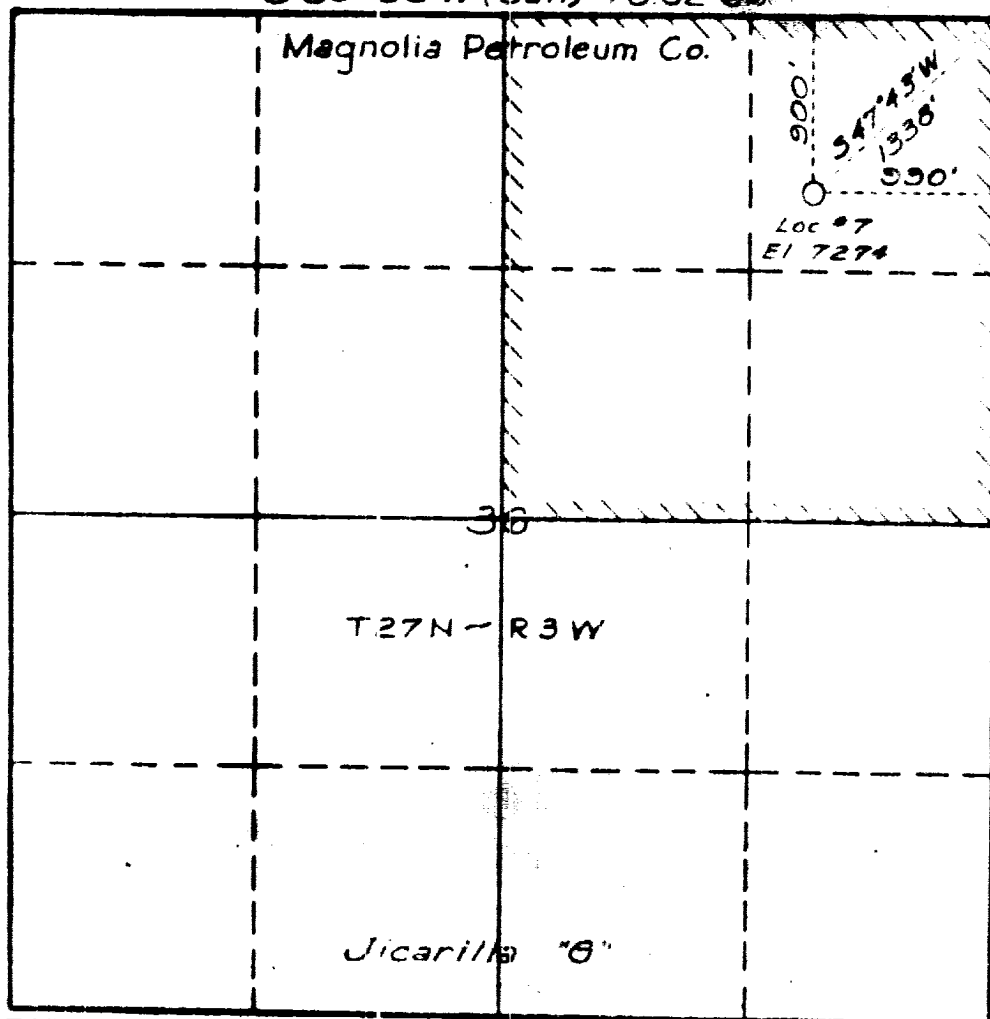

This is to certify that the information in Section A above is true and complete to the best of my knowledge and belief.

MAGNOLIA PETROLEUM COMPANY

(Operator)

(Representative)

Box 2406, Hobbs, New Mexico
Address

This is to certify that the well location shown on the plat in Section B was plotted from field notes of actual surveys made by me or under my supervision and that the same is true and correct to the best of my knowledge and belief.

Date Surveyed July 22, 1958

Carl E. Turner
Registered Professional
Engineer and/or Land Surveyor.

North (Call) 80 Ch.

