

(SUBMIT IN TRIPLICATE)

UNITED STATES
DEPARTMENT OF THE INTERIOR
GEOLOGICAL SURVEY

Land Office Santa Fe
Lease No. 079365
Unit Santa Fe 28-6 Unit
14-08-001-1051

SUNDRY NOTICES AND REPORTS ON WELLS

NOTICE OF INTENTION TO DRILL.....	<input checked="" type="checkbox"/>	SUBSEQUENT REPORT OF WATER SHUT-OFF.....
NOTICE OF INTENTION TO CHANGE PLANS.....		SUBSEQUENT REPORT OF SHOOTING OR ACIDIZING.....
NOTICE OF INTENTION TO TEST WATER SHUT-OFF.....		SUBSEQUENT REPORT OF ALTERING CASING.....
NOTICE OF INTENTION TO RE-DRILL OR REPAIR WELL.....		SUBSEQUENT REPORT OF RE-DRILLING OR REPAIR.....
NOTICE OF INTENTION TO SHOOT OR ACIDIZE.....		SUBSEQUENT REPORT OF ABANDONMENT.....
NOTICE OF INTENTION TO PULL OR ALTER CASING.....		SUPPLEMENTARY WELL HISTORY.....
NOTICE OF INTENTION TO ABANDON WELL.....		

(INDICATE ABOVE BY CHECK MARK NATURE OF REPORT, NOTICE, OR OTHER DATA)

March 19, 1958

Well No. 84 is located 1790 ft. from SW line and 800 ft. from E line of sec. 15.

SS Sec. 15
($\frac{1}{4}$ Sec. and Sec. No.)

27N 6W
(Twp.) (Range)

N.M.P.M.
(Meridian)

So. Blanco Ext.
(Field)

Rio Arriba
(County or Subdivision)

New Mexico
(State or Territory)

The elevation of the derrick floor above sea level is 6472 ft.

DETAILS OF WORK

(State names of and expected depths to objective sands; show sizes, weights, and lengths of proposed casings; indicate mudlogging jobs, cementing points, and all other important proposed work)

It is intended to drill a well thru the Pictured Cliff formation using rotary tools and to perforate and water fracture possible producing zones. Est. T.D. 3261'.

Casing Program:

8 5/8" at 120' with 125 sacks regular cement circulated to surface.
5 1/2" at 3261' with 75 sacks regular cement, 75 sacks Pozmix.

The SE/4 of section 15 is dedicated to this well.

SE/4: SP 079365

I understand that this plan of work must receive approval in writing by the Geological Survey before operations may be commenced.

Company El Paso Natural Gas Company

Address Box 971

Farmington, New Mexico

Original Signed D. C. Johnston
By _____

Title Petroleum Engineer

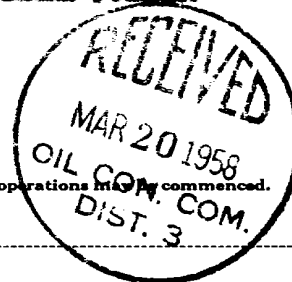



1

2

3

NEW MEXICO OIL CONSERVATION COMMISSION

Well Location and Acreage Dedication Plat

Section A.

Date **MARCH 14, 1958**

Operator **EL PASO NATURAL GAS COMPANY** Lease **SAN JUAN 28-6 UNIT** SF **079365**
 Well No. **84** Unit Letter **I** Section **15** Township **27-N** Range **6-W** NMPM
 Located **1750** Feet From **SOUTH** Line **800** Feet From **EAST** Line
 County **RIO ARRIBA** G. L. Elevation **6462** Dedicated Acreage **160** Acres
 Name of Producing Formation **PICTURED CLIFF** Pool **SOUTH BLANCO P.C. EXTENSION**

1. Is the Operator the only owner in the dedicated acreage outlined on the plat below?
 Yes ☒ No ☐
2. If the answer to question one is "no", have the interests of all the owners been consolidated by communitization agreement or otherwise? Yes ☐ No ☐ If answer is "yes", Type of Consolidation:
3. If the answer to question two is "no", list all the owners and their respective interests below.
- | Owner | Land Description |
|-------|------------------|
|-------|------------------|

Section B.

Note: All distances must be from outer boundaries of section.

This is to certify that the information in Section A above is true and complete to the best of my knowledge and belief.

El Paso Natural Gas Company

(Operator)

Original Signed D. C. Johnston

(Representative)

Box 997

(Address)

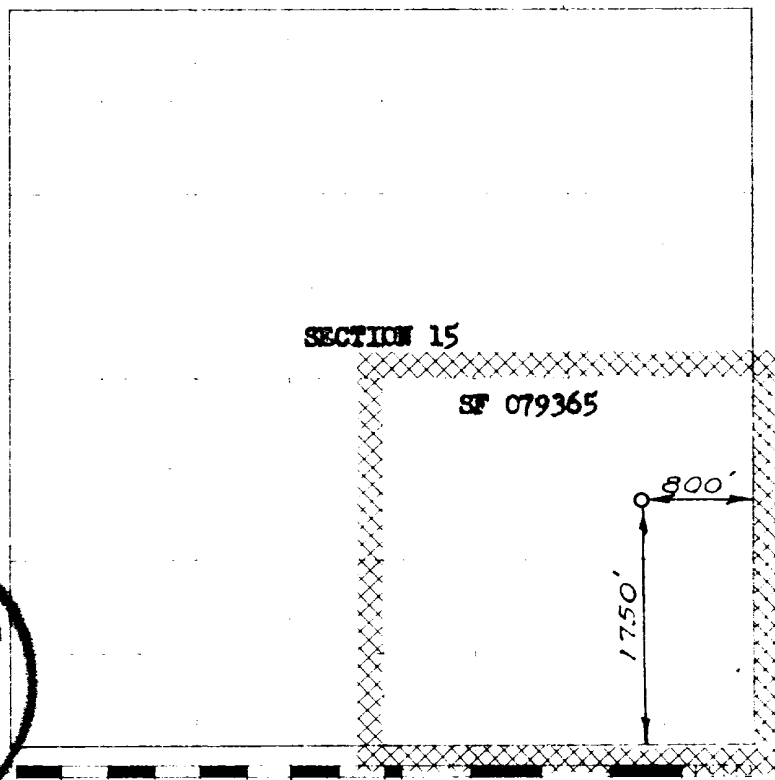
Farmington, New Mexico

Scale: 1 inch = 1 mile

This is to certify that the above plat was prepared from the field notes of actual surveys made by me or under my supervision and that the same are true and correct to the best of my knowledge and belief.

(Seal)

Date surveyed **FEBRUARY 24, 1958**

David C. Wilson
 Registered Professional Engineer and/or Land Surveyor

Farmington, New Mexico

