



IN REPLY REFER TO: ✓

UNITED STATES  
DEPARTMENT OF THE INTERIOR  
GEOLOGICAL SURVEY  
P. O. Box 965  
Farmington, New Mexico

June 18, 1956

El Paso Natural Gas Company  
Box 997  
Farmington, New Mexico

Re: New Mexico 012209

Gentlemen:

Receipt is acknowledged of your "Notice of Intention to Drill" dated June 15, 1956 covering your well No. 78 Rincon in NE $\frac{1}{4}$  sec. 14, T. 27 N., R. 7 W., N. M. P. M., Rio Arriba County, New Mexico, Blanco pool.

Your proposed work is hereby approved subject to compliance with the provisions of the "Oil and Gas Operating Regulations" revised May 25, 1942, a copy of which will be sent to you on request, and subject to the following conditions:

1. Drilling operations so authorized are subject to the attached sheet for general conditions of approval.
2. Furnish copies of all logs.

Very truly yours,

(Orig. Sgd.) P. T. McGrath

P. T. McGrath  
District Engineer

PTMcGrath:ac



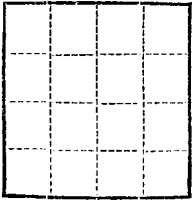

(SUBMIT IN TRIPLICATE)

UNITED STATES  
DEPARTMENT OF THE INTERIOR  
GEOLOGICAL SURVEY

Land Office New Mexico  
Lease No. 012209  
Unit Rincon

SUNDRY NOTICES AND REPORTS ON WELLS

NOTICE OF INTENTION TO DRILL.....	<input checked="" type="checkbox"/>	SUBSEQUENT REPORT OF WATER SHUT-OFF.....
NOTICE OF INTENTION TO CHANGE PLANS.....		SUBSEQUENT REPORT OF SHOOTING OR ACIDIZING.....
NOTICE OF INTENTION TO TEST WATER SHUT-OFF.....		SUBSEQUENT REPORT OF ALTERING CASING.....
NOTICE OF INTENTION TO RE-DRILL OR REPAIR WELL.....		SUBSEQUENT REPORT OF RE-DRILLING OR REPAIR.....
NOTICE OF INTENTION TO SHOOT OR ACIDIZE.....		SUBSEQUENT REPORT OF ABANDONMENT.....
NOTICE OF INTENTION TO PULL OR ALTER CASING.....		SUPPLEMENTARY WELL HISTORY.....
NOTICE OF INTENTION TO ABANDON WELL.....		

(INDICATE ABOVE BY CHECK MARK NATURE OF REPORT, NOTICE, OR OTHER DATA)

June 15, 1956

Well No. 73 is located 1460 ft. from [N] line and 1840 ft. from [E] line of sec. 14

NE Section 14  
(¼ Sec. and Sec. No.)

27N  
(Twp.)

7W  
(Range)

106W  
(Meridian)

Blanco  
(Field)

Rio Arriba  
(County or Subdivision)

New Mexico  
(State or Territory)

The elevation of the derrick floor above sea level is 6595 ft.

DETAILS OF WORK

(State names of and expected depths to objective sands; show sizes, weights, and lengths of proposed casings; indicate mudding jobs, cementing points, and all other important proposed work)

It is intended to drill a well with rotary tools thru the Mesa Verde formation. Mud circulation will be used thru the Pictured Cliffs and set intermediate casing. Gas circulation will be used thru the Mesa Verde and production casing will be set. Possible productive intervals will be perforated and fractured. Estimated Total Depth 5745'.

Casing Program:

10 3/4" at 170' with 125 sacks cement circulated to the surface.  
7 5/8" at 3280' with 250 sacks cement.  
5 1/2" at 5745' with 150 sacks cement.

The E/2 of Section 14 is dedicated to this well.  
E/2 IM 012209.

I understand that this plan of work must receive approval in writing by the Geological Survey before operations may be commenced.

Company El Paso Natural Gas Company

Address Box 997

Farmington, New Mexico

By S. Schulerman

Title Petroleum Engineer

NEW MEXICO  
OIL CONSERVATION COMMISSION

Form O-128

WELL LOCATION AND/OR GAS PRORATION PLAT

DATE JUNE 5, 1956

OPERATOR EL PASO NATURAL GAS COMPANY LEASE RINCON UNIT NM 012209

ACREAGE 78 SECTION 14 TOWNSHIP 27-N RANGE 7-N NEPM

LOCATION 1460 FEET FROM NORTH LINE 1840 FEET FROM EAST LINE

RIO ARRIBA COUNTY (NEW MEXICO) ELEVATION 6585

LAND SURVEY INFORMATION MESA VERDE BLANCO 320 ACRES  
(1882 PLAT)

Note: All distances must be from outer boundaries of section.

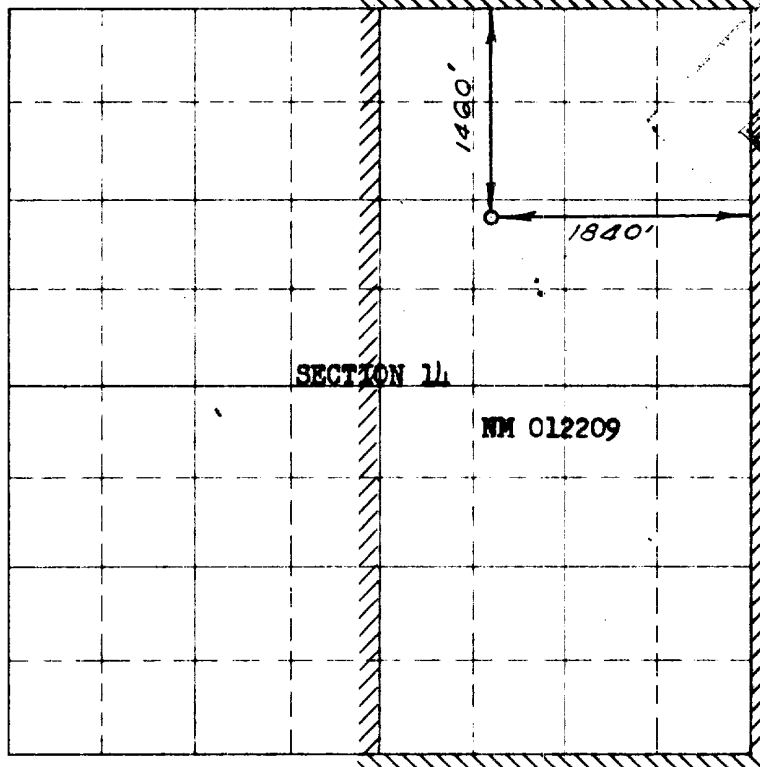

Scale 1 inch = equal 1 mile

NOTE

This section of  
form is to be used  
for gas wells only

This is to certify that the above plat was prepared from  
field notes of actual surveys made by me or under my  
supervision and that the same are true and correct to the  
best of my knowledge and belief.

Date Surveyed MAY 14, 1956

C. O. Walker  
Registered Professional Engineer and ~~EX~~ Land Surveyor

(Seal)

Farmington, New Mexico

1. Is this well a Dual Comp.

Yes \_\_\_\_\_ No X

2. If the answer to Question 1  
is yes, are there any other dually  
completed wells within the  
dedicated acreage.

Yes \_\_\_\_\_ No \_\_\_\_\_

Name S. Schuler

Position Petroleum Engineer

Representing El Paso Natural Gas Co.

Address San 107, Farmington, N.M.