

(SUBMIT IN TRIPLICATE)
UNITED STATES
DEPARTMENT OF THE INTERIOR
GEOLOGICAL SURVEY

Land Office Santa Fe
Lease No. 079392
Unit San Juan 27-5 Unit
14-08-001-950

SUNDRY NOTICES AND REPORTS ON WELLS

NOTICE OF INTENTION TO DRILL	<input checked="" type="checkbox"/>	SUBSEQUENT REPORT OF WATER SHUT-OFF	
NOTICE OF INTENTION TO CHANGE PLANS		SUBSEQUENT REPORT OF SHOOTING OR ACIDIZING	
NOTICE OF INTENTION TO TEST WATER SHUT-OFF		SUBSEQUENT REPORT OF ALTERING CASING	
NOTICE OF INTENTION TO RE-DRILL OR REPAIR WELL		SUBSEQUENT REPORT OF RE-DRILLING OR REPAIR	
NOTICE OF INTENTION TO SHOOT OR ACIDIZE		SUBSEQUENT REPORT OF ABANDONMENT	
NOTICE OF INTENTION TO PULL OR ALTER CASING		SUPPLEMENTARY WELL HISTORY	
NOTICE OF INTENTION TO ABANDON WELL			

(INDICATE ABOVE BY CHECK MARK NATURE OF REPORT, NOTICE, OR OTHER DATA)

July 11, 1961

Well No. 65 is located 890 ft. from N line and 1840 ft. from W line of sec. 17

NW/4 Sec. 17 (1/4 Sec. and Sec. No.) 27N (Twp.) 5W (Range) T.14N. R.14W. (Meridian)
Tapacito F. C. Ext. (Field) Rio Arriba (County or Subdivision) New Mexico (State or Territory)

The elevation of the derrick floor above sea level is 6594 ft.

DETAILS OF WORK

(State names of and expected depths to objective sands; show sizes, weights, and lengths of proposed casings; indicate mudding jobs, cementing points, and all other important proposed work)

It is intended to drill a well with rotary tools thru the Pictured Cliffs formation. Possible producing zones will be perforated and fractured. Est. T. D. 3458'.

Casing Program:

8 5/8" set at 100' with 140 sacks of cement circulated to surface.
2 7/8" set at 3458' w/150 sacks of cement - 150% to cover Ojo Alamo

The NW/4 of Section 17 is dedicated to this well.

I understand that this plan of work must receive approval in writing by the Geological Survey before operations may be commenced.

Company El Paso Natural Gas Company

Address Box 990

Farmington, New Mexico

By Original Signed D. W. Meehan

Title Petroleum Engineer

Well Location and Acreage Dedication Plat

Section A.

Date May 17, 1961

Operator EL PASO NATURAL GAS COMPANY Lease SAN JUAN 27-5 UNIT SF 079392
 Well No. 65 Unit Letter C Section 17 Township 27-N Range 5-W NMPM
 Located 890 Feet From NORTH Line, 1840 Feet From WEST Line
 County RIO ARriba G. L. Elevation 6584 Dedicated Acreage 155.35 Acres
 Name of Producing Formation PICTURED CLIFFS Pool TAPACITO P.C. EXT.

1. Is the Operator the only owner in the dedicated acreage outlined on the plat below?
 Yes No X
2. If the answer to question one is "no", have the interests of all the owners been consolidated by communitization agreement or otherwise? Yes X No If answer is "yes", Type of Consolidation, Unit Agreement

3. If the answer to question two is "no", list all the owners and their respective interests below:

Owner

Land Description

Section B.

This is to certify that the information in Section A above is true and complete to the best of my knowledge and belief.

El Paso Natural Gas Company

(Operator)

Original Signed R. G. MILLER

(Representative)

Box 990

(Address)

Farmington, New Mexico

**NOTE: THIS PLAT REISSUED
TO SHOW CORRECTED
DEDICATED ACREAGE**

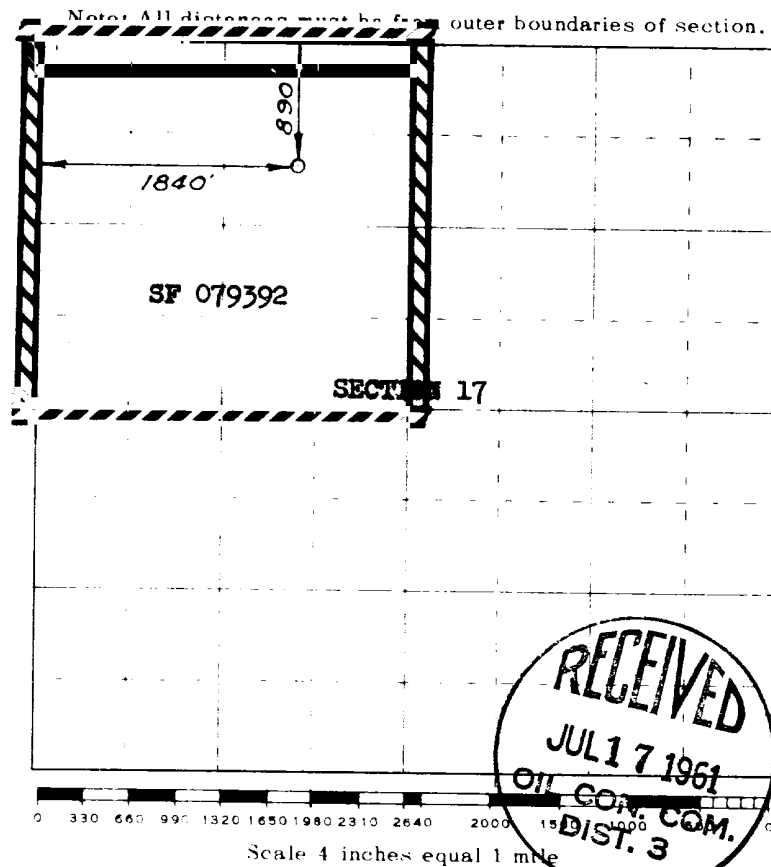

This is to certify that the above plat was prepared from field notes of actual surveys made by me or under my supervision and that the same are true and correct to the best of my knowledge and belief.

(Seal)

Farmington, New Mexico

Date Surveyed May 16, 1961

David A. Kilburn
Registered Professional Engineer and/or Land Surveyor