

NO. OF COPIES RECEIVED	6
DISTRIBUTION	
SANTA FE	1
FILE	1
U.S.G.S.	2
LAND OFFICE	1
OPERATOR	1

# NEW MEXICO OIL CONSERVATION COMMISSION

Form C-101

Revised 1-1-65

639  
30-037-20033

5A. Indicate Type of Lease	
STATE <input checked="" type="checkbox"/>	FEE <input type="checkbox"/>
5. State Oil & Gas Lease No.	
E-291-36	

## APPLICATION FOR PERMIT TO DRILL, DEEPEN, OR PLUG BACK

1a. Type of Work		7. Unit Agreement Name	
b. Type of Well		8. Farm or Lease Name	
DRILL <input checked="" type="checkbox"/> DEEPEN <input type="checkbox"/> PLUG BACK <input type="checkbox"/> OIL WELL <input type="checkbox"/> GAS WELL <input checked="" type="checkbox"/> OTHER <input type="checkbox"/> SINGLE ZONE <input checked="" type="checkbox"/> MULTIPLE ZONE <input type="checkbox"/>		Harvey	
2. Name of Operator		9. Well No.	
Merrion & Bayless		1	
3. Address of Operator		10. Field and Pool, or Wildcat	
Box 1541 Farmington, New Mexico		Undesignated Chacra	
4. Location of Well		12. County	
UNIT LETTER C LOCATED 790 FEET FROM THE North LINE AND 1870 FEET FROM THE West LINE OF SEC. 36 TWP. 26N RGE. 7W NMPM		Rio Arriba	
19. Proposed Depth		19A. Formation	
3925		Chacra	
20. Rotary or C.T.		21. Elevations (Show whether DF, RT, etc.)	
Rotary		6810 ground	
21A. Kind & Status Plug. Bond		21B. Drilling Contractor	
Statewide		Perry & Faast	
22. Approx. Date Work will start		May 28, 1967	

23.

### PROPOSED CASING AND CEMENT PROGRAM

SIZE OF HOLE	SIZE OF CASING	WEIGHT PER FOOT	SETTING DEPTH	SACKS OF CEMENT	EST. TOP
11"	8-5/8"	24#	100	100	circulate
7-7/8"	4-1/2"	9.5	3925	250	2800

Will drill 11" hole to 100' and set 100' of 8-5/8" csng w/ 100 sax

Will drill 7-7/8" hole to approximately 3925' to test Chacra and Pictured Cliff.

If productive will set 4-1/2 casing to TD, cement and complete.

APPROVAL VALID  
FOR 90 DAYS UNLESS  
DRILLING COMMENCED,

EXPIRES Aug 27, 1967



IN ABOVE SPACE DESCRIBE PROPOSED PROGRAM: IF PROPOSAL IS TO DEEPEN OR PLUG BACK, GIVE DATA ON PRESENT PRODUCTIVE ZONE AND PROPOSED NEW PRODUCTIVE ZONE. GIVE BLOWOUT PREVENTER PROGRAM, IF ANY.

I hereby certify that the information above is true and complete to the best of my knowledge and belief.

Signed B. J. Bayless Title \_\_\_\_\_ Date May 26, 1967

(This space for State Use)

APPROVED BY Emory Clavel TITLE Sup. Dist. III DATE 5-29-67

CONDITIONS OF APPROVAL, IF ANY:

**NEW MEXICO OIL CONSERVATION COMMISSION  
WELL LOCATION AND ACREAGE DEDICATION PLAT**

Form C-102  
Supersedes C-128  
Effective 1-1-65

All distances must be from the outer boundaries of the Section.

Operator <b>MERRION &amp; BAYLESS</b>		Lease <b>Harvey</b>		Well No. <b>1</b>
Unit Letter <b>C</b>	Section <b>36</b>	Township <b>26 North</b>	Range <b>7 West</b>	County <b>Rio Arriba</b>
Actual Footage Location of Well: <b>790</b> feet from the <b>North</b> line and <b>1870</b> feet from the <b>West</b> line				
Ground Level Elev. <b>6010</b>	Producing Formation <b>Chacra</b>	Pool <b>Undesignated</b>	Dedicated Acreage <b>160</b> Acres	

1. Outline the acreage dedicated to the subject well by colored pencil or hachure marks on the plat below.
2. If more than one lease is dedicated to the well, outline each and identify the ownership thereof (both as to working interest and royalty).
3. If more than one lease of different ownership is dedicated to the well, have the interests of all owners been consolidated by communitization, unitization, force-pooling, etc?

☐ Yes ☐ No If answer is "yes," type of consolidation \_\_\_\_\_

If answer is "no," list the owners and tract descriptions which have actually been consolidated. (Use reverse side of this form if necessary.) \_\_\_\_\_

No allowable will be assigned to the well until all interests have been consolidated (by communitization, unitization, forced-pooling, or otherwise) or until a non-standard unit, eliminating such interests, has been approved by the Commission.

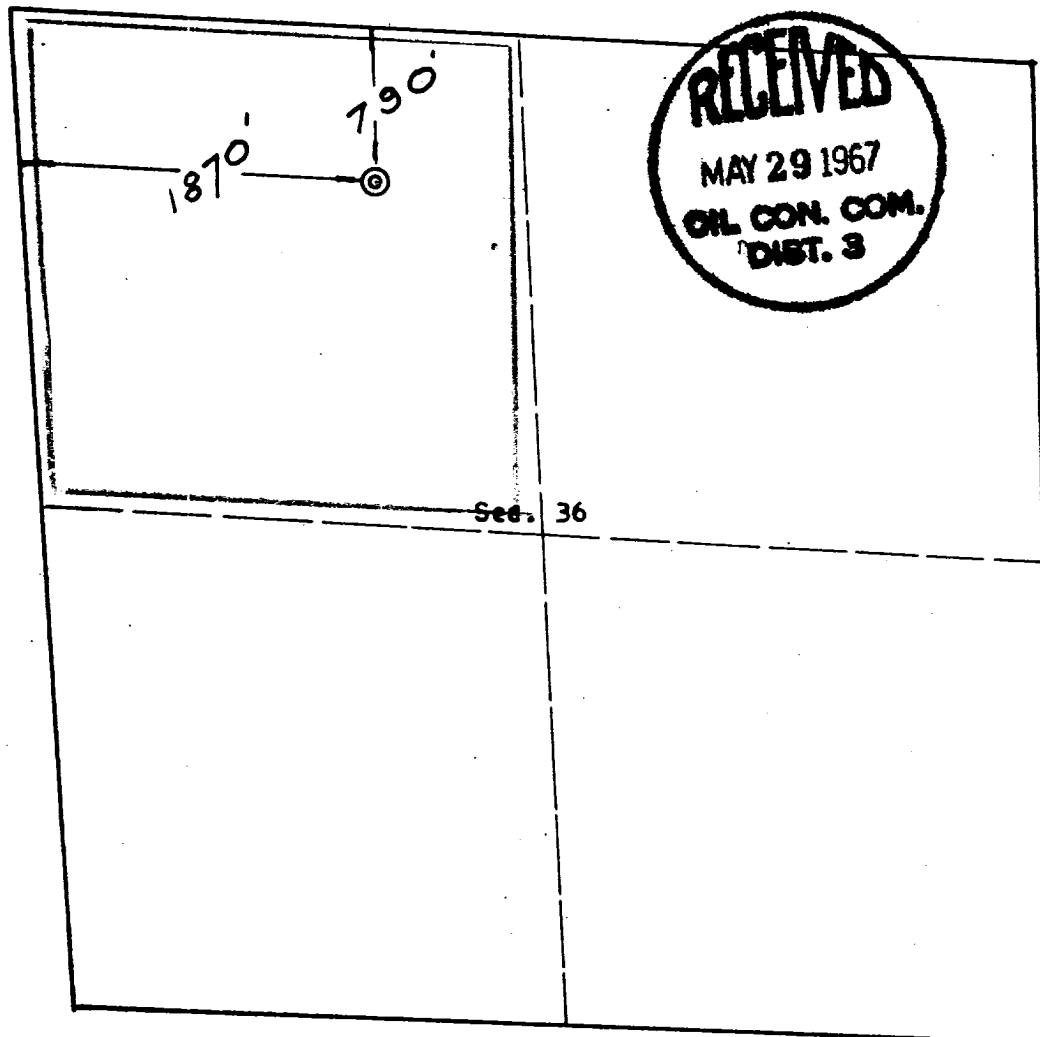

**CERTIFICATION**

I hereby certify that the information contained herein is true and complete to the best of my knowledge and belief.

Name *R. L. Bayless*  
Position \_\_\_\_\_

Company  
**Merrion & Bayless**

Date  
**May 26, 1967**

I hereby certify that the well location shown on this plat was plotted from field notes of actual surveys made by me or under my supervision, and that the same is true and correct to the best of my knowledge and belief.

Date Surveyed  
**May 21, 1967**  
Registered Professional Engineer  
and/or Land Surveyor

*E. J. Cochran*  
Certificate No. **3602**