

El Paso Natural Gas Company

El Paso, Texas 79978

July 9, 1973

ADDRESS REPLY TO
POST OFFICE BOX 980
FARMINGTON, NEW MEXICO 87401

Mr. Jerry Long
U. S. Geological Survey
Post Office Box 1809
Durango, Colorado 81301



Re: Application for Permit to Drill
Rincon Unit #142
SE/4 Section 27, T-27-N, R-6-W
Pictured Cliffs
Rio Arriba County, New Mexico

Dear Mr. Long:

Details regarding existing roads, pipelines, wells, etc. relative to the above well location are included on the previously submitted base maps, "Field Road Mpa" and "Composite Map #1".

The proposed new well location, new roads and new pipelines are shown on the attached plat along with connecting existing roads and pipelines in the vicinity of the proposed new well.

Water for drilling and completion operations will be obtained from a water well located in Section 3, T-26-N, R-6-W. Waste material will be disposed of by burial in the burn pit, latrine, or reserve pit as applicable. There will be no camp nor air strip associated with drilling this well. Upon completion or abandonment of this well, the location will be cleaned and leveled and a dry-hole marker placed, if applicable.

Yours very truly,

A handwritten signature in cursive script, appearing to read "D. G. Brisco".

D. G. Brisco
Drilling Clerk

pb

RECEIVED

JUL 10 1973

U. S. GEOLOGICAL SURVEY
DURANGO, COLO.

UNITED STATES
DEPARTMENT OF THE INTERIOR
GEOLOGICAL SURVEY

APPLICATION FOR PERMIT TO DRILL, DEEPEN, OR PLUG BACK

1a. TYPE OF WORK

DRILL ☒DEEPEN ☐PLUG BACK ☐

b. TYPE OF WELL

OIL
WELL ☐GAS
WELL ☒

OTHER

SINGLE
ZONE ☒MULTIPLE
ZONE ☐

2. NAME OF OPERATOR

El Paso Natural Gas Company

3. ADDRESS OF OPERATOR

PO Box 990, Farmington, NM 87401

4. LOCATION OF WELL (Report location clearly and in accordance with any State requirements.)*

At surface

1650'S, 1040'E

At proposed prod. zone

14. DISTANCE IN MILES AND DIRECTION FROM NEAREST TOWN OR POST OFFICE*

15. DISTANCE FROM PROPOSED*

LOCATION TO NEAREST
PROPERTY OR LEASE LINE, FT.
(Also to nearest drlg. unit line, if any)18. DISTANCE FROM PROPOSED LOCATION*
TO NEAREST WELL, DRILLING, COMPLETED,
OR APPLIED FOR, ON THIS LEASE, FT.

21. ELEVATION (Show whether DF, RT, GR, etc.)

6600' GL.

23.

PROPOSED CASING AND CEMENTING PROGRAM

SIZE OF HOLE	SIZE OF CASING	WEIGHT PER FOOT	SETTING DEPTH	QUANTITY OF CEMENT
12 1/4"	8 5/8"	24.0#	120'	106 cu. ft. to circ. to surface
6 3/4"	2 7/8"	6.4#	3325'	275 cu. ft. to cover Ojo Alamo

Selectively perforate and sandwater fracture the Pictured Cliffs formation.

The SE/4 of Section 27 is dedicated to this well.



IN ABOVE SPACE DESCRIBE PROPOSED PROGRAM: If proposal is to deepen or plug back, give data on present productive zone and proposed new productive zone. If proposal is to drill or deepen directionally, give pertinent data on subsurface locations and measured and true vertical depths. Give blowout preventer program, if any.

24.

SIGNED

M. D. Lucas

TITLE

Drilling Clerk

DATE

7-9-73

(This space for Federal or State office use)

PERMIT NO.

APPROVAL DATE

APPROVED BY

Ed

TITLE

CONDITIONS OF APPROVAL, IF ANY:

RECEIVED

JUL 10 1973

*See Instructions On Reverse Side

U. S. GEOLOGICAL SURVEY
DURANGO, COLO.

NEW MEXICO OIL CONSERVATION COMMISSION
WELL LOCATION AND ACREAGE DEDICATION PLAT

Form 1-101
Supersedes G-128
Effective 1-1-68

All distances must be from the outer boundaries of the Section

EL PASO NATURAL GAS COMPANY		RINCON UNIT		(SF-079366)	142
Section	27	Town	27-N	Range	6-W
County	RIO ARriba				
Acres	1650	Section	SOUTH	1040	EAST
Section	6600	Section	PICTURED CLIFFS	SOUTH BLANCO PICTURED CLIFFS	160.00

1. Outline the acreage dedicated to the subject well by colored pencil or hatchure marks on the plat below.
2. If more than one lease is dedicated to the well, outline each and identify the ownership thereof (both as producing interest and royalty).
3. If more than one lease of different ownership is dedicated to the well, have the interests of all owners been consolidated by communitization, unitization, force-pooling, etc?

☒ Yes ☐ No If answer is "yes," type of consolidation Unitization

If answer is "no," list the owners and tract descriptions which have actually been consolidated. (Use reverse side of this form if necessary.)

No allowable will be assigned to the well until all interests have been consolidated (by communitization, unitization, forced-pooling, or otherwise) or until a non-standard unit, eliminating such interests, has been approved by the Commission.

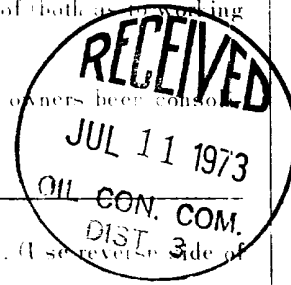

CERTIFICATION

I hereby certify that the information contained herein is true and complete to the best of my knowledge and belief.

Original Signed by
D. G. Brisco

Drilling Clerk

El Paso Natural Gas Co.

July 9, 1973

I hereby certify that the well location shown on this plat was plotted from field notes of actual surveys made by me or under my supervision, and that the same is true and correct to the best of my knowledge and belief.

NOVEMBER 5, 1958

David W. When
1760

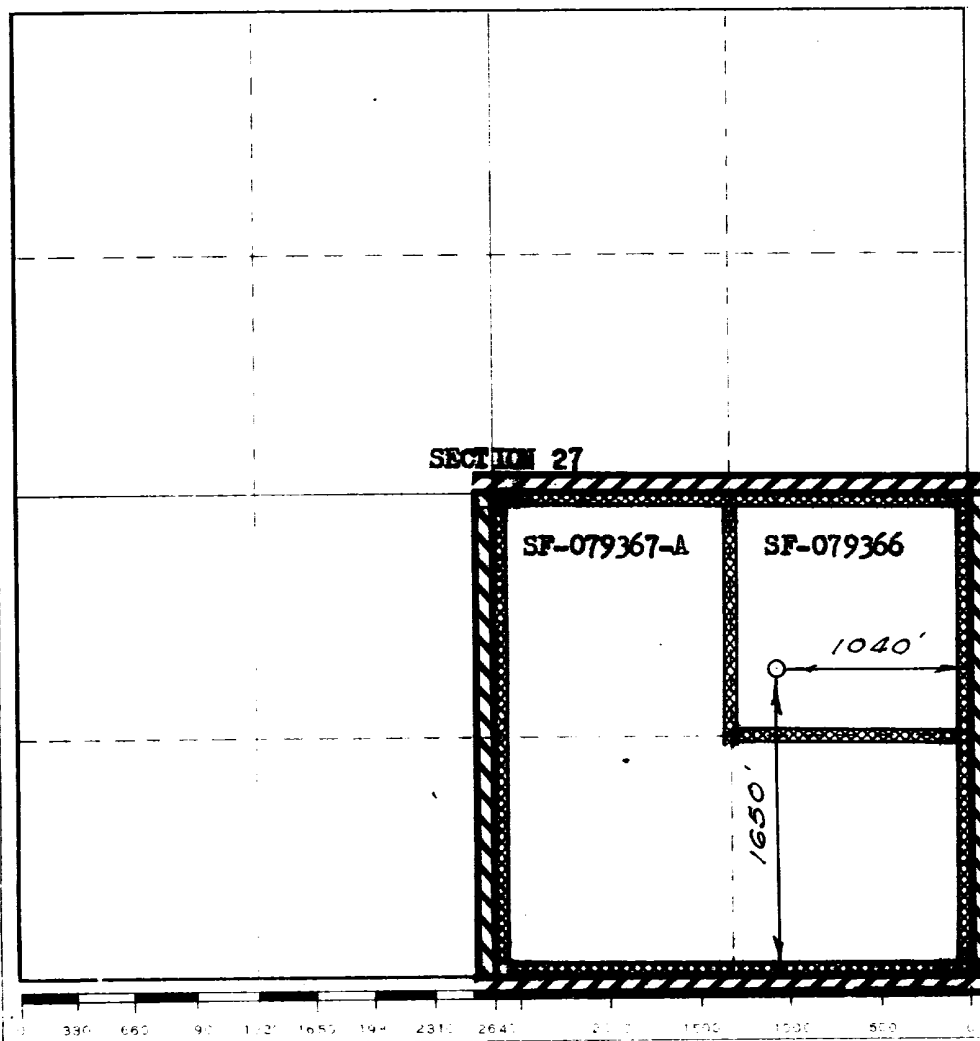

LOCATION AND EQUIPMENT LAYOUT

Rincon Unit No. 142

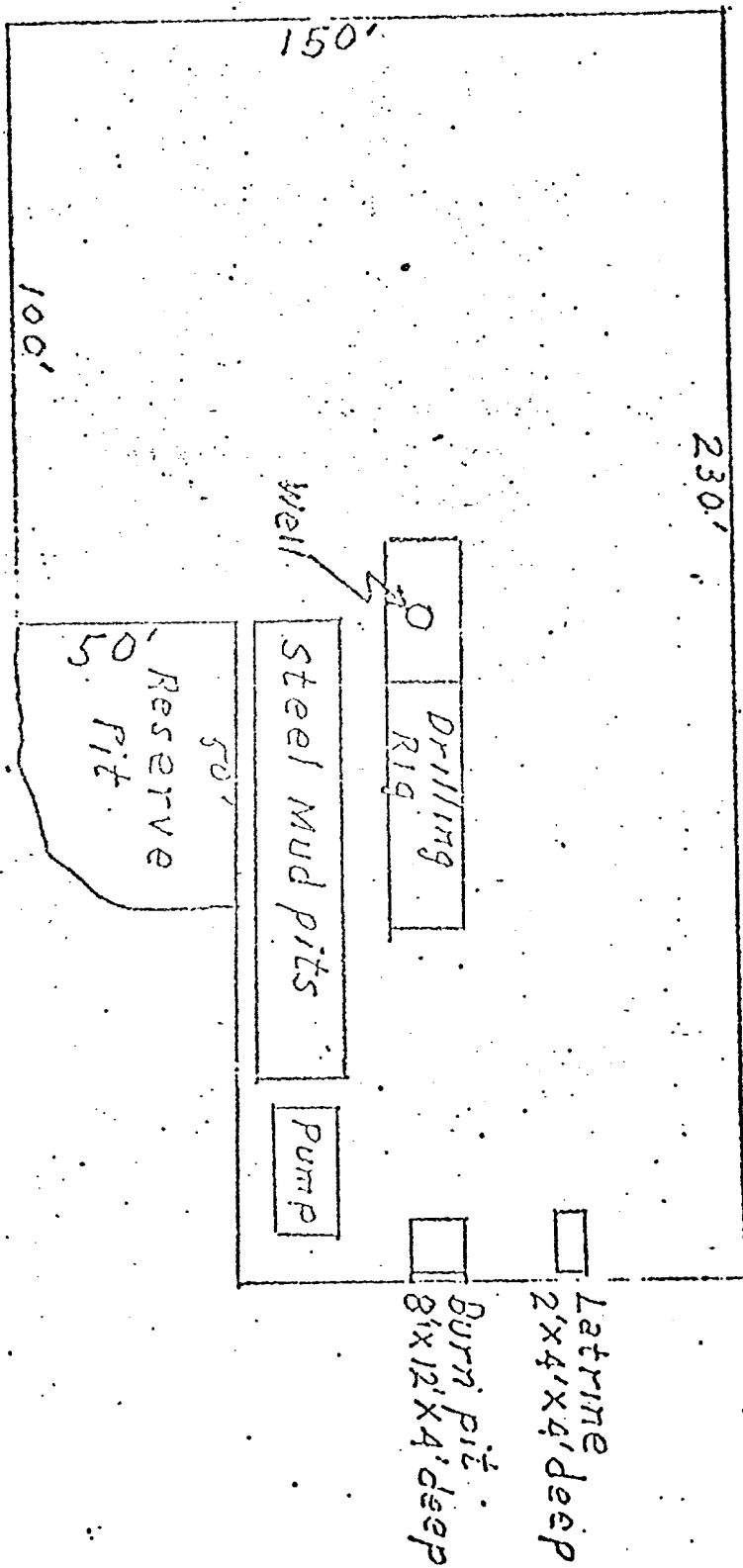

Rincon Unit No. 142

SE/4 Sec. 27, T-27N, R-6W

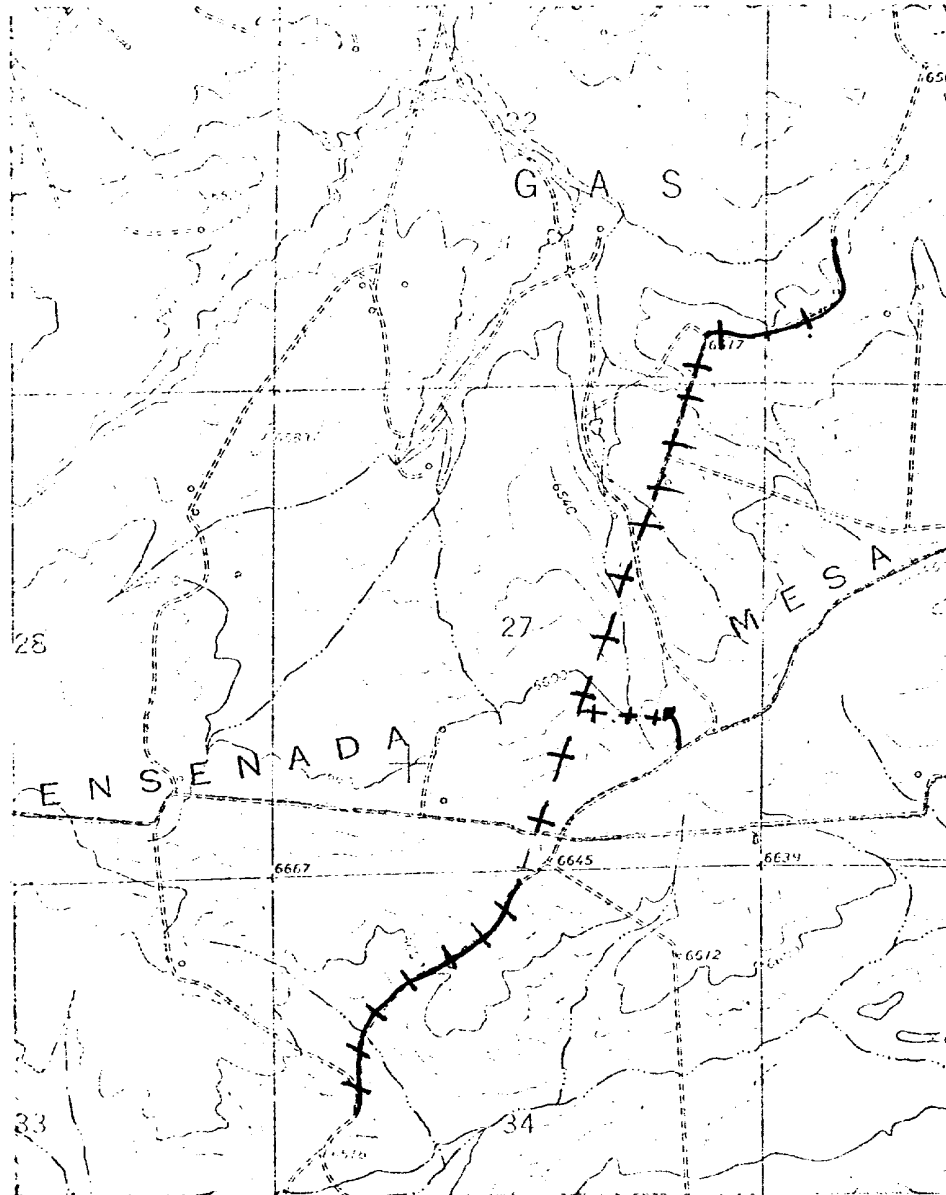

T
27
N

R-6-W

LEGEND OF RIGHT-OF-WAYS

- EXISTING ROADS _____
- EXISTING PIPELINES + + + +
- EXISTING ROAD & PIPELINE + + + + +
- PROPOSED ROADS _____
- PROPOSED PIPELINES + + + + +
- PROPOSED ROAD & PIPELINE + + + + +