

UNITED STATES
DEPARTMENT OF THE INTERIOR
GEOLOGICAL SURVEY

APPLICATION FOR PERMIT TO DRILL, DEEPEN, OR PLUG BACK

1a. TYPE OF WORK

DRILL ☐DEEPEN ☐PLUG BACK ☒

b. TYPE OF WELL

OIL
WELL ☐GAS
WELL ☐

OTHER

SINGLE
ZONE ☒MULTIPLE
ZONE ☐

2. NAME OF OPERATOR

El Paso Natural Gas Company

3. ADDRESS OF OPERATOR

Box 289 Farmington, New Mexico 87401

4. LOCATION OF WELL (Report location clearly and in accordance with any State requirements.*)

At surface

1180/S + 1840/W

At proposed prod. zone

14. DISTANCE IN MILES AND DIRECTION FROM NEAREST TOWN OR POST OFFICE

15. DISTANCE FROM PROPOSED*

LOCATION TO NEAREST
PROPERTY OR LEASE LINE, FT.
(Also to nearest drlg. unit line, if any)

18. DISTANCE FROM PROPOSED LOCATION*

TO NEAREST WELL, DRILLING COMPLETED,
OR APPLIED FOR, ON THIS LEASE, FT.

21. ELEVATIONS (Show whether DF, RT, GR, etc.)

6763' GL

23.

PROPOSED CASING AND CEMENTING PROGRAM

SIZE OF HOLE	SIZE OF CASING	WEIGHT PER FOOT	SETTING DEPTH	QUANTITY OF CEMENT

This well was originally completed in the Dakota formation, however the Dakota formation is non-productive and it is planned to plug back to the Mesa Verde in the following manner:

Move on location and pull 1 1/2" tubing.

Squeeze the existing Dakota perfs through the cement retainer set at 8008' with 75 sks. of cement and spot a 25 sack cement plug opposite remaining perfs.

Perforations are 7886', 7960', 7986', 8030', 8052', 8060', and 8068'.

Spot a 75 sack cement plug opposite the Gallup formation.

Repair cement bond across Mesa Verde formation if necessary.

Perforate and sandwater fracture the Mesa Verde formation.

Run 1 1/2" tubing and return well to production.

IN ABOVE SPACE DESCRIBE PROPOSED PROGRAM: If proposal is to deepen or plug back, give data on present productive zone and proposed productive zone. If proposal is to drill or deepen directionally, give pertinent data on subsurface locations and measured and true vertical depths. Give blowout preventer program, if any.

24.

SIGNED

A. G. Suico

TITLE

Drilling Clerk

DATE

July 28, 1980

(This space for Federal or State office use)

PERMIT NO.

APPROVAL DATE

APPROVED BY

TITLE

DATE

CONDITIONS OF APPROVAL, IF ANY:

ok 3m

*See Instructions On Reverse Side

NM OGD

5. LEASE DESIGNATION AND SERIAL NO.
SF 080668

6. IF INDIAN, ALLOTTEE OR TRIBE NAME

7. UNIT AGREEMENT NAME

San Juan 27-4 Unit

8. FARM OR LEASE NAME

San Juan 27-4 Unit

9. WELL NO.

98

10. FIELD AND POOL, OR WILDCAT

Blanco MV

11. SEC., T., R., M., OR BLK.
AND SURVEY OR AREASec. 10. T-27-N
R-10-W NMPM

12. COUNTY OR PARISH 13. STATE

Rio Arriba New Mexico

17. NO. OF ACRES ASSIGNED
TO THIS WELL

320

20. ROTARY OR CABLE TOOLS

22. APPROX. DATE WORK WILL START*



APPROVED

AUG 1 1980

James F. Sims
JAMES F. SIMS

DISTRICT OIL & GAS SUPERVISOR

**NEW MEXICO OIL CONSERVATION COMMISSION
WELL LOCATION AND ACREAGE DEDICATION PLAT**

Form C-102
Supersedes C-128
Effective 1-1-65

All distances must be from the outer boundaries of the Section.

Operator EL PASO NATURAL GAS COMPANY		Lease SAN JUAN 27-4 UNIT (SF-080668)		Well No. 98
Unit Letter N	Section 10	Township 27-N	Range 4-W	County RIO ARriba
Actual Footage Location of Well: 1180 feet from the SOUTH line and 1840 feet from the WEST line				
Ground Level Elev. 6763	Producing Formation MESA VERDE	Pool BLANCO MESA VERDE	Dedicated Acreage: 320.00 Acres	

1. Outline the acreage dedicated to the subject well by colored pencil or hachure marks on the plat below.
2. If more than one lease is dedicated to the well, outline each and identify the ownership thereof (both as to working interest and royalty).
3. If more than one lease of different ownership is dedicated to the well, have the interests of all owners been consolidated by communitization, unitization, force-pooling, etc?

☒ Yes ☐ No If answer is "yes," type of consolidation Unitization

If answer is "no," list the owners and tract descriptions which have actually been consolidated. (Use reverse side of this form if necessary.) _____

No allowable will be assigned to the well until all interests have been consolidated (by communitization, unitization, forced-pooling, or otherwise) or until a non-standard unit, eliminating such interests, has been approved by the Commission.

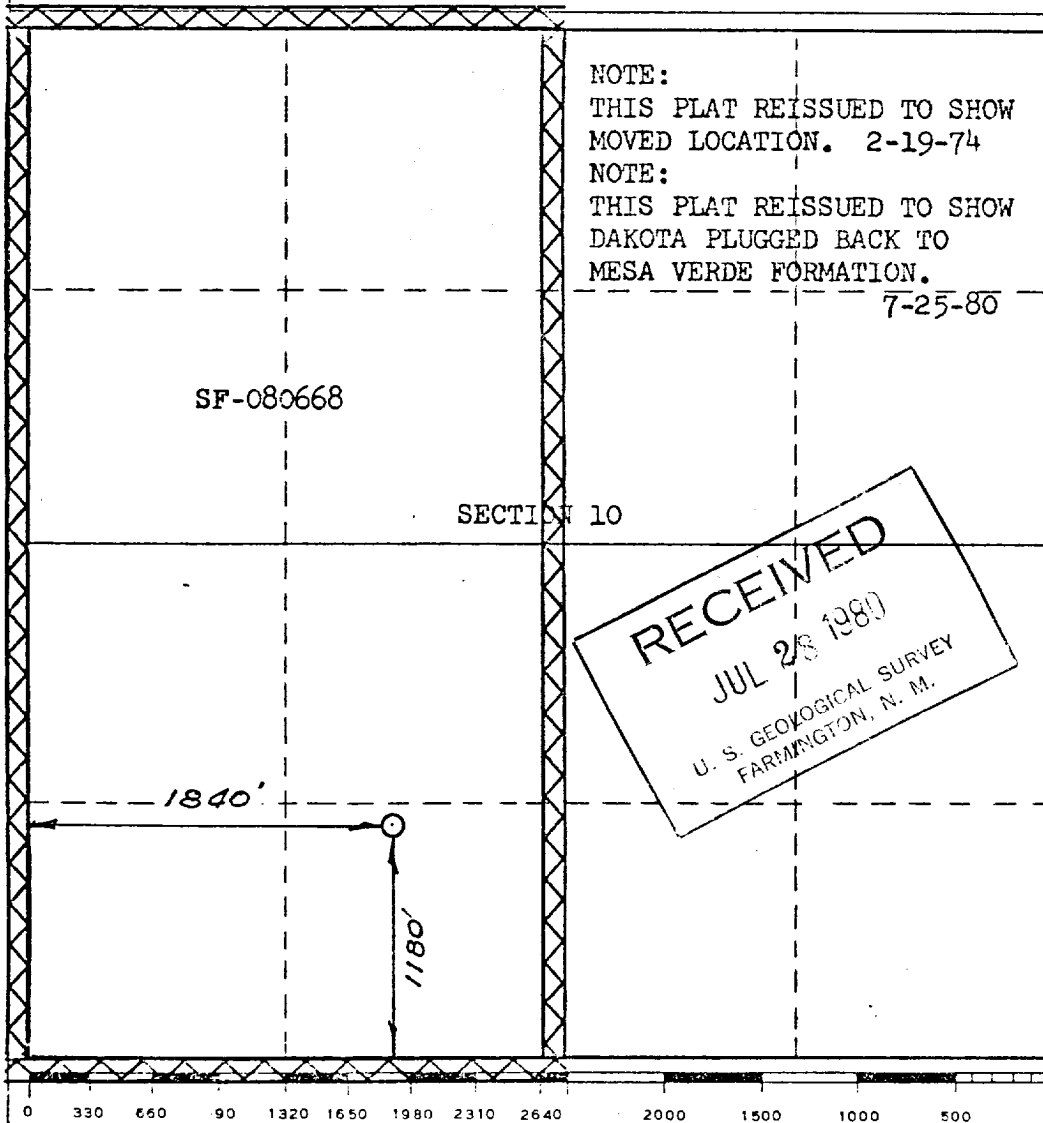

CERTIFICATION	
I hereby certify that the information contained herein is true and complete to the best of my knowledge and belief.	
Name	<u>D. G. Lisco</u>
Position	<u>Drilling Clerk</u>
Company	<u>El Paso Natural Gas Co.</u>
Date	<u>JUL 28, 1980</u>
I hereby certify that the well location shown on this plat was plotted from field notes of actual surveys made by me or under my supervision, and that the same is true and correct to the best of my knowledge and belief.	
Date Surveyed	<u>JULY 2, 1968</u>
Registered Professional Engineer and/or Land Surveyor	
Original signed by: DAVID O. VILVEN	
Certificate No.	<u>1760</u>